

Royal Navy
 Mine Countermeasures Vessel
H.M.S. HURWORTH
 1/350 Scale

History

The Hunt class Mine Counter Measures Vessels are the largest ships in the world to be made from GRP. The Royal Navy has a reputation for being the best in the world at mine detection and clearance, and even in these modern times, the necessity of MCMVs are essential. The Hunt class vessels have a secondary role as patrol craft and are frequently attached to the Fishery Protection Squadron when required. Most recently a group of these vessels have been detached to the Persian Gulf to assist in keeping the sea ways clear and open following the Iraq and Iran conflicts. The ships are kept in place there for long periods with just the complete crews changing over at intervals.

HMS Hurworth was built by Vosper Thornycroft (UK)Ltd, Woolston Yard, Southampton, England and was launched on 25th September 1984, by Lady Ann Halifax. She was officially commissioned into service on 2nd July 1985. Being the second ship to bear the name, HMS Hurworth became the tenth ship of the class, combining the traditional roles of Minesweeping and Mine Hunting into one vessel, using the latest state of the art detection equipment.

Shortly after her commissioning Hurworth found herself involved in the rescue operation following the Herald of Free Enterprise disaster at Zeebrugge in 1987. She also won a Battle Honour in the First Gulf War of 1991.

After an extensive refit in 2014, during which she received new engines and complete update of her detection equipment to present day standards, HMS Hurworth returned to the fleet at Portsmouth early in 2015 to carry out tasks around the UK before deploying to the Gulf later in the year.

HMS Hurworth has a ships company of 6 Officers, 39 Ratings and is part of the First Mine Countermeasures Squadron based at Portsmouth.
 Length: 60 metres Beam: 10 metres Displacement: 725 tons max Propulsion: 2 x Napier Deltic diesel engines at 3,540shp Max Speed 17 knots
 Armament: 1x 30mm DS30M Mk2 gun 2 x Miniguns 3x General Purpose machine guns.

Photo-Etched Metal Parts

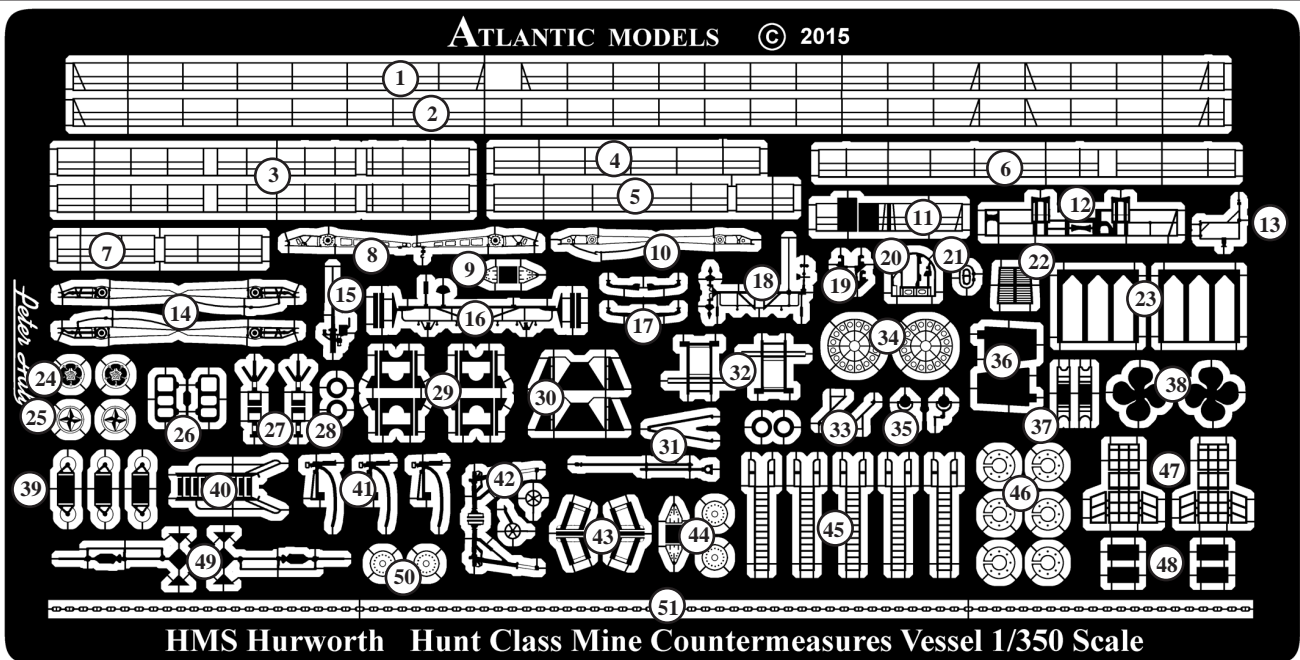

- | | | | |
|------------------------------------|---------------------------------|-------------------------------|------------------------------|
| 1. Railings (Focsle Starboard) | 14. Crane Jibs (Forward) | 27. Chaff Launchers | 40. Inclined Ladder |
| 2. Railings (Focsle Port) | 15. Mast Top Antenna | 28. Life rings | 41. Minigun Mountings |
| 3. Railings (Superstructure) | 16. Mast Lower Yardarms | 29. Sweep Bouy Racks (Alt) | 42. Fore Deck Crane |
| 4. Railings (Sweep Deck Roof Port) | 17. Mast Bottom Yards | 30. Gun Deck Shields | 43. Life Ring Ejector Racks |
| 5. Railings (Sweep Deck Roof Stbd) | 18. Mast Upper Yardarms | 31. Jack Staff | 44. No4 Winch |
| 6. Railings (Well Deck) | 19. Mast Head Lights | 32. Life Raft Cannister Racks | 45. Vertical Ladders |
| 7. Railings (Funnel Platforms) | 20. No 3 Winch Frame | 33. Mast Gaff | 46. No2 Winch Spools |
| 8. Crane Jib (Port Aft) | 21. Mast Access Hatch | 34. Main Sweep DrumWheels | 47. Boat Fuel Stowage Racks. |
| 9. No4 Winch Base | 22. Funnel Vent Grill | 35. Signal Lamps | 48. Stowage Rack Shelves |
| 10. Crane Jib (Stbd Aft) | 23. Gun Deck Supports | 36. Rudders | 49. Dan Bouys |
| 11. Railings (Sweep Deck Roof Aft) | 24. Squadron Funnel Badge | 37. Small Bouy Stowage Racks | 50. Winch Spools |
| 12. Railings (Stern Transom) | 25. "Stanaforlant" Funnel Badge | 38. Propellers | 51. Anchor Chain |
| 13. Bridge Roof Antenna | 26. Bridge Doors | 39. Cordage Reels | |

General Precautions

When assembling a Resin / Photoetched metal kit, certain precautions must first be taken.

1. Resin dust can be harmful if inhaled. It is recommended that you wear a suitable dust mask when drilling or sanding resin parts.
2. Cyano adhesives (super glues) are generally used to assemble this type of kit. Care must be taken when using this type of adhesive as it will bond in seconds. Follow the advice on the container.
3. Wash resin parts in a solution of warm soapy water before assembly. This will remove any residual mold release agents and ensure a good key for painting.
4. Soak photoetch parts in a suitable solvent, such as white spirit, to degrease the surfaces prior to painting.

Resin & White Metal Parts

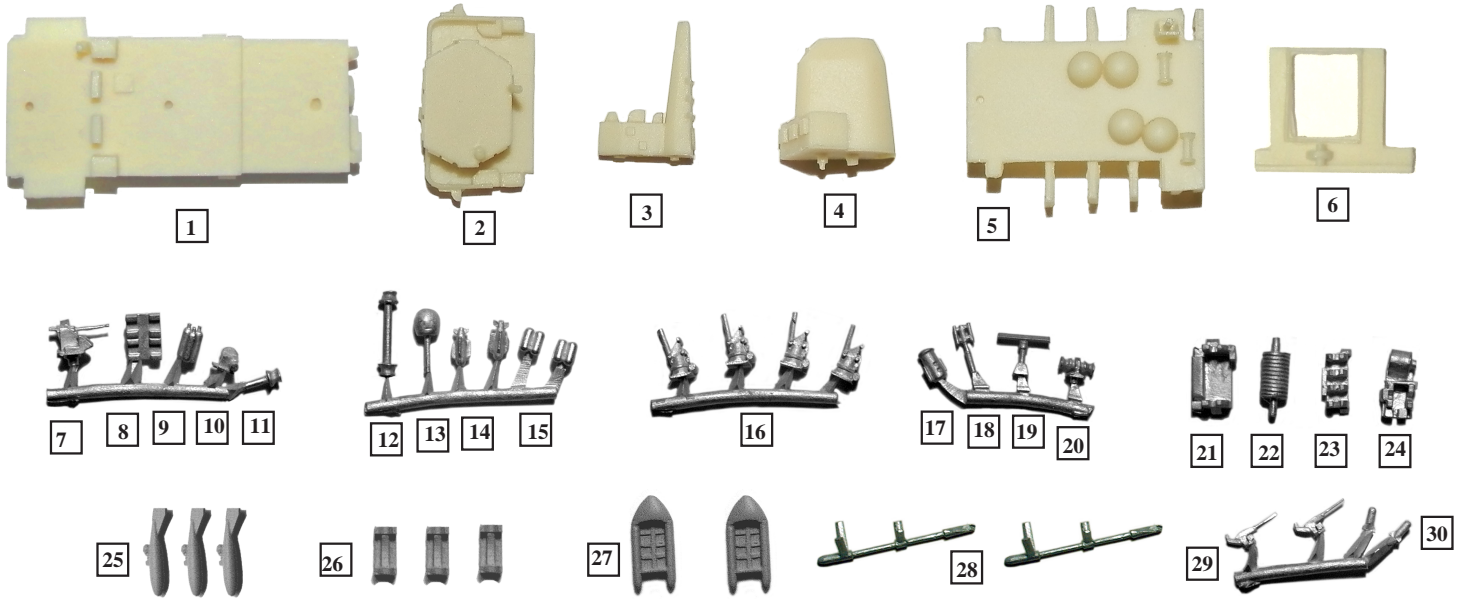

- | | | | |
|---|--|---|--|
| <p>1. Main Superstructure
2. Bridge
3. Mast & Deckhouse
4. Funnel
5. Boat Deck and Support Legs
6. Well Deck Plate
7. 30mm DS30M Gun Mounting</p> | <p>8. Submersible Stowage
9. Large Gas Cylinders
10. Small Sweep Bouy Winch
11. Stbd Aft Winch Hub & Spindle
12. Sweep Winch Cable Guide Roller
13. Satcom Radome
14. Robot PAP Submersibles
15. Life Raft Canisters</p> | <p>16. Crane Bases
17. Decompression Chamber
18. Mast Top Antenna
19. 1006 Nav Radar Antenna
20. Anchor Chain Windlass
21. Main Sweep Winch Base
22. Main Sweep Cable Drum
23. Sweep Winch Cable Guide Base</p> | <p>24. Stbd Aft Winch & Cable Drum
25. Mk 8 Oropesa
26. Oropesa Cradles
27. Gemini Inflatable Boats
28. Propeller Shafts
29. 20mm B-Marc Gun Mountings
30. Small Towed Sonar Bouys</p> |
|---|--|---|--|

Main Component Parts Locations

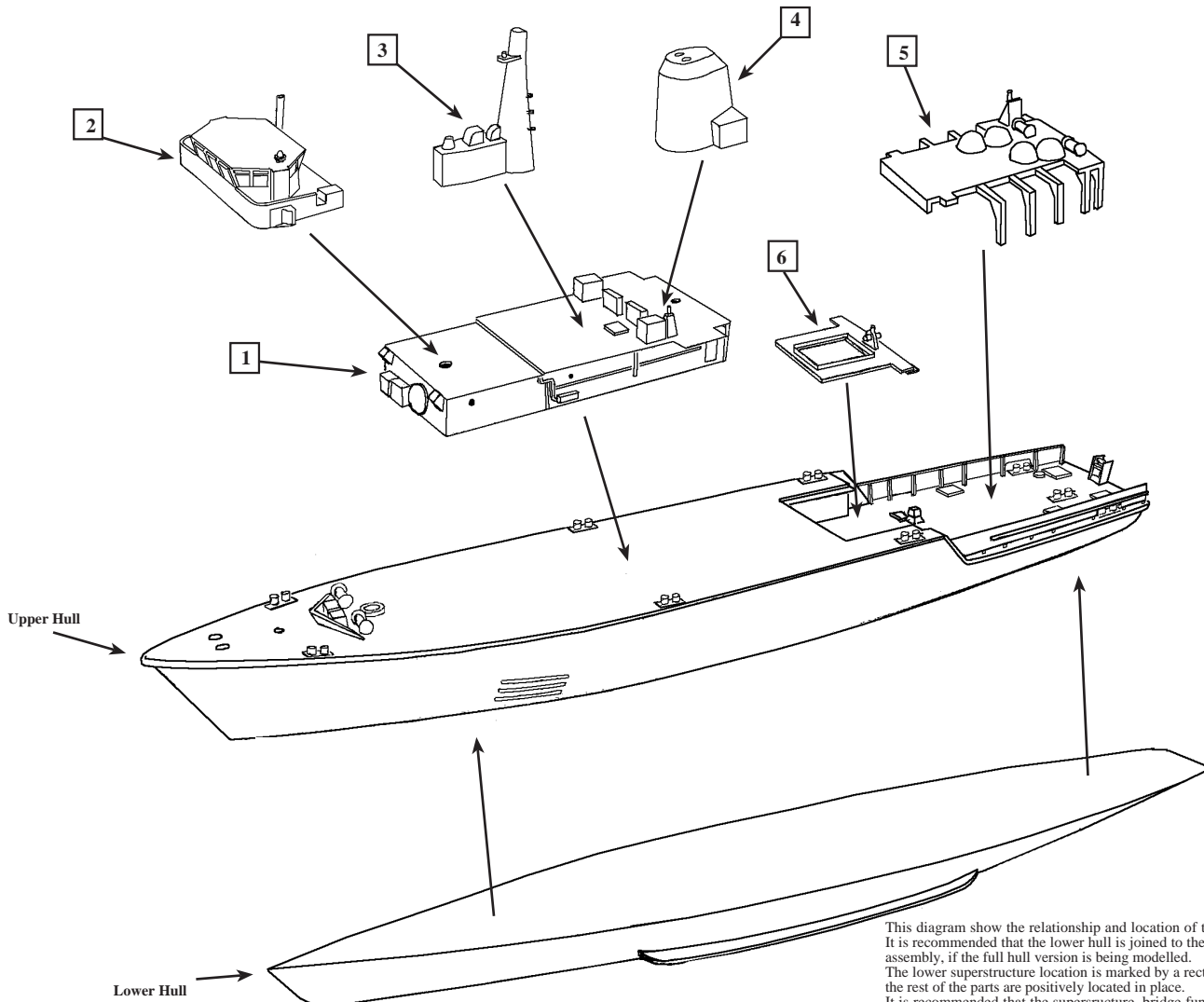

This diagram shows the relationship and location of the main resin components. It is recommended that the lower hull is joined to the main hull before any other assembly, if the full hull version is being modelled. The lower superstructure location is marked by a rectangular recess on the deck, the rest of the parts are positively located in place. It is recommended that the superstructure, bridge funnel and mast be assembled before any other smaller parts are added. This is so the assembly can be checked and any open seams filled and smoothed, then the paint finish can be applied.

Main Sweep Cable Reel

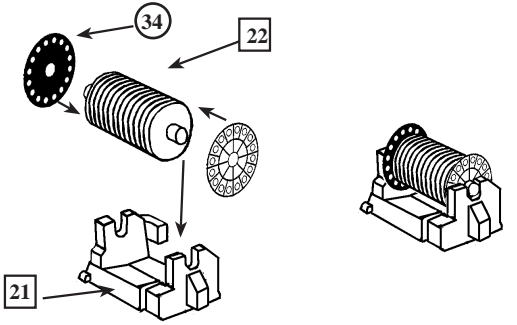

Assemble the Main Sweep Cable reel by first trimming the spigots on the ends of the drum so that they fit through the holes in the centre of photo etched parts 34.
Fit the completed drum into the carrier as shown.
The colour of the drum carrier is R.N Lightweatherwork Grey, whilst the drum sides are a steel grey metallic colour. The Cable is Black.

Sweep Cable Guide

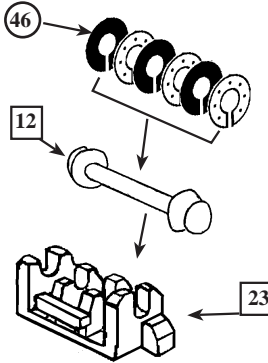

Fit the metal roller part 12 into the carrier 23, then fit etched parts 46 over the roller as shown by twisting each part to open the gap wide enough to fit over it.
There are three sections on the roller, between supports, and you will require two etched parts per section, detail outwards.

The colour of this assembly is R.N Light Weatherwork Grey for the carrier and a steel grey metallic for the roller assembly

PAP Submersibles

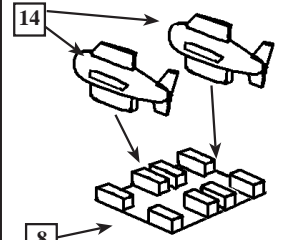

Assemble the submersibles into their stand as shown.

The colour of the of the submersibles is overall bright yellow. Sometimes the top fin is painted red or has a red flash on the side. Different ships had a different scheme and further research is advised.

MS14 & Winch Assembly & Sweep Gear Location

Fit the windlass and spindle into the side of MS 14 winch as shown.

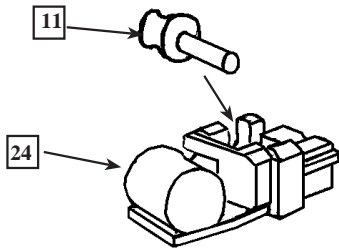

The colour of this winch is a dark brown grey, with metallic grey windlass. The MS 14 Drum itself is Orange.

Fit the sweep gear and submersibles to the aft deck as shown using the rectangular recesses as a location guide.
It might be a good idea at this stage to paint the deck and surrounding bulkheads as access will be difficult later.
The deck colour is R.N Deck Grey or Humbrol 106.
The bulkheads should be R.N Light Wetherwork Grey or Humbrol 127.

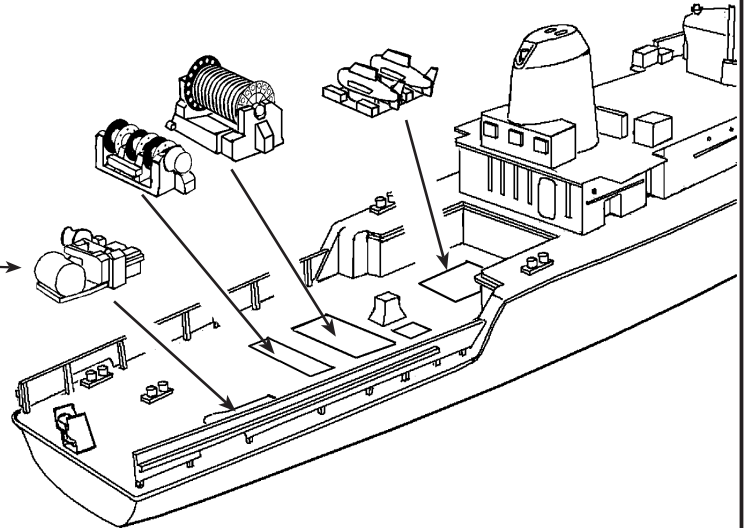

Fore Deck Crane Assembly

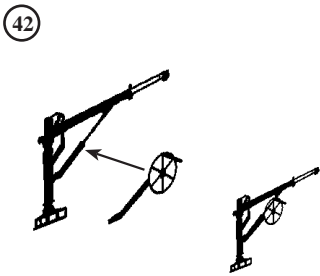

Assemble the foredeck crane as shown above.
A second hand wheel provided fits to the wall of the superstructure adjacent to the crane when fitted in place.
Colour of crane is Dark Grey.

Oropesa Assembly

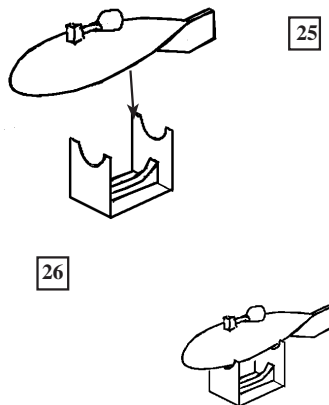

Fit the Oropesa Bouy into its cradle as shown, with the float on top.
The Oropesa body is a steel metallic grey with the float being Dayglow Orange.
The cradle is R.N Light Weatherwork Grey.

Sweep Deck Fittings Location

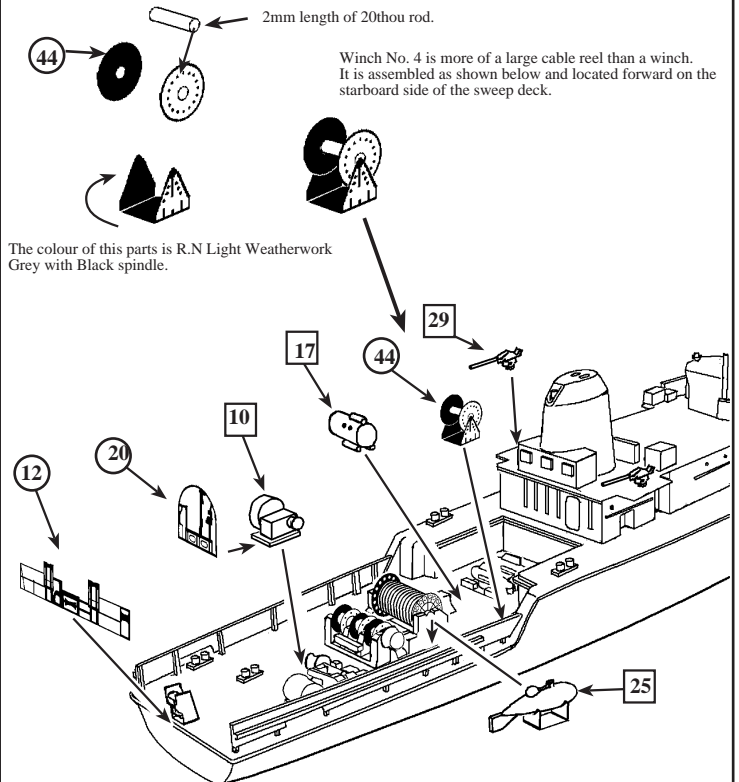

2mm length of 20thou rod.
Winch No. 4 is more of a large cable reel than a winch. It is assembled as shown below and located forward on the starboard side of the sweep deck.

The colour of this parts is R.N Light Weatherwork Grey with Black spindle.

Fit the 20mm B-Marcs, metal parts 29, to the sponsons either side of the funnel. These guns were fitted when the ships deployed into hostile areas to work. These parts are used on an early fit model.
Fit etched part 20 to the front of metal part 10 as shown and locate centrally aft of the main sweep cable guide.
Locate the decompression chamber, metal part 17, directly forward of the square post moulded on the deck.
Locate the Oropesa assembly to the starboard side of the main sweep gear.
The colour of the decompression chamber is White. The winch assembly 10 is R.N Light Weatherwork Grey

Main Crane Assembly

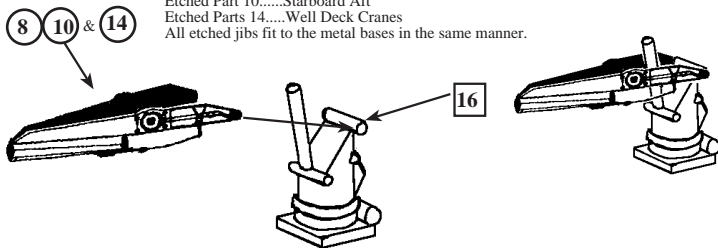

Assemble the main crane parts as shown above. Note:
The location of the cranes with certain etched parts is as follows:-
Etched Part 8.....Port Aft
Etched Part 10.....Starboard Aft
Etched Parts 14.....Well Deck Cranes
All etched jibs fit to the metal bases in the same manner.

Foredeck Area Component Location

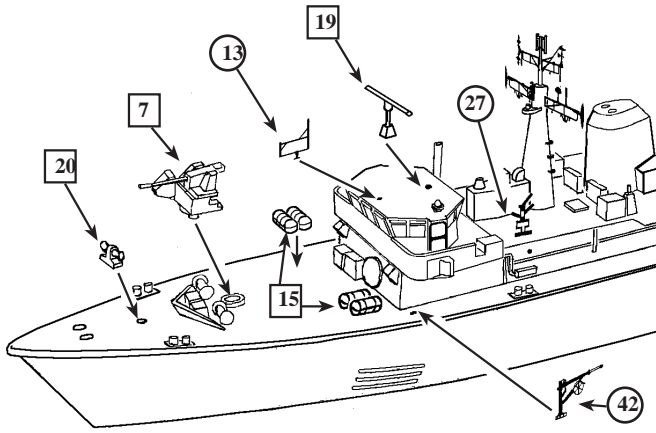

Assemble the white metal and photo etched parts to the locations shown on the fore decks. Stock lengths of anchor chain, etched part 51 can be used to run from the windlass, part 20 down to the hawse-pipe openings at the bow. Parts 15 may be fitted onto the fore deck as shown above if desired. This is an alternative location.

Boat Deck & Well Deck Assembly

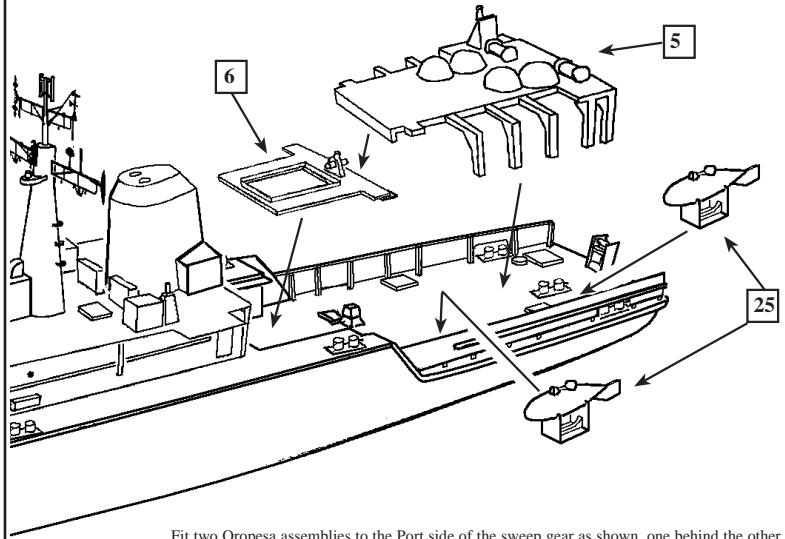

Fit two Oropesa assemblies to the Port side of the sweep gear as shown, one behind the other. Fit well deck into position and secure after ensuring that any paint finish inside the well deck has been completed. Fit the boat deck into position so that the forward step locates onto the rear of the well deck. The legs are then located inside the side bulwarks. Again ensure that any painting on the sweep deck has been completed before fixing this part into place.

Main Crane Location

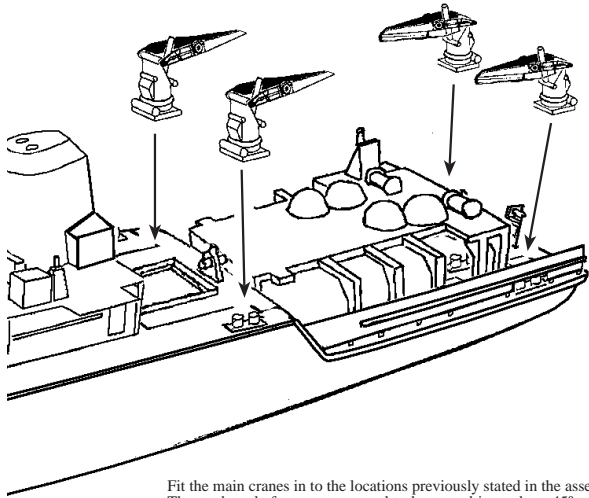

Fit the main cranes in to the locations previously stated in the assembly diagram. The starboard aft crane may need to be turned inwards to 45° to clear some of the deck fittings. The Dan Buoys, etched parts 49, are usually mounted across the tops of the legs of the boat deck. The colour of these is a wood pole with Dayglo Orange reflectors and float. The only known external inclined ladder is that running down into the well deck on the starboard side. This is supplied as etched part 40.

Boat Deck Fittings

The Gemini inflatable boats are usually a Slate Grey colour but are sometimes a Black Grey. The Gas cylinders, metal part 9, are Black. The radome of metal part 13 is White. The small buoys, metal parts 30 are Dayglo Orange. The dome shaped parts on the deck are also Dayglo Orange. All other parts will be R.N Light Weatherwork Grey.

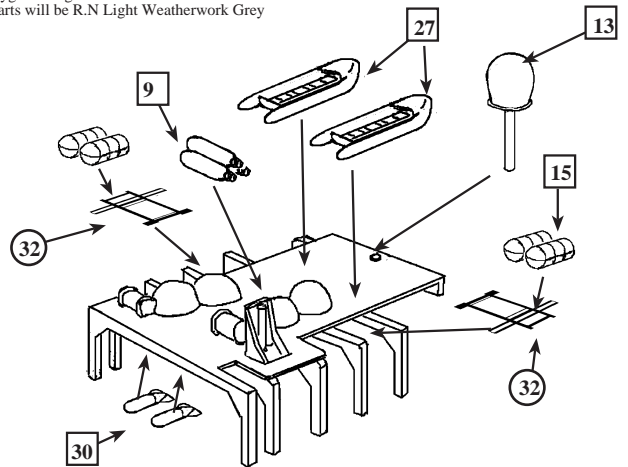

Boat Deck Railings and Minigun Location

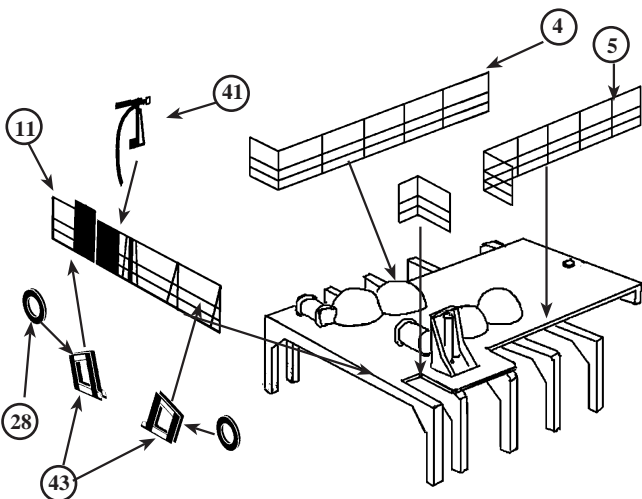

Shape and fit the railings, etched parts 4 and 5 to the edges of the boat deck as shown above. Fit the railing section, etched part 11 that has the Minigun Shield incorporated in it to the rear edge of the boat deck. Fold the Life Ring Ejectors, etched parts 43, in half, then do the same to the Life Rings so that the yare double thickness. Fit the Life Rings into the Ejectors, then fit to the outermost section of railing on etched part 11. Fit the Minigun to the boat deck inside the shield plate so that the spent cartridge chute passes over the outside of the shield.

Fit the upper and lower triangle parts of the radar reflector on the Dan Buoy, etched part 49 into place as shown.

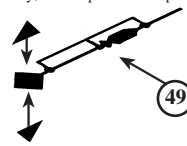

Fold the sides of the fuel can stowage, etched part 47, round to 90° so that they are parallel. Fit the shelves part 48 into place along the horizontal bars in the frame. Fold the top and front frames over in steps of 90° and secure into place.

Fit the complete assembly to the edge of the port rear boat deck extension.

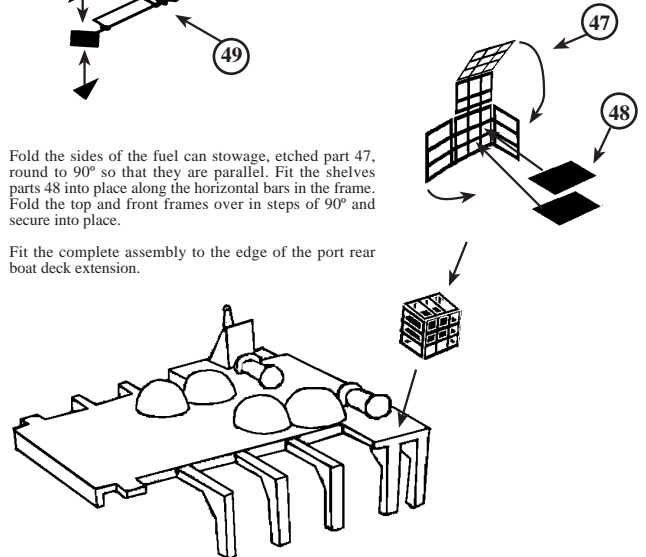

Main Deck Railings Location

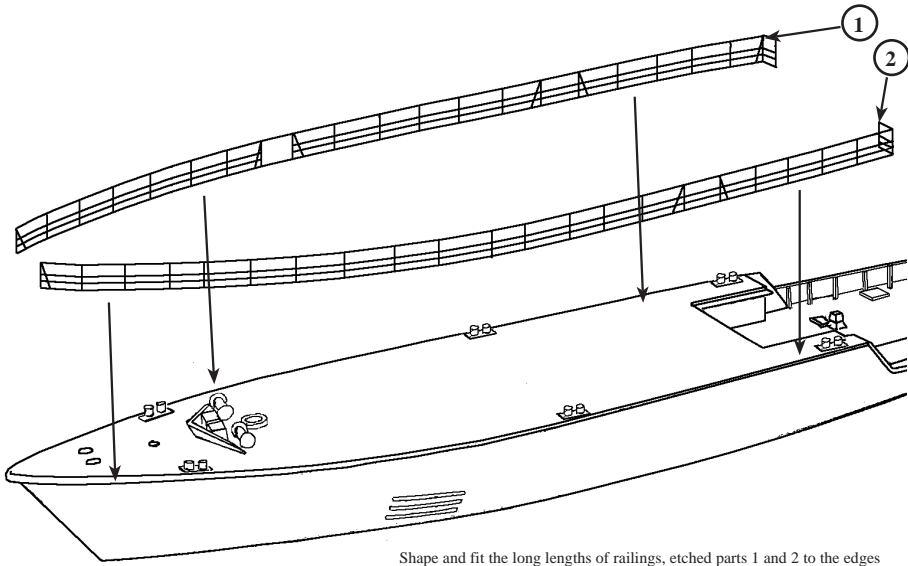

Shape and fit the long lengths of railings, etched parts 1 and 2 to the edges of the main deck as shown.
The opening towards the front end of one length of railing is located on the starboard side adjacent to where the life raft canisters are mounted. For a more recent fit of the ship, there would be countermeasures pod fitted at this location.

Mast Assembly

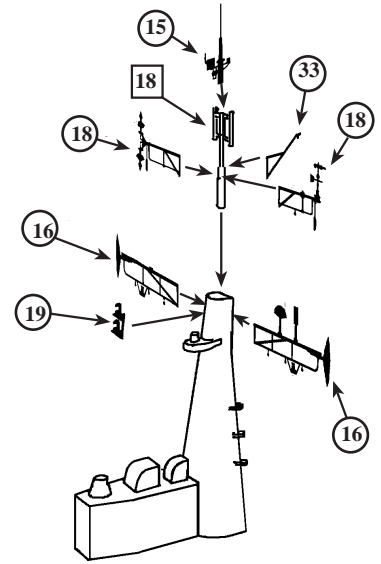

It may be better to fit the resin mast part in place on the superstructure before fitting the photo etched details.
A small access hatch, etched part 21 fits to the aft side of the mast, 2mm from the bottom. A vertical ladder runs up the rear of the mast from above the access hatch.

Late Fit Superstructure and Minigun Deck Railings Location

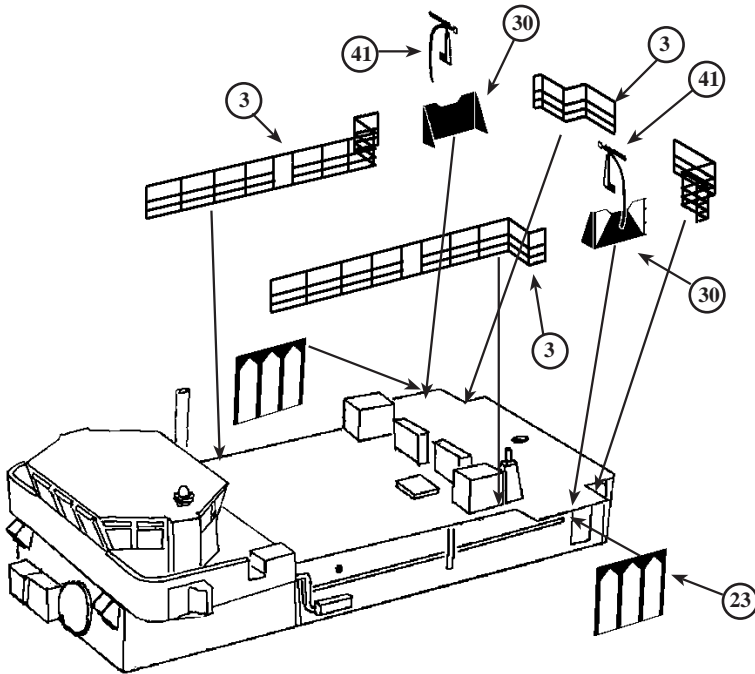

Shape the railing sections, etched parts 3, to fit the edges of the superstructure deck as shown above. The smaller sections fitting to the rear quarters and rear of late gun deck extensions.
Fold the angled sides of the gun shields rearward to 90° so that they are parallel then fit the gun shields to the edges of the deck extensions in the gaps left in the railings. Fit the Minigun Mountings, etched parts 41 inside the shield so that the spent cartridge chutes pass down the outside of the shields. Fit the gun deck supports, etched parts 23 so that the feet locate onto the main deck.

Funnel and Well Deck Railings

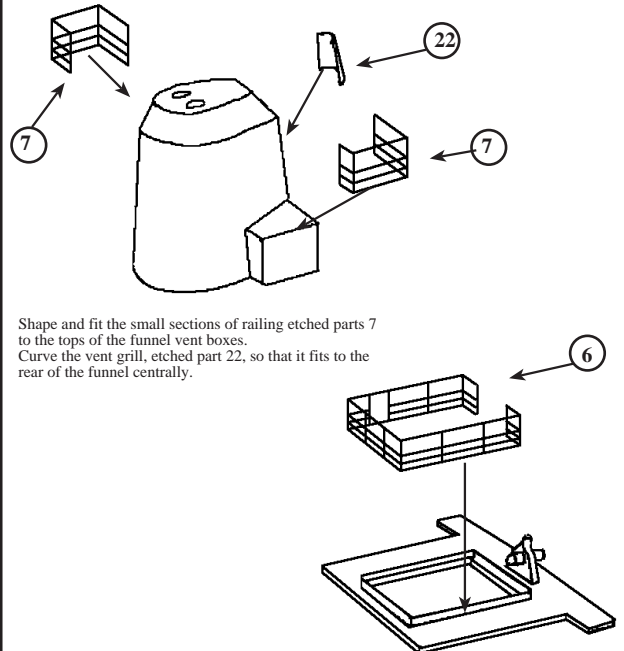

Shape and fit the small sections of railing etched parts 7 to the tops of the funnel vent boxes.
Curve the vent grill, etched part 22, so that it fits to the rear of the funnel centrally.

Shape and fit the railing section, etched part 6 around the sides of the submersible well as shown above. Ensure that the ladder access is positioned on the starboard side of the well.

Propeller Assembly

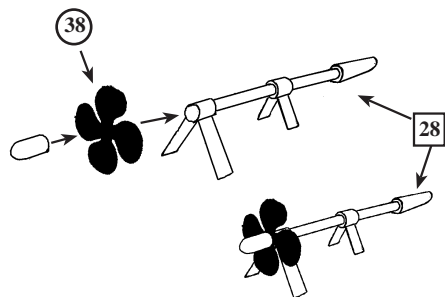

To fit the etched brass propellers in place, first cut through the metal shafts at the location shown above.
Fit the propellers to the shaft bearings as shown, then refit the hub boss to complete the assembly.
The blades may now be twisted to desired angles for extra realism.

Propeller Shaft and Rudder Location

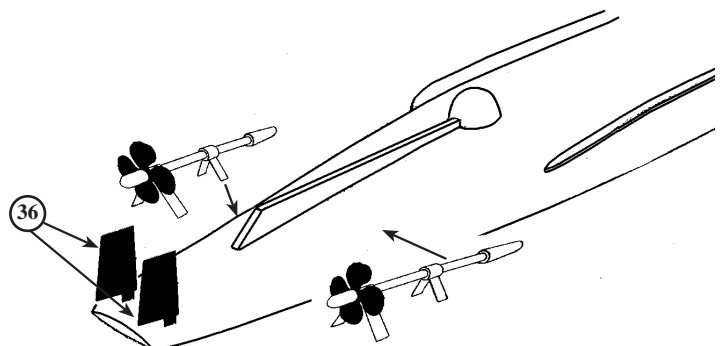

Fit completed running gear and rudders in to place and secure. Refer to colour guide for additional location information.

Painting Guide & Colour Chart

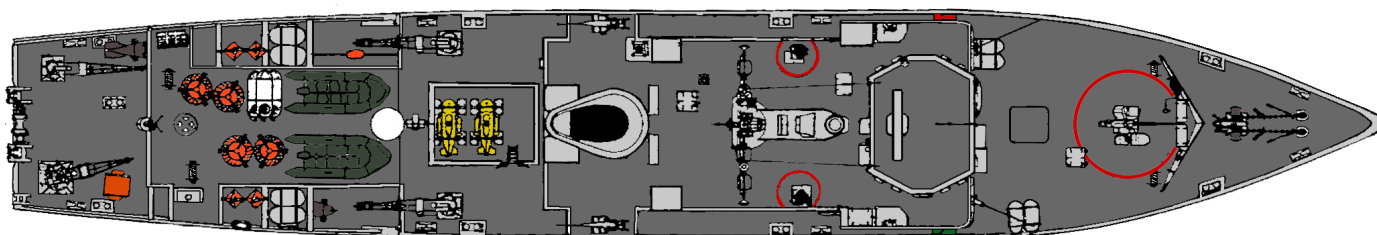
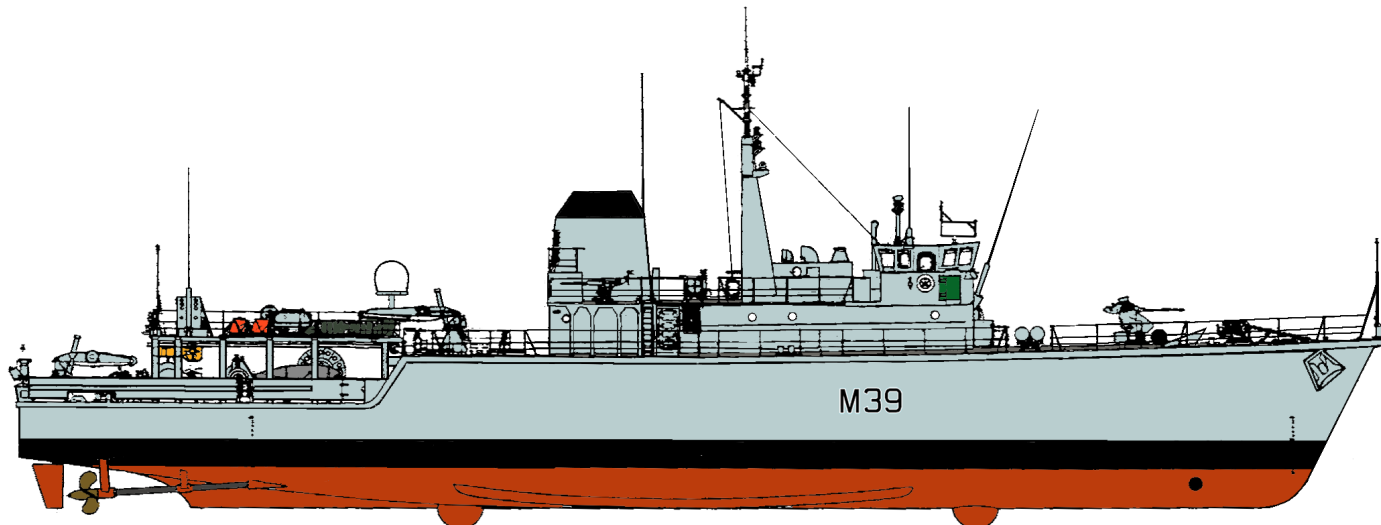

 R.N Light Weatherwork Grey or Humbrol 127

All vertical surfaces of hull and superstructure, funnel, mast, cranes, gun mountings, breakwater etc.

 Anti Fouling Red or Humbrol 100

Lower Hull below waterline

 R.N Deck Grey or Humbrol 106

All decks and walkways shown in above diagram

 Humbrol Slate Grey 31

Gemini Inflatable Boats

Other Colours Used are:-

Matt Black 33	Funnel Top, Gun Barrels, Anchor Cable, Waterline Boot Topping.
Yellow 69	Remote Submersibles
Fire Orange 209	Sweep Bouys, Dan Bouy Reflectors.
Orange 18	MS14 Magnetic Loop
Gunmetal 53	Mk 8 Oropesa

The decals supplied in this kit contain all the necessary pennant numbers to be able to portray any of the ships in this class. The photo etched parts also contain funnel badges for either the 1st MCMV Squadron or the Standing Naval Force Atlantic. The colours of these badges would have to be researched and painted accordingly. The names and numbers of the ships in the class are as follows.

M29 HMS Brecon	M35 HMS Dulverton
M30 HMS Ledbury	M36 HMS Bicester
M31 HMS Cattistock	M37 HMS Chiddingfold
M32 HMS Cottessmore	M38 HMS Atherstone
M33 HMS Brocklesby	M39 HMS Hurworth
M34 HMS Middleton	M40 HMS Berkeley
M41 HMS Quorn	

The numbers of the ships required for service was reduced in a recent government review and HMS Brecon was reduced to serve as the HMS Raleigh training ship. HM Ships Cottessmore and Dulverton were sold to the Lithuanian Naval Force and renamed Skalvis and Kursis respectively. HM Ships Bicester and Berkeley were sold the Hellenic Navy and renamed Europa and Kallisto. This left eight ships remaining on active service with the Royal Navy as of 2015.