

History

HMS Consort was a C-class destroyer of the Royal Navy, laid down by Alexander Stephen & Sons of Glasgow on 26th May 1943, launched on 19 October 1944 and commissioned on 19 March 1946.

The Flotilla in which *HMS Consort* was part, served mainly in the far east and China station during the post WW2 period, their appearance changed little from the original fit during this time, though the Ca class had started to receive extensive anti submarine upgrading with new design of superstructure and bridge.

Whilst berthed at Nanking in April 1949, *Consort* suffered 49 casualties after being attacked by the Chinese. She suffered further loss during the Yangtze Incident in an attempt to tow the sloop *HMS Amethyst* from a mud bank, taking 56 direct hits, and causing casualties of 23 wounded and a further 10 dead.

Consort had no alternative but to withdraw down river and dock for repairs. The same fate was to befall *HMS Black Swan* and *HMS London* during a further attempt to rescue the *Amethyst*, who eventually managed to escape under her own steam.

HMS Consort received an intermediate upgrade during the early 1950s, being fitted with a modified aft superstructure to take a pair of anti submarine squid mortars, and a Mk5 Twin Bofors mounting in place of the Hazemeyer. She was paid off in 1957 and placed in reserve. Following decommissioning she was sold to the Prince of Wales Drydock Co, Swansea, Wales, on 15 March 1961 for scrapping.

Specifications

Length: 362ft 9in oa. Beam: 35ft 8in Displacement: 1,808 tons standard 2,530 tons full load. Speed: 36 knots max

Armanent: 3 x 4.5 inch QF guns in single Mk5 mountings. 4 x 21inch Torpedo Tubes in one quadruple mounting.
 4 x 40mm Bofors Mk3 Powered mountings 1 x Twin 40mm Hazemeyer or later a Mk5 Mounting

This kit contains a mixture of resin and photo etched metal small parts, of which some of the resin parts have been attached to sprues for ease of casting. Care must be taken when detaching the parts from the sprues, to remove the flash without causing damage. When cleaning off the excess material using files or abrasive paper, it is recommended that a mask is worn as resin dust can be harmful to health if inhaled.

Resin and Metal Parts Identification

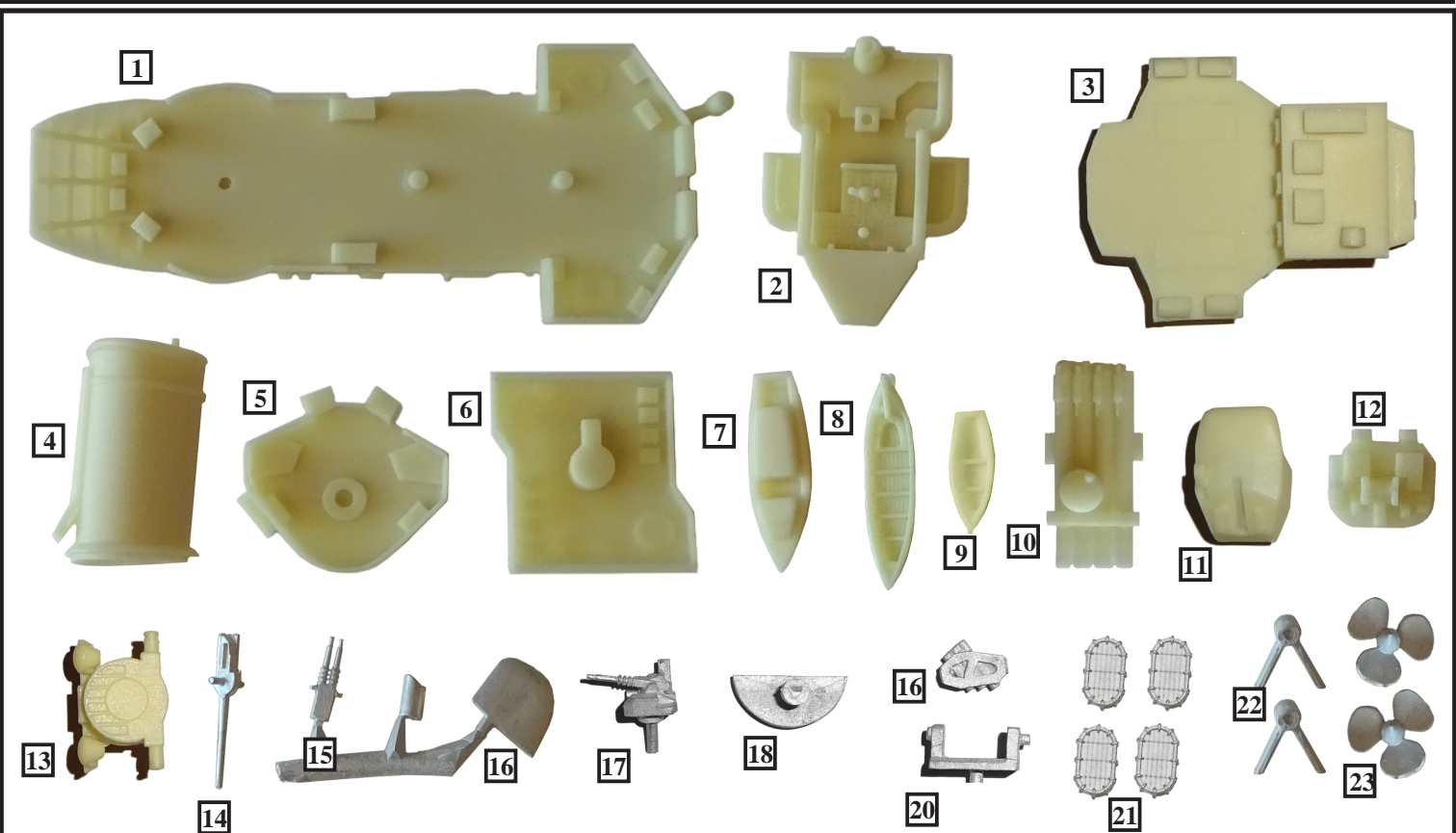

- | | | |
|---------------------------|--------------------------------|-----------------------------------|
| 1. Forward Suoerstructure | 9. 16' Dinghy | 17. Single 40mm Bofors x 4 |
| 2. Bridge | 10. 21" Torpedo Tubes | 18. 293 Radar Antenna |
| 3. Aft Superstructure | 11. 4.5" Mk 5 Gun Mounting x 3 | 19. Squid A/S Mortar Barrels x 2 |
| 4. Funnel | 12. 40mm Bofors Twin Mounting | 20. Squid A/S Mortar Mounting x 2 |
| 5. Hazemeyer Platform | 13. Mk6 Director Control Tower | 21. Carley Rafts |
| 6. 20mm AA Platform | 14. 4.7" Gun Barrel x 4 | 22. Propeller A Frames |
| 7. 25' Motor Cutter | 15. 40mm Twin Bofors Barrels | 23. Propellers (Pair) |
| 8. 27' Whaler | 16. Rudder | |

Photo Etched Parts Identification

ATLANTIC MODELS © 2017

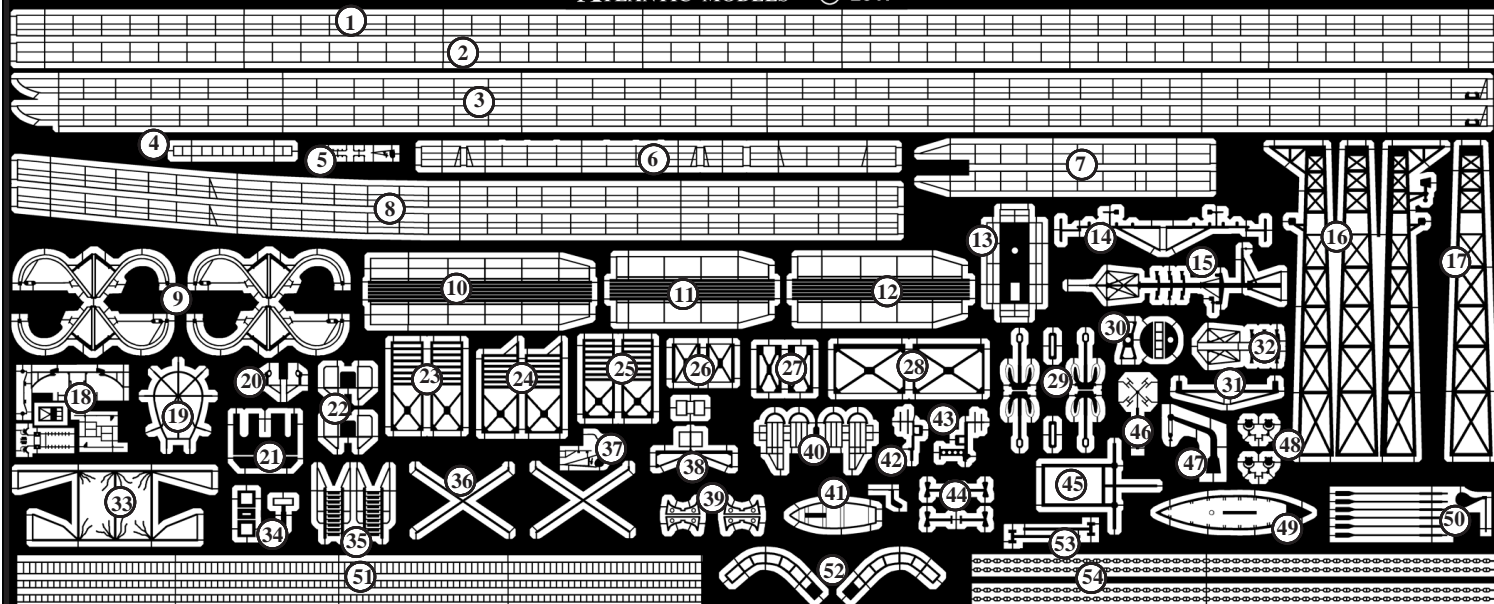

HMS Consort RN C Class Destroyer 1/350 Scale

- | | | |
|-----------------------------------|--------------------------------------|---------------------------------|
| 1. Railings (3 Bar Stock) | 19. Funnel Cap Grill | 37. Adm Motor Cutter Parts |
| 2. Railings (2 Bar Stock) | 20. Funnel Sirens | 38. Bridge Front DF Antenna |
| 3. Railings (Main Deck) | 21. Mk5 Bofors Shield | 39. Dinghy Cradles |
| 4. Bridge Windscreen | 22. Funnel Siren Platforms | 40. Flare Rocket Launcher Racks |
| 5. Motor Boat Fittings | 23. Carley Raft Racks (Forward) | 41. Dinghy Thwarts and Rudder |
| 6. Railings (Aft Superstructure) | 24. Carley Raft Racks (Mid Platform) | 42. Fore Mast Front IFF Antenna |
| 7. Railings (B Gun Deck) | 25. Carley Raft Racks (Aft) | 43. Fore Mast Rear IFF Antenna |
| 8. Railings (Focsle) | 26. Bridge Extension Supports | 44. IFF Transponders |
| 9. Boat Davits | 27. Fwd Gun Platform Supports | 45. Main Mast Antenna Spreader |
| 10. Funnel Catwalk | 28. Squid Deck Supports | 46. 291 Radar Antenna |
| 11. Forward AA Deck Catwalk | 29. Anchors | 47. Torpedo Loading Derrick |
| 12. Aft AA Deck Catwalk | 30. 278 Radar Antenna | 48. Signal Lamps |
| 13. Fore Mast Top Platform | 31. Main Mast Pole Yards | 49. 27' Whaler Thwarts |
| 14. Fore Mast Yardarms | 32. Mast Top Array Sides | 50. Whaler Oars and Rudder |
| 15. Fore Mast Top Array | 33. Bridge Canopy | 51. Vertical Ladder Stock |
| 16. Lattice Fore Mast | 34. 276 Radar Antenna | 52. Squid Mortar Rail Tracks |
| 17. Lattice Fore Mast Front Panel | 35. Hull Step Ladders | 53. Stove Pipes |
| 18. Hazemeyer Fittings | 36. Boat Restraint Straps | 54. Anchor Chain |

Other Instructions

1. Railings, etched parts 1, have been supplied as stock length so that they can be cut to length to fit any short falls in the tailored to fit railings supplied. Also some small lengths will be required at the aft end of the focsle deck and the lower superstructure decks. Etched parts 2 are stock 2 bar railings, with both wide and close stanchions. These can be cut and combine to fit lengths of upper deck platforms and deck edges as desired.
2. Etched part 51 is a stock length of vertical ladder. This can be cut in to lengths necessary to fit up mast poles as well as access platforms and sides of deck houses.
3. Etched parts 53, are stove pipes. These may be fitted if desired to the roof of the Forward Superstructure. (See colour guide profiles for the location)
4. Etched parts 35, are the two inclined ladders that run from the main deck, up to the focsle deck at the hull step. They are located within a rectangular opening in the focsle deck overhang, so that the top of each ladder is still located against the vertical wall of the focsle.
5. Anchor chain, etched part 54, is supplied in sufficient quantity to not only fit between the capstans and hawse pipes on the foc'sle, but also to provide extra should the model be portrayed at anchor with a chain running from the hawse pipe to the surface of a seascape.
6. Etched parts 36, are the retaining straps that are fitted across the outsides of the ships boats between the davits. These can be cut to length to fit as necessary.
7. Etched parts 41 and 49 are the fittings for the 16' Dinghy and the 27' Whaler. The thwarts and rudders are fitted in both boats in the same manner and the method is described in a later section. The oars can be cut and placed individually in the boats or rolled in to bundles for stowage on bulkheads.
8. References for this class of Destroyer are available in various books and on the internet. One example is the new publication by Norman Friedman called *British Destroyers and Frigates*. Other references can be found in *Destroyers of World War Two* by M.J. Whitley and if one can be obtained, the older out of print publication *British Destroyers* by Edgar March is a wealth of information.

ATLANTIC MODELS © 2018

1 Hillview Grove, Easington, Durham, SR8 3NT. UK Tel. 0191 5271574
e.mail: peter@atlanticmodels.net Website <http://www.atlanticmodels.net>

Main Parts Location Diagram

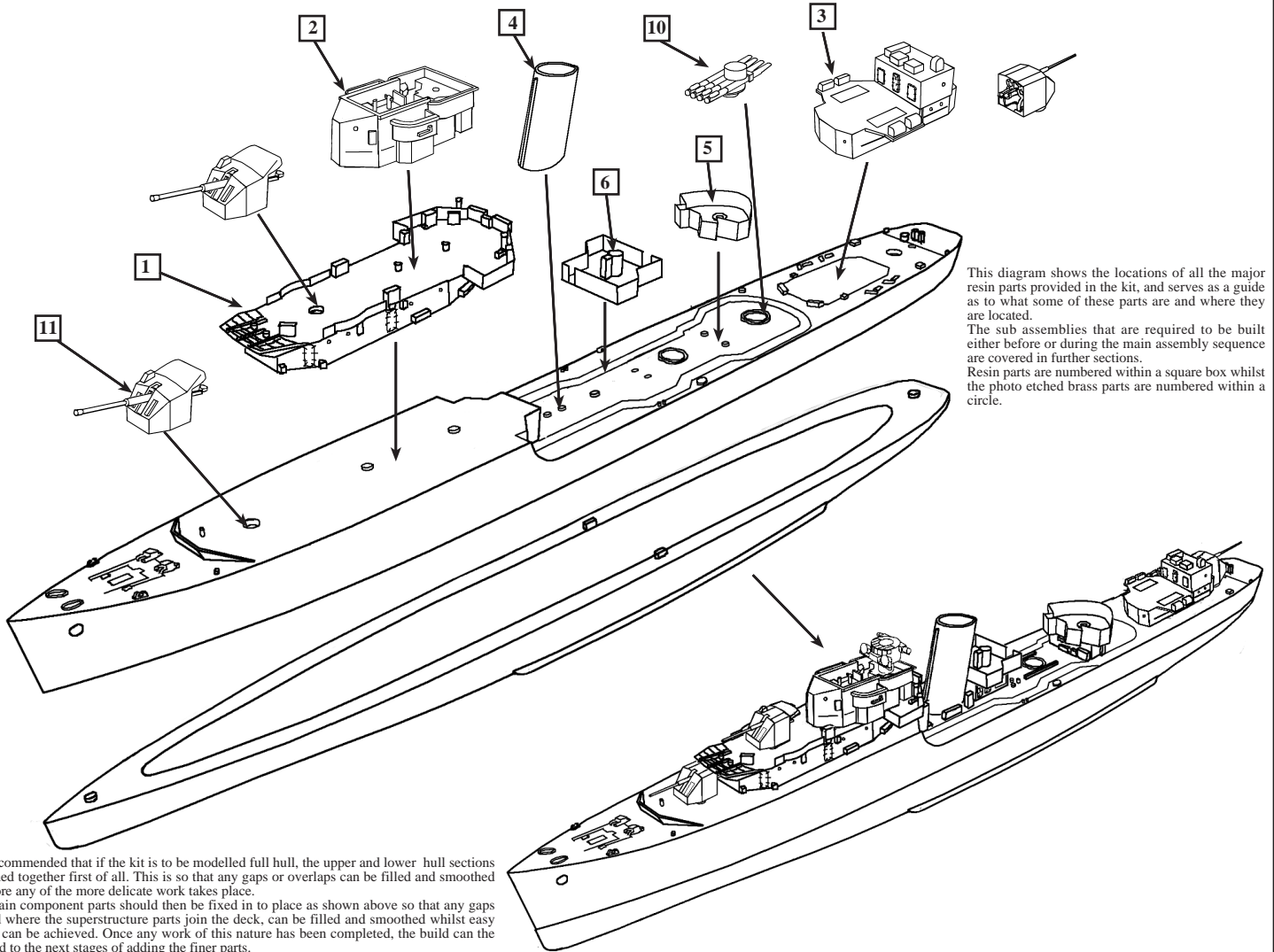

This diagram shows the locations of all the major resin parts provided in the kit, and serves as a guide as to what some of these parts are and where they are located.
The sub assemblies that are required to be built either before or during the main assembly sequence are covered in further sections.
Resin parts are numbered within a square box whilst the photo etched brass parts are numbered within a circle.

It is recommended that if the kit is to be modelled full hull, the upper and lower hull sections be joined together first of all. This is so that any gaps or overlaps can be filled and smoothed in before any of the more delicate work takes place.
The main component parts should then be fixed in to place as shown above so that any gaps around where the superstructure parts join the deck, can be filled and smoothed whilst easy access can be achieved. Once any work of this nature has been completed, the build can proceed to the next stages of adding the finer parts.

4.5" Mk5 Single Gun Mounting Assembly

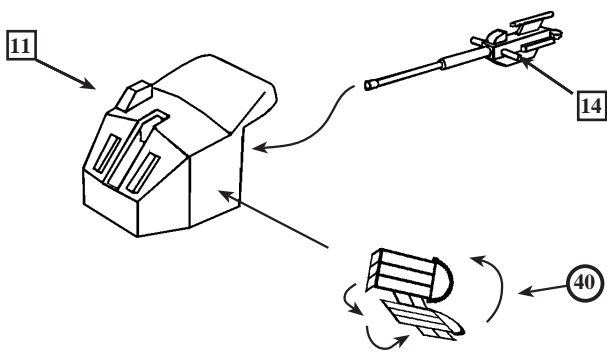

Fit the 4.5" gun, Metal part 14, so that the elevating hinges fit in to the recesses on top of the gun mounting inside the gun shield, Resin part 11.
It may be necessary to clean away excess resin moulding debris from the tops of the mounting to allow the gun hinges to fit properly.
Make 3 of these.

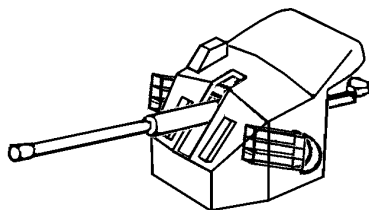

Fold the flare rocket launch rails, etched parts 40, to shape shown and fit to each side of the gun mounting in 'B' position.

40mm Twin Bofors Assembly (Hazemeyer)

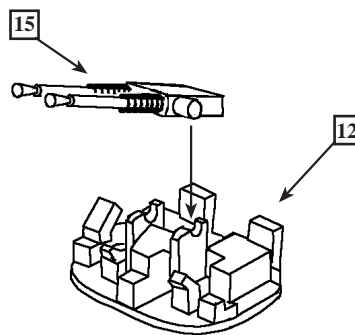

Fold the central mounting frame, part 18A, so that the sides are parallel.
Fit the frame so that the main legs fit behind the gun barrels and the small forward feet fit on top of the gun body.
Fit a small strip of thin (10thou) plasticard across the top of the frame on which to mount the yagi antenna as shown left.
Fit the rear railings and gunsights to the positions shown.
This mark of gun mounting was fitted originally to the C class Destroyers, but replaced at various stages of refit, with the twin Bofors Mk5 gun mounting, dealt with in a further section.

Assemble the yagi radar antennas by curving the rectangular dishes of etched parts 18C as shown. Fit the dipoles in to the holes in the centre of the dishes so that they are parallel.
Fold part 18D in half so that the etched detail is outermost, then attach centrally to the two joining bars between the radar dishes.

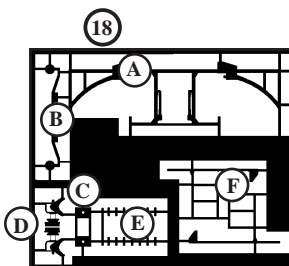
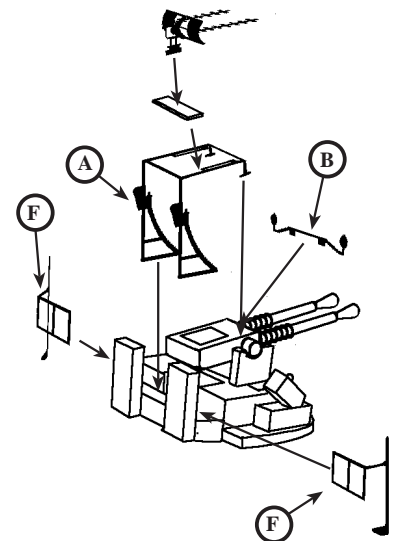
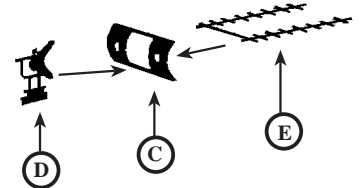

Fo'c'sle Fittings

Assemble the anchors, etched parts 29, by folding the main part of the anchor in half so that it is double thickness with the relief detail outermost, then slotting the base through the rectangular hole in the tipping plate. Fit the anchors in to the holes on each side of the bow. These may require to be drilled out further to take the shaft of the anchor.

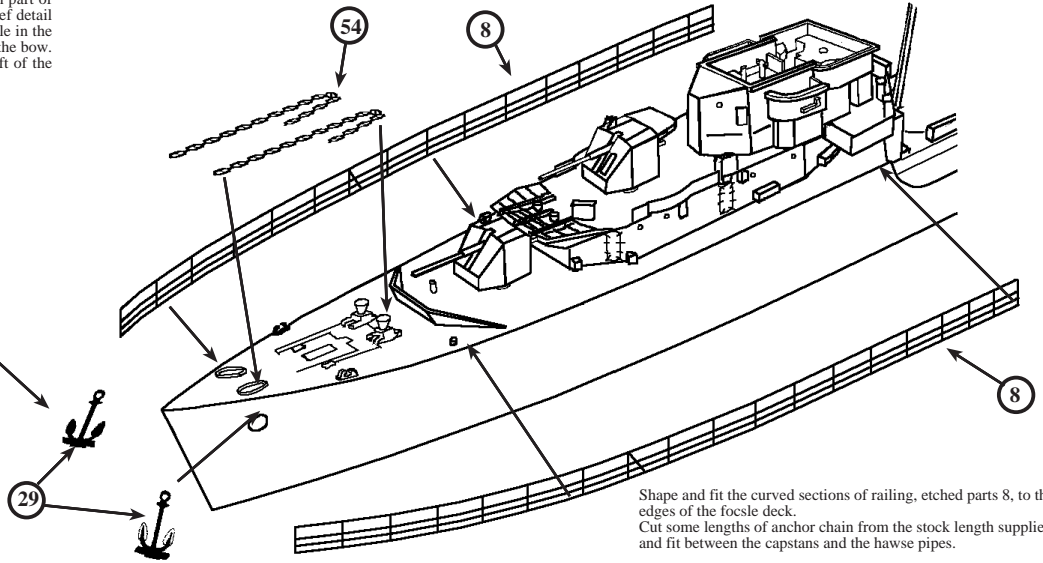
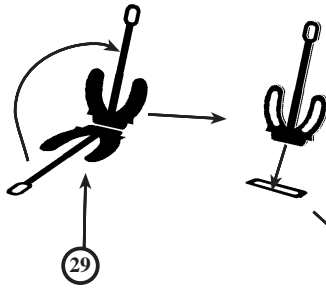

Shape and fit the curved sections of railing, etched parts 8, to the edges of the foc'sle deck.
Cut some lengths of anchor chain from the stock length supplied and fit between the capstans and the hawse pipes.

Forward Superstructure Fittings

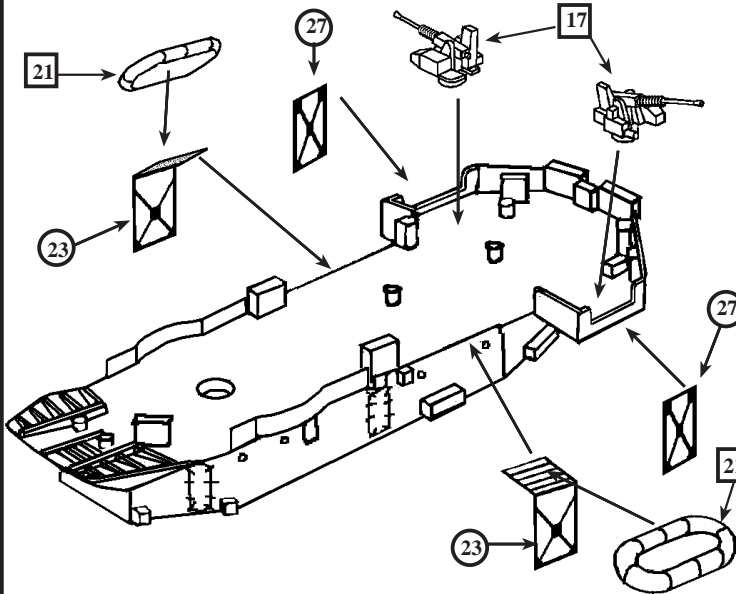

Shape and fit the life raft racks, etched parts 23, to the outboard edges of the gun deck. The cross braced frame should fit along the edge of the main deck. Fit the gun platform supports, etched parts 27, under the Bofors platform extensions, so that the lower edge fits along the edge of the main deck. Cut down the outer section of the gun deck bulwarks to the shape shown to allow the barrels clearance.

Bridge Fittings Location

Shape and fit the bridge canopy, etched part 33, if desired. This is an optional part that was not always fitted.

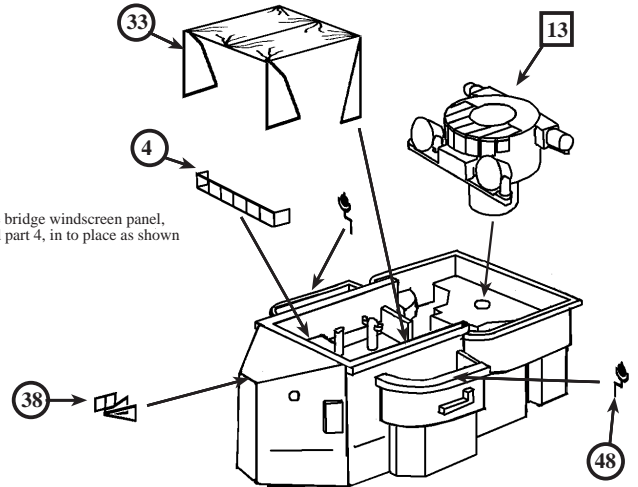

Fit the bridge windscreen panel, etched part 4, in to place as shown

Shape and fit the bridge front DF antenna, etched part 38, as shown above.

Signal lamps, etched parts 48, have been supplied so that they can be fitted if desired.
The etched parts fit on to the rim of the bulwark as shown.

Funnel Fittings

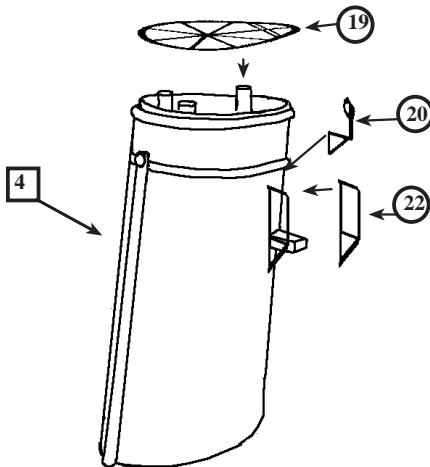

Fit Funnel Cap grill 19 as shown.
Fold the handrails on the small platforms, etched parts 22 around so that they are parallel, with the square platform horizontal in between. A section of vertical ladder may also be fitted from the main deck to the platform.
Fit Siren bracket, etched parts 20, to side of funnel above the platform.

Amidships Carley Raft Racks

Cut away the sections of bulwark from the gun deck as shown below, to allow the Bofors clearance and also to open access ways for the catwalks, fore and aft. The central searchlight platform pillar support will also need to be carefully removed using a sharp chisel shaped blade.

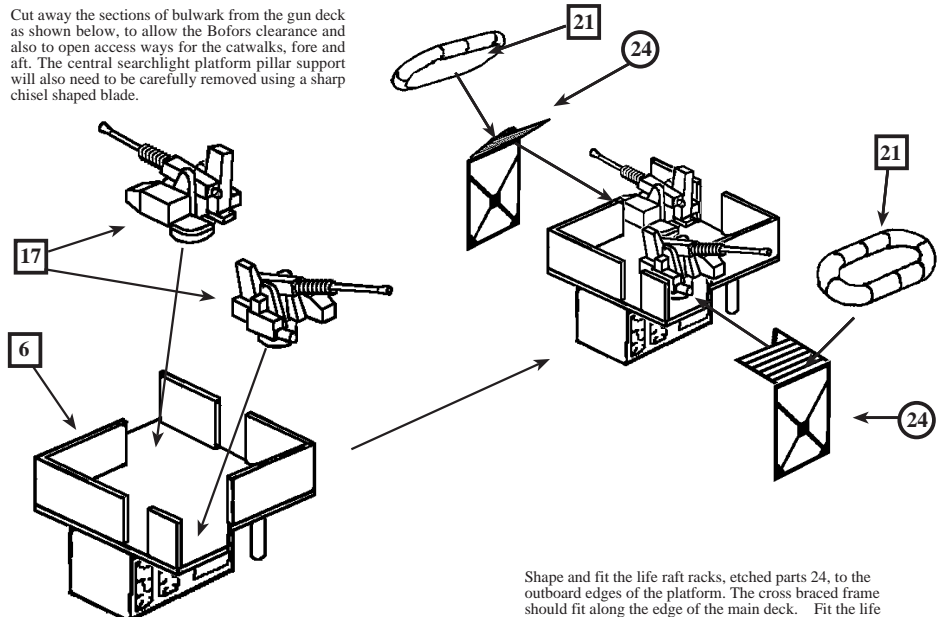

Shape and fit the life raft racks, etched parts 24, to the outboard edges of the platform. The cross braced frame should fit along the edge of the main deck. Fit the life rafts, resin parts 21 to the top of the racks.

40mm Bofors Mk5 Assembly

The twin Bofors Mk 5 mounting can be made from the base of the Hazemeyer mounting by fitting the gun shield, etched part 21 to the centre mounting block on the front as shown. The radar equipment boxes on the base plate may be removed with a sharp knife leaving just the seat and foot pedals in place. This mounting may be used instead of the Hazemeyer if desired.

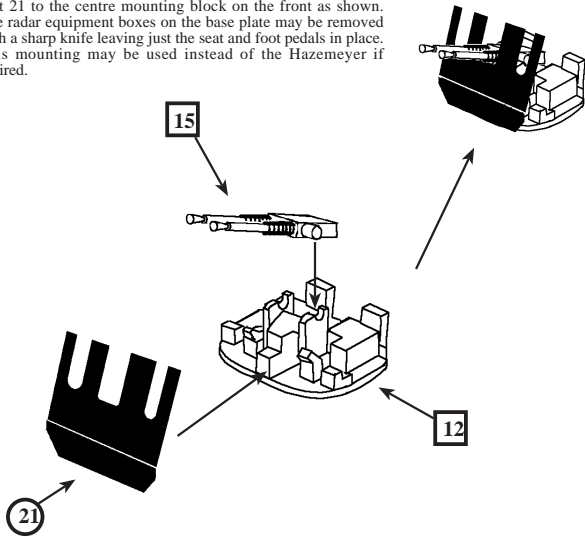

40mm Bofors Platform Assembly

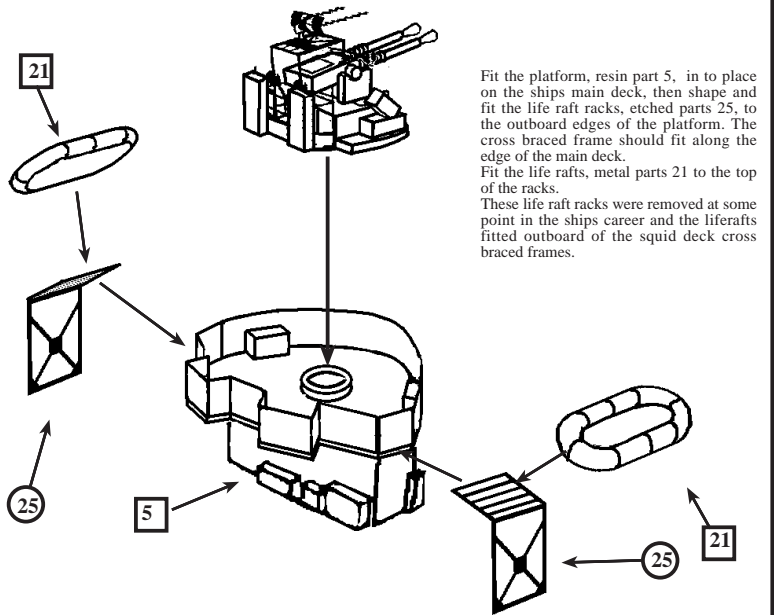

Fit the platform, resin part 5, in to place on the ships main deck, then shape and fit the life raft racks, etched parts 25, to the outboard edges of the platform. The cross braced frame should fit along the edge of the main deck. Fit the life rafts, metal parts 21 to the top of the racks. These life raft racks were removed at some point in the ships career and the liferafts fitted outboard of the squid deck cross braced frames.

Wire Antenna Spreader

A small mast or wire antenna spreader was fitted to the forward end of the Hazemeyer platform. To make this, cut a 14mm length of 0.75mm (30 thou) diameter brass rod and fit vertically as shown. Fit the yardarm, etched part 31 as shown. An additional length of 0.5mm (20thou) diameter brass rod cut to the length of the spar may be used as reinforcing. As an alternative, etched part 45, can be fitted across the rear of the platform if desired.

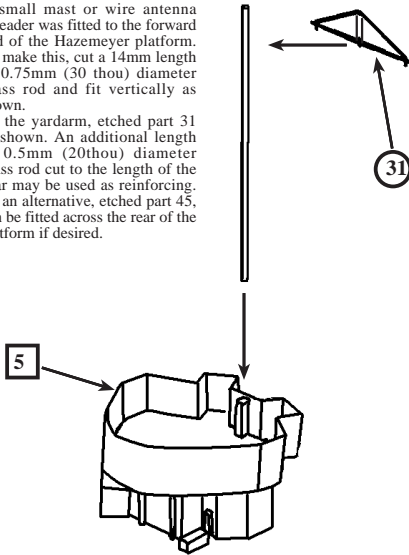

276 Radar Assembly

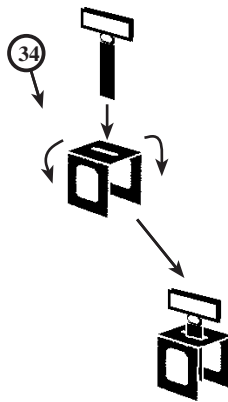

This radar antenna was originally fitted inside a lantern housing on the mast top platform, but was moved down onto a platform fitted to the front of the mast on some of the ships in the class. The assembly has been included in this set as an additional part if the modeller requires to build another ship variant.

Fore Mast Top Array Assembly

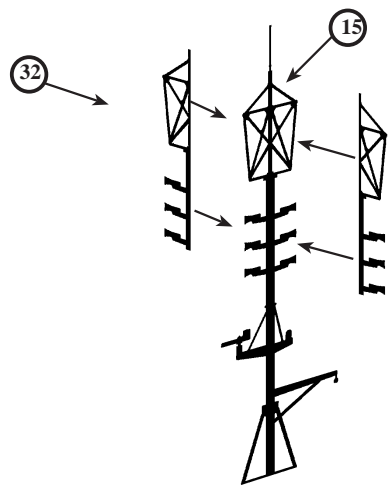

Fit the two side sections of the mast top array as shown so that they are 90° to the main section, etched part 15.

Gun Platform Access Catwalks

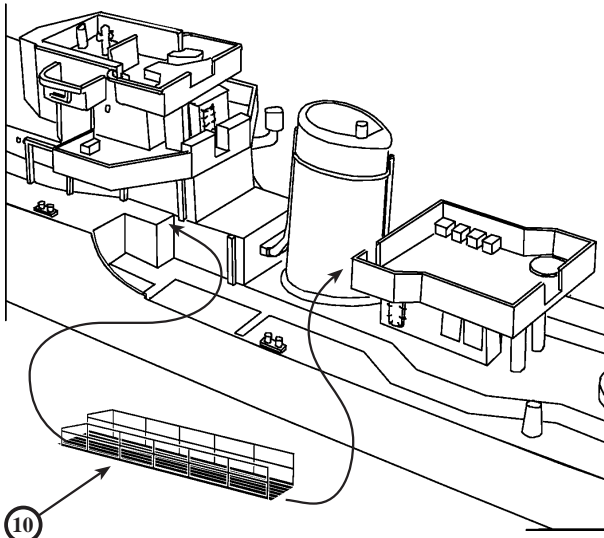

Assemble the catwalks by fitting the handrail lower horizontal bars to the edges of the catwalk foot plate. There should be a small section of catwalk protruding from each end of the handrail sections to allow for location on the edges of the platforms.

Fit the catwalks in to place between the aft platforms so that they form a bridge over the torpedo tubes. The railings or splinter shields on the gun platforms may need to be modified slightly to accommodate these catwalk ends. These catwalks were fitted a lot later to the Emergency Classes and were a post war feature on many.

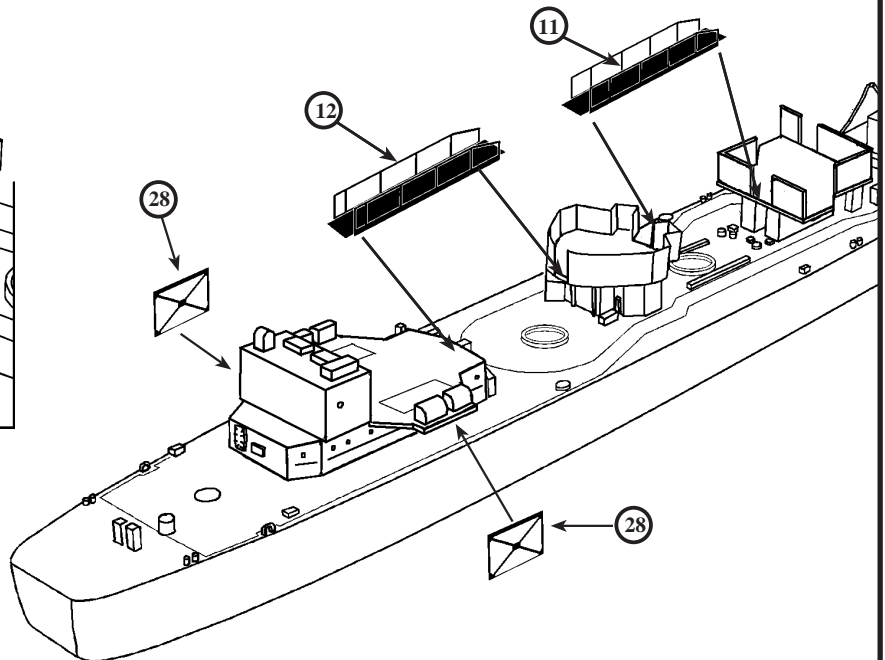

Lattice Mast Assembly (Scorpion)

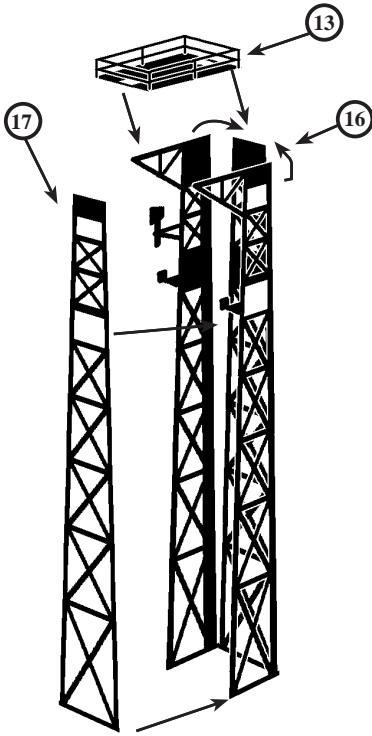

Fold the side lattices of etched part 16 around to 90° so that they are parallel, then bring the edges in together and secure in to place. Fit the front lattice in to place between the two front edges and secure in to place.
 Fold up the railings on the top platform, etched part 13, to 90° and fit the platform to the top of the mast. Fit the yardarms, etched parts 14, to the rear corners on the mast just below the top platform. Fit IFF Antenna, etched part 43, centrally to the rear of the mast top, just below the platform level.
 Fit the mast top antenna array, etched parts 15 and 32 having assembled them as previously described.

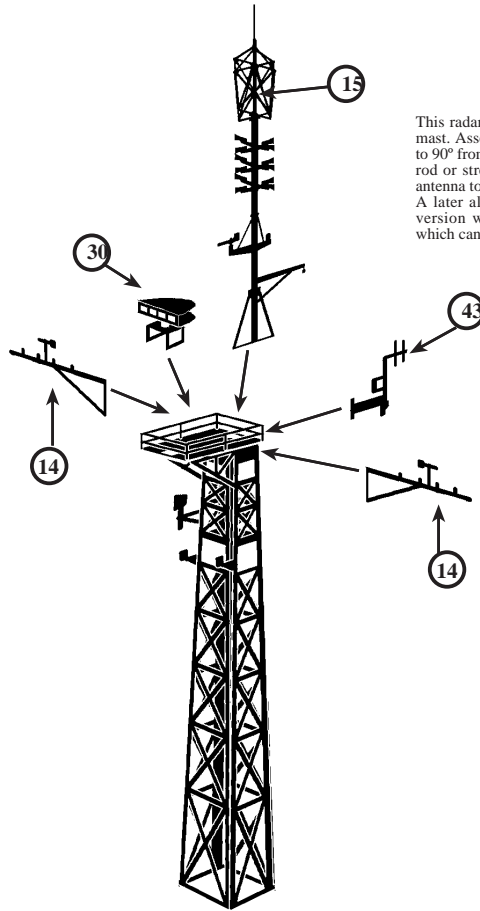

This radar was fitted to the top platform of the lattice mast. Assemble by folding the half circular plates back to 90° from the front plate. Cut a small length of plastic rod or stretched sprue and use as a spindle to fit the antenna to its base as shown above.
 A later alternative fitted to some ships is the larger version which has been supplied as metal part 18, which can be used if desired.

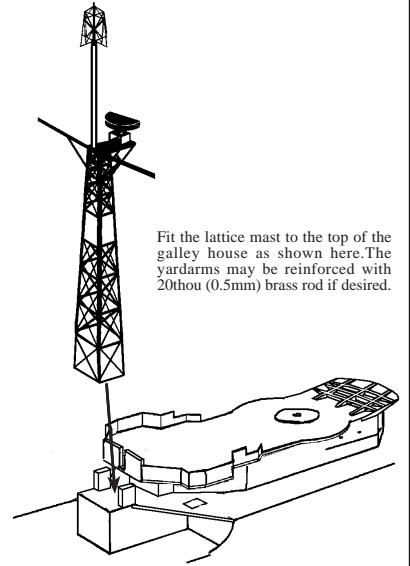
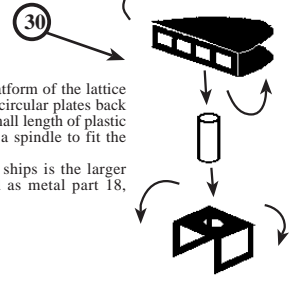

Fit the lattice mast to the top of the galley house as shown here. The yardarms may be reinforced with 20thou (0.5mm) brass rod if desired.

Boat Davit Assembly



Fold the davits, etched parts 9 in half so that the relief etched detail is outermost. Fix the halves together with adhesive.

Ships Boats Assembly

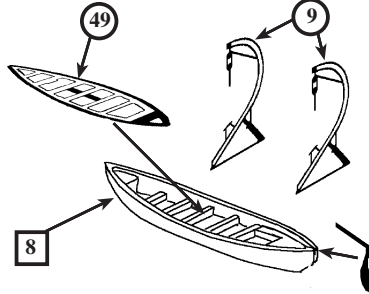

To fit the thwarts in to the whaler, first remove any remaining molded detail present inside the boat. Fit the thwarts as shown then fit the rudder to the stern of the boat. It will be easier to fit the boats to the davits if the davits are first fitted in to position on the main deck and secured in to place.

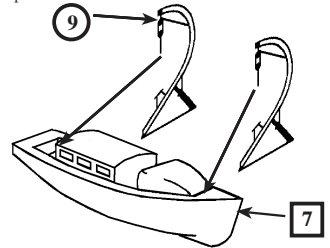

Ships Boats Location

Fit davits, etched parts 9, in to position on the main deck and secure in to place. Test fit the boats and note the position of where the falls will pass. Drill small holes through the boats at these positions and then pass the falls through the holes until the boats are snugly in position against the davits. Secure in to place.

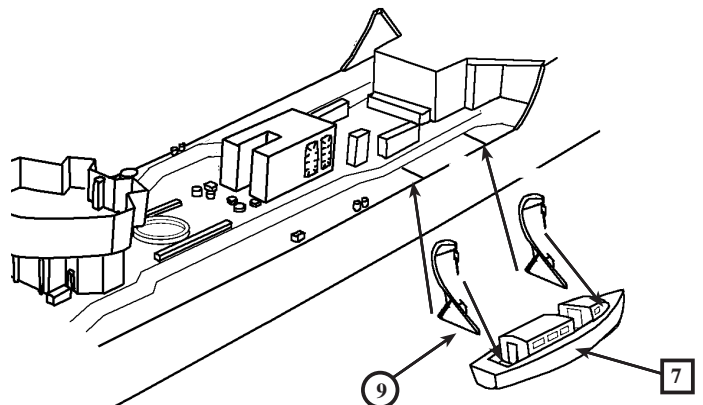
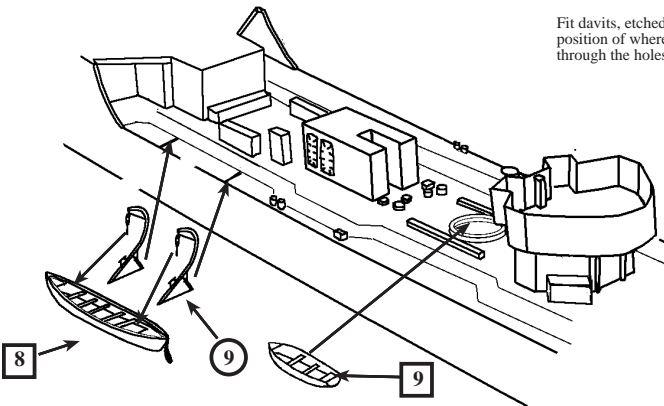

Squid Mortar Assembly and Aft Superstructure Fittings

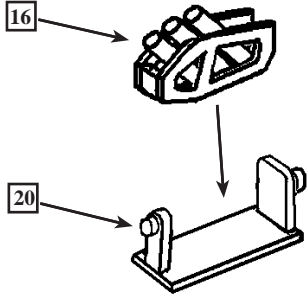

Fit the assembled squid mortars into place on the raised rectangle sections of deck, then fit the rail tracks, etched parts 52 into place, on the deck between the two mortar mountings as shown right. Shape and fit the sections of railing, etched parts 6, to the edges of the deck.

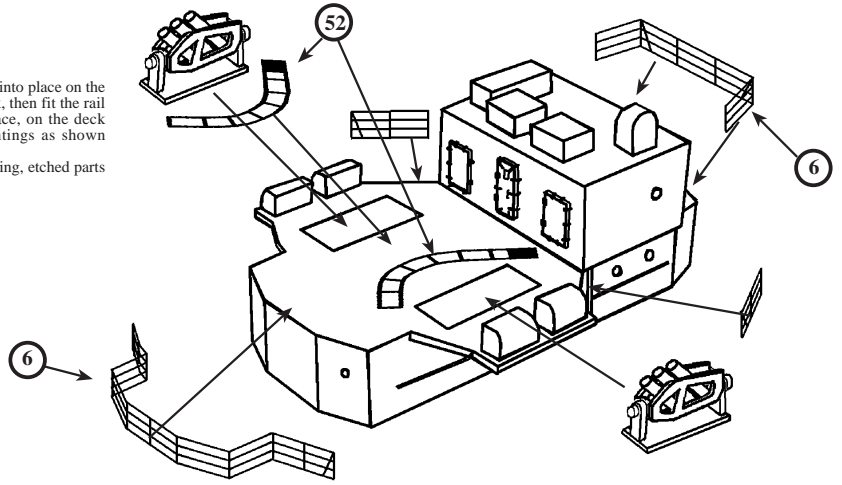

Fit the triple barrelled squid mortar unit, white metal part 16, into the mounting base, white metal part 20, as shown above. The barrel unit may be rotated to the desired angle before securing into place. Make two of these

Propeller and Rudder Fitting

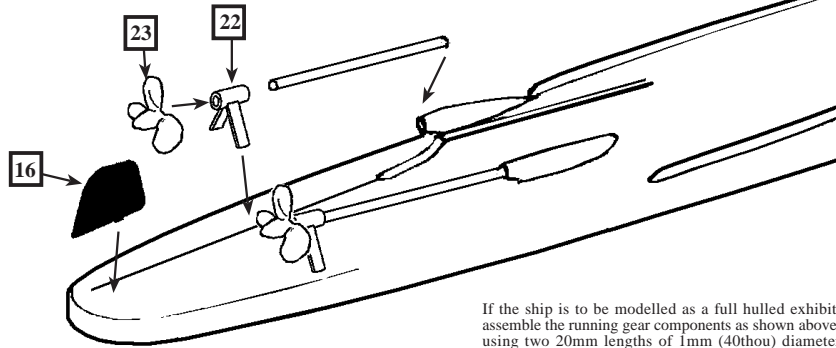

If the ship is to be modelled as a full hulled exhibit, assemble the running gear components as shown above, using two 20mm lengths of 1mm (40thou) diameter plastic rod.

Colour Chart and Painting Guide

- Light Admiralty Grey
Colourcoats M23
- RN Deck Green
Colourcoats M19
- Anti Fouling Red
Colourcoats RN 19

Colourcoats, Paints can be obtained directly from
Sovereign Hobbies

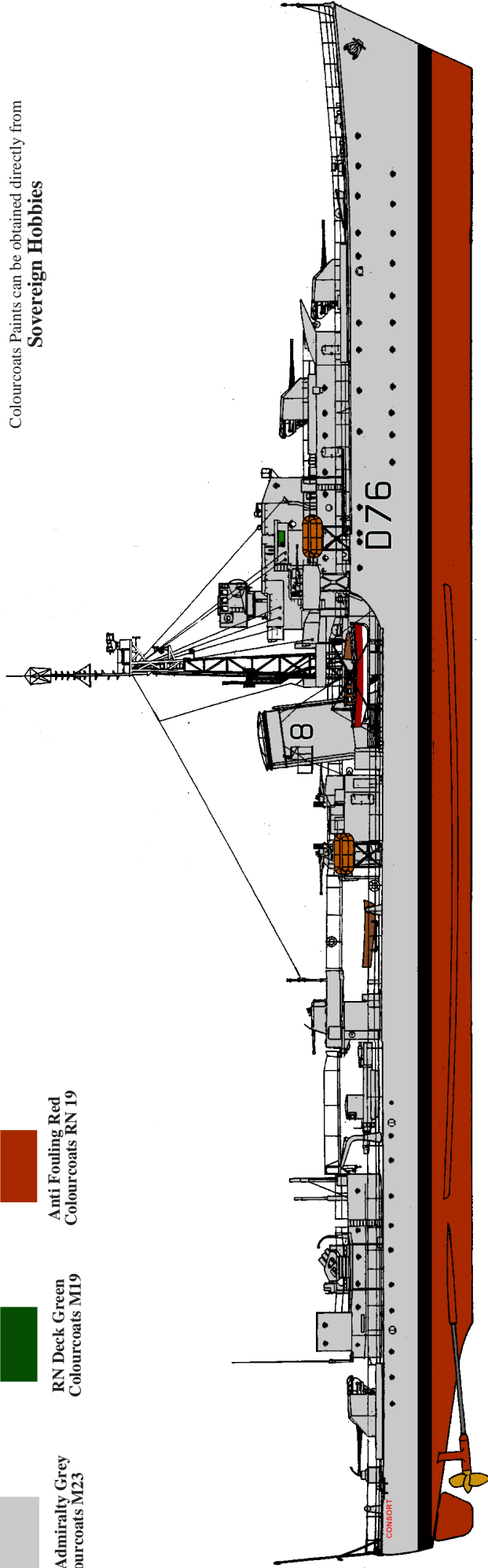

HMS Consort 1955

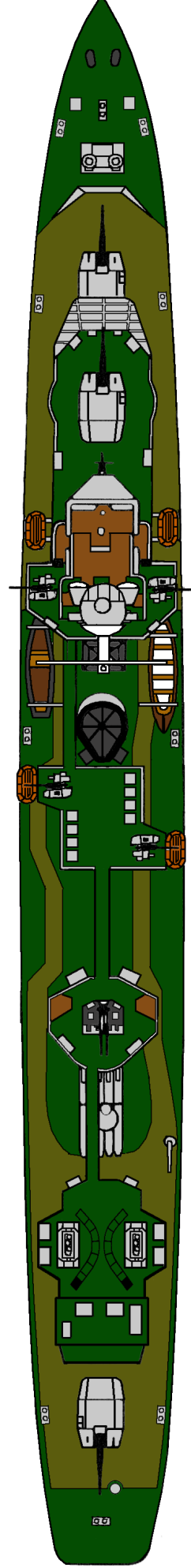

All colours quoted are from the Colourcoats range of authentic colours supplied by Sovereign Hobbies.

Other colours used

- Matt Black.....Fore Mast up to the third horizontal from the top platform. Gun Barrels, Waterline Boot Topping, Funnel Cap and Grill.
- Matt White.....Fore Mast Top and Yardarms from the third horizontal from the top platform. Bollards and Fairleads, Capstans and Deck Fittings
Ships Boats below waterline.
- Bronze.....Propellers
- Burgundy Red.... Ships Boats above waterline.
- Tan Brown.....Carley Rafts
- Natural Wood.... Sea Boat Thwarts and Coachwork on Motor Boat
- Corticeae Linoleum.... Bridge and Signal Deck

Note:

The green deck colouring appears lighter on the walkway area and on the focsle deck where the layer of cement was applied. This was due to the uneven weathering and fading of the paint on a different surface material.
This can be obtained by adding a small amount of a buff colour to the basic deck green before painting the walkways