

1943 'Battle' Class Destroyer
H.M.S. JUTLAND
1957

Resin & Photo Etched Metal Kit in 1/350 scale

History

HMS Jutland was one of the later Battle class or 1943 Destroyers, that followed on from the 1942 Battles. She was laid down in 1945 but cancelled, and her sister ship HMS Malplaquet, was renamed HMS Jutland prior to her launch in February 1946. Commissioned in July 1947, Jutland became part of the 4th Destroyer Flotilla and served with the home fleet. She deployed with HMS Theseus and Vengeance on a visit to South Africa with other ships of her class in company and spent time in several ports there as well as taking part in exercises with the SAN.

In 1950 HMS Jutland was laid up in reserve temporarily, but then a year later returned to active service with the Home and Mediterranean Fleets. She took part in the Queens Coronation Review in 1953, but was then laid up in reserve again until 1957 when she joined the 7th Destroyer Flotilla in the Home and Mediterranean Fleets. In 1958 HMS Jutland collided with her sister ship HMS Dunkirk, during a daytime exercise, but suffered only minor damage. She continued service until 1961 when again she was laid up in reserve and then was placed on the disposal list. HMS Jutland was sold and broken up for scrap in 1965.

Specifications

Length: 379ft oa. Beam: 40ft 6in Displacement: 2,480 tons standard 3,430 tons full load. Speed: 35.75 knots max

Armament: 4 x 4.5 inch QF guns in two Twin Mk4BD mountings. 1 x Single 4.5" QF Gun in Mk5 Mounting
 2 x Twin 40mm STAAG Mountings, 1x Twin 40mm Mk 5 Mounting, 2 x Single 40mm Bofors Mk7 Mounting
 10 x 21inch Torpedo Tubes in Two Quintuple Mountings. 1 x Squid AS Mortar

This kit contains a mixture of resin and photo etched metal small parts, of which some of the resin parts have been attached to sprues for ease of casting. Care must be taken when detaching the parts from the sprues, to remove the flash without causing damage. When cleaning off the excess material using files or abrasive paper, it is recommended that a mask is worn as resin dust can be harmful to health if inhaled.

Resin and Metal Parts Identification

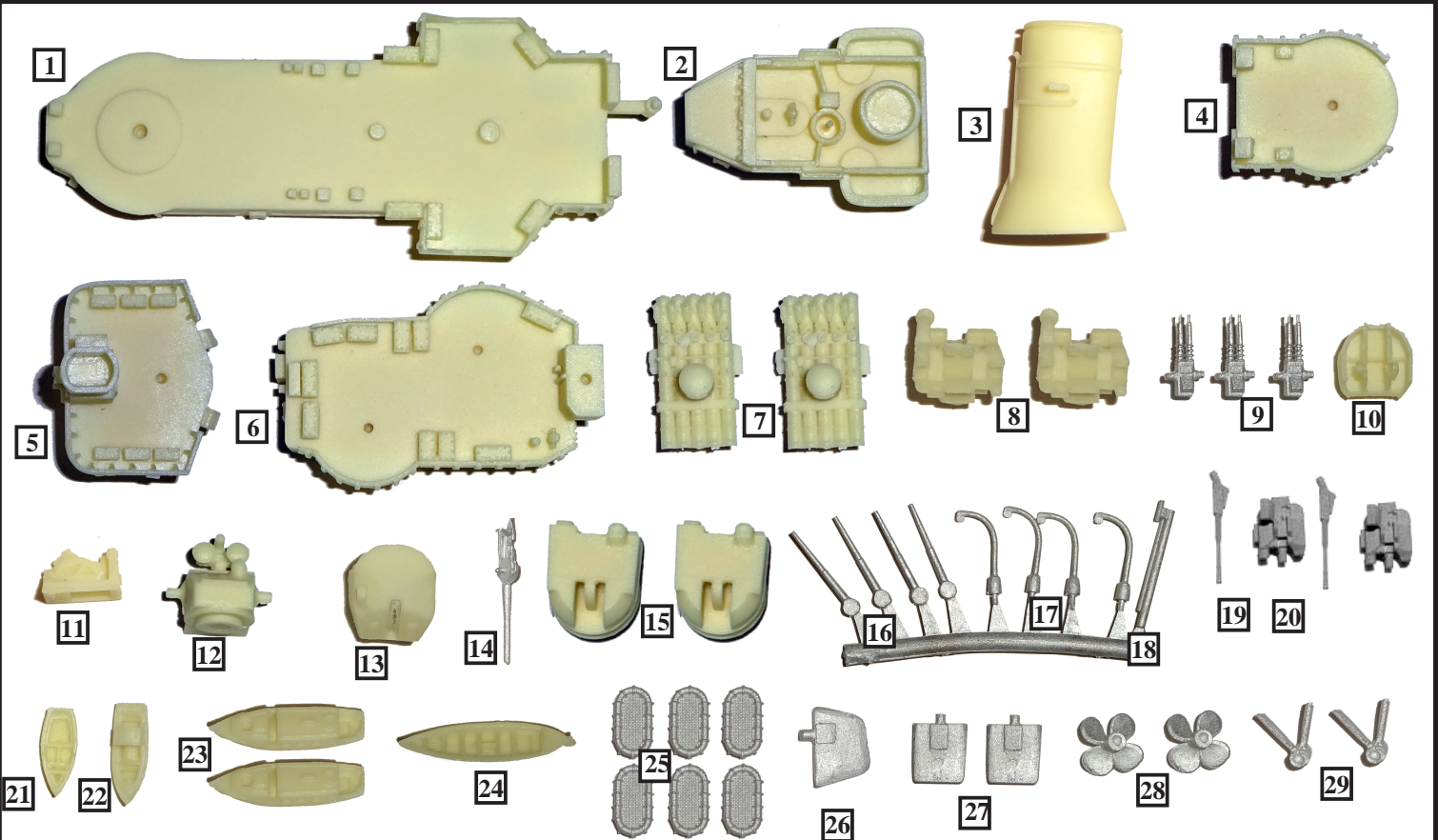

- | | | |
|------------------------------|---------------------------------|--------------------------------|
| 1. Forward Superstructure | 11. Squid Mortar Mounting | 21. 14' Sailing Dinghy |
| 2. Bridge | 12. US Mk 37 Main Director | 22. 16' Fast Motor Boat |
| 3. Funnel | 13. 4.5" Mk5 Gun Mounting | 23. 25' Admiralty Motor Cutter |
| 4. Forward Gun Deck | 14. 4.5" Single Gun | 24. 27' Whaler |
| 5. Mid Twin Gun Deck | 15. 4.5" Twin Mk4 Gun Turrets | 25. Carley Rafts |
| 6. Aft Superstructure | 16. 4.5" Gun Barrels | 26. Rudder |
| 7. Quintuple Torpedo Tubes | 17. Boat Davits | 27. Stabiliser Fins |
| 8. 40mm Twin STAAG Mountings | 18. Main Mast Pole | 28. Propellers |
| 9. Twin 40mm Guns | 19. 40mm Single Bofors Mounting | 29. Propeller 'A' Frames |
| 10. Twin 40mm Mk5 Mounting | 20. 40mm Single Bofors Barrel | |

Photo Etched Parts Identification

ATLANTIC MODELS © 2022

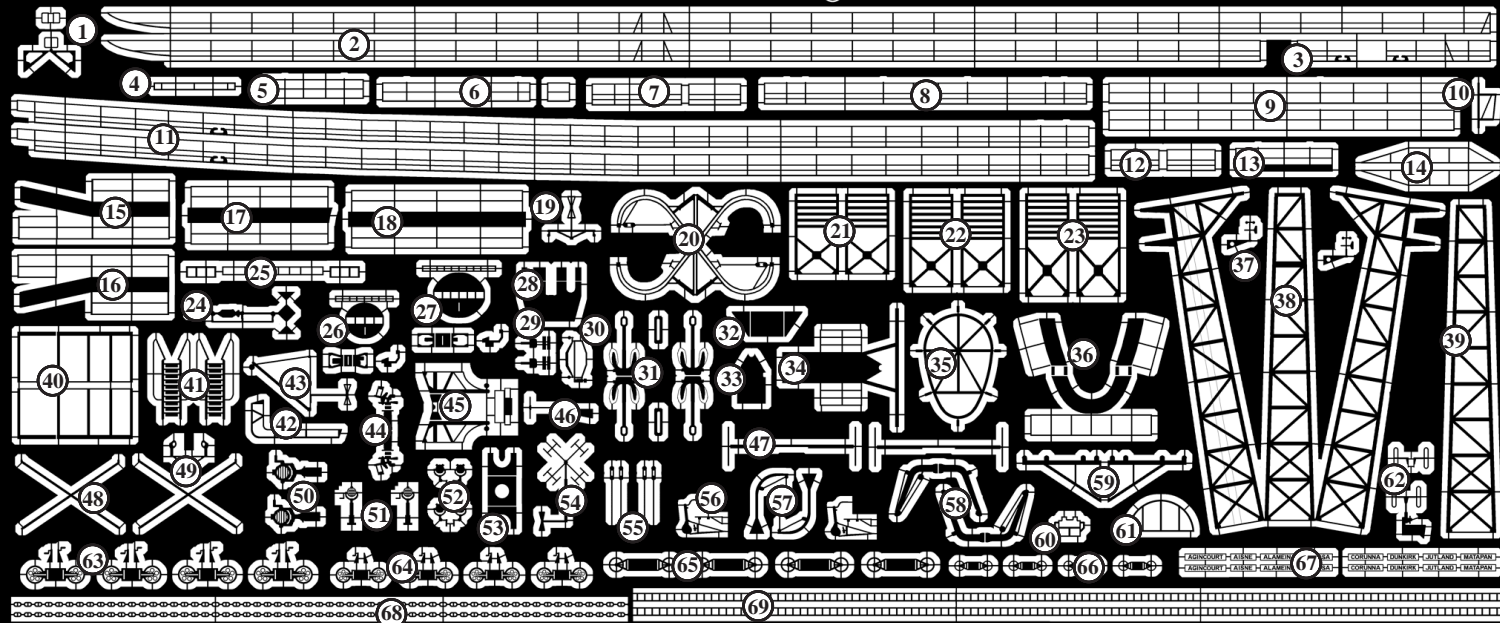

1943 'BATTLE' Class Destroyers 1/350 Scale

- | | | | |
|---|---------------------------------|----------------------------------|--------------------------------|
| 1. Bridge Front DF Antenna | 18. Catwalk (Aft) | 36. Funnel Siren Platform | 53. 293 Radar Antenna Mounting |
| 2. Railings (Main Deck) | 19. Fore Mast Top Array | 37. Fore Mast Weather Vanes | 54. 291 Air Warning Radar |
| 3. Railings (Stern) | 20. Boat Davits | 38. Fore Mast Lattice | 55. Boat Davit Falls |
| 4. Squid Bomb Trolley Tracks | 21. Carley Raft Racks (Aft) | 39. Fore Mast Front Frame | 56. 25' Motor Cutter Parts |
| 5. Railings (Main Director Acces) | 22. Carley Raft Racks (Forward) | 40. 40mm Gun Platform Supports | 57. Paravane Davits |
| 6. Railings (Aft Superstructure) | 23. Carley Raft Racks (Centre) | 41. Inclined Ladders (Hull Step) | 58. Torpedo Loading Davits |
| 7. Railings (Forward Gun Platform) | 24. Dan Bouy | 42. Squid Mortar Loading Rail | 59. Fore Mast Yardarms |
| 8. Railings (Fore Mast Base) | 25. Bridge Windscreen | 43. Main Mast Gaff | 60. Main Director Front Panel |
| 9. Railings (Fwd Superstructure Sides) | 26. 293 Radar Antenna | 44. 293 Radar Mounting | 61. Single 4.5 Gun Cover Rail |
| 10. Headache Antenna | 27. 293P Radar Antenna | 45. Depressor Paravane Platform | 62. Fore Mast Stbd Aft Antenna |
| 11. Railings (Fo'c'sle) | 28. 40mm Mk5 Gun Shield | 46. Mid Mast Aft Antenna | 63. Cable Reels (Large) |
| 12. Railings (Mid Gun Platform) | 29. 40mm Gun Layers Seats | 47. Fore Mast Top Fwd Antennas | 64. Cable Reels (Small) |
| 13. Railings (Fwd Superstructure Front) | 30. 40mm Twin Gun Sights | 48. Boat Restraining Straps | 65. Cordage Reels (Large) |
| 14. Railings (Bofors Gun Platforms) | 31. Anchors | 49. Funnel Sirens | 66. Cordage Reels (Small) |
| 15. Catwalk (Forward Stbd) | 32. Fore Mast (Lower Platform) | 50. Large Signal Lamps | 67. Ships Name Plates |
| 16. Catwalk (Forward Port) | 33. Fore Mast (Mid Platform) | 51. Medium Signal Lamps | 68. Anchor Chain |
| 17. Catwalk (Middle) | 34. Fore Mast (Top Platform) | 52. Small Signal Lamps | 69. Vertical Ladder Stock |
| | 35. Funnel Cap Grill | | |

Other Instructions

- A decal sheet included in this kit, allows the possibility of most ships of this class to be modelled. The pennant numbers can be cut out and arranged as required to match the ships name in red that is placed on the stern quarters.
- Etched parts 69 are stock lengths of vertical ladders. These can be cut to the required length and fitted to the sides of deck houses and bulkheads, masts and platforms as required. Etched parts 41 are the inclined ladders fitted to the hull step at the gap in the railings forward of the boats.
- Etched parts 68 are stock lengths of Anchor Chain. Sufficient length is supplied to allow the model to be built on a seascape at anchor with the cahin running from the hawse pipe holes to the surface of the waterscape. Also there is enough to fit one the deck from the cable locker holes around the capstans and out to the hawse pipe holes.
- Etched parts 67 are the ships name plates, that are used when the ship is in harbour or at a bouy. These are fitted at each side of the aft superstructure or adjacent to the gangway or accomodation ladder access.

Dan Buoy Assembly

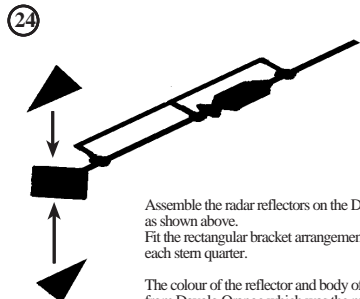

Assemble the radar reflectors on the Dan Buoys, etched parts 24, as shown above.
Fit the rectangular bracket arrangement onto the side railings on each stem quarter.

The colour of the reflector and body of the Dan Buoys varied from Dayglo Orange which was the most common, to Red and White 90° alternate sections
These were usually fitted to the railings, outboard, on each side of the quarterdeck

Cable and Cordage Reel Assembly

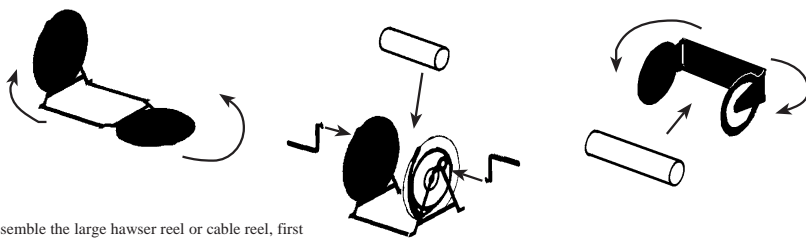

To assemble the large hawser reel or cable reel, first fold up each of the drum ends to 90° so that they are parallel.
Take care that the joiner strips along the base are not damaged.
Cut a length of plastic rod to fit between the ends of the centre spindle.
Fit the crank handles to each end in the locating hole provided as shown, so that the cranks oppose each other.

There are several variations of cordage reel supplied in this set. The diagram shown, describes the assembly of one of the small wall mounted reels that can be found positioned on bulkheads at various points around the ships upper decks. Deck mounted reels are assembled in the same manner only turned 90°.

ATLANTIC MODELS © 2022

1 Hillview Grove, Easington, Durham, SR8 3NT. UK Tel. 0191 5271574
e.mail: peter@atlanticmodels.net Website http://www.atlanticmodels.net

Main Parts Location Diagram

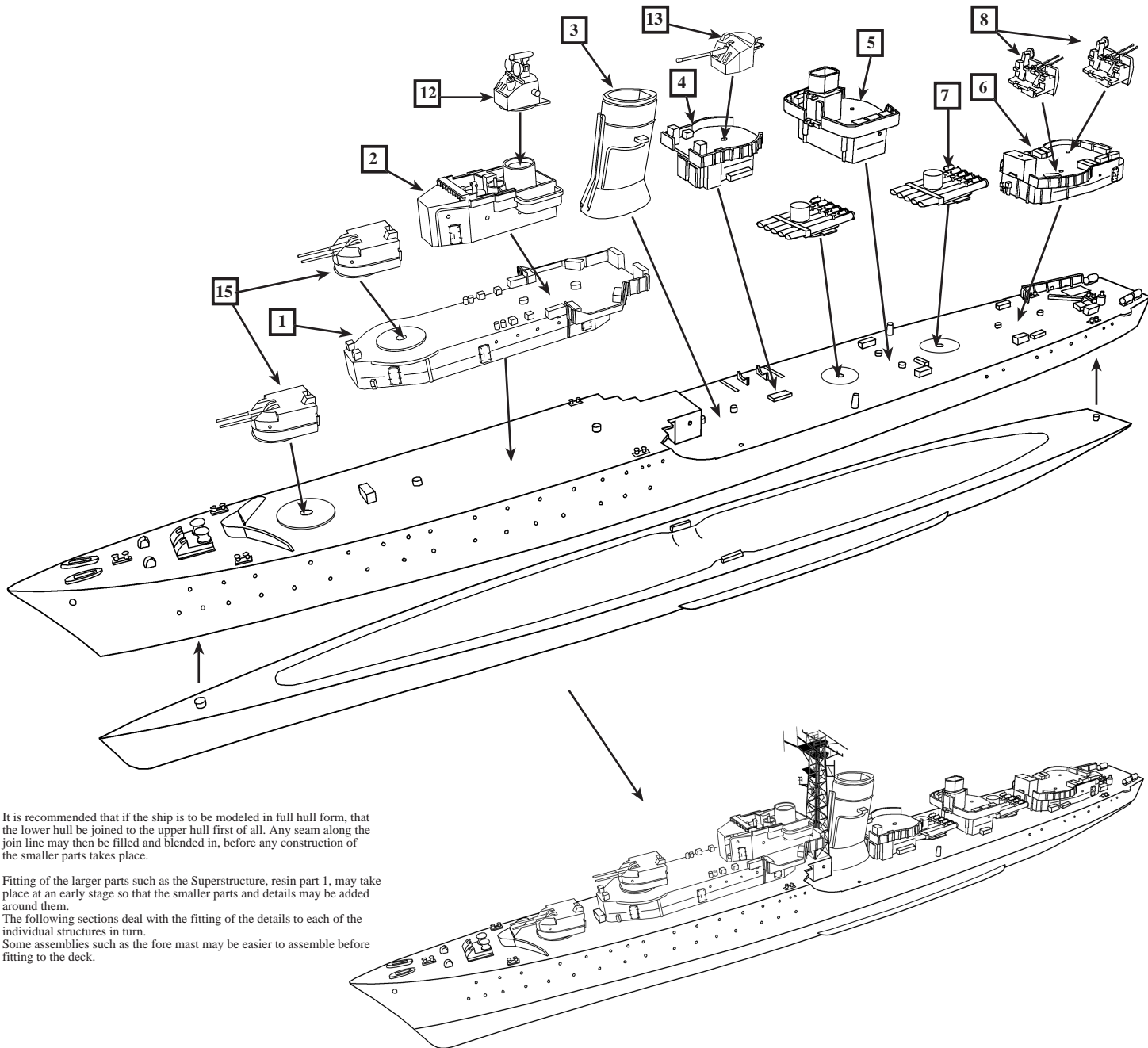

It is recommended that if the ship is to be modeled in full hull form, that the lower hull be joined to the upper hull first of all. Any seam along the join line may then be filled and blended in, before any construction of the smaller parts takes place.

Fitting of the larger parts such as the Superstructure, resin part 1, may take place at an early stage so that the smaller parts and details may be added around them.

The following sections deal with the fitting of the details to each of the individual structures in turn. Some assemblies such as the fore mast may be easier to assemble before fitting to the deck.

4.5" Mk4 and Mk5 Gun Mounting Assemblies

Fit the two 4.5" gun barrels, metal parts 16, into the slots in the front of the Mk4 gun turret as shown right. These can be angled up to any elevation desired before fixing into place. Make two of these

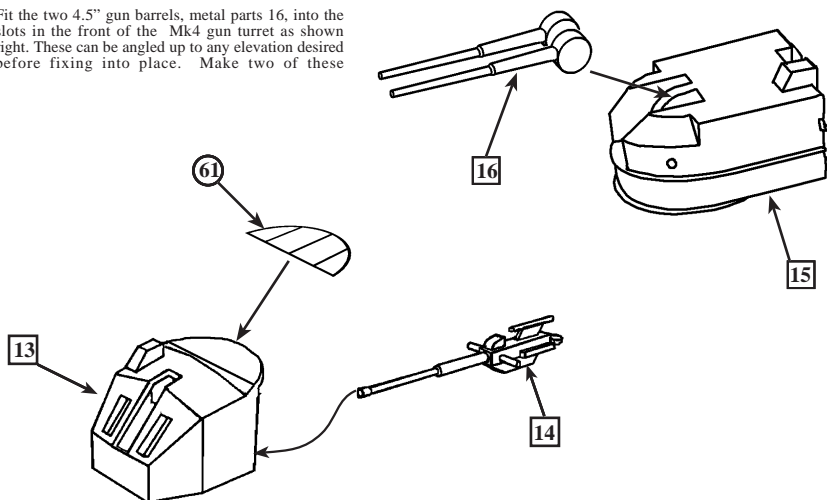

Fit the 4.5" gun, Metal part 14, so that the elevating hinges fit in to the recesses on top of the gun mounting inside the gun shield, Resin part 13. It may be necessary to clean away excess resin moulding debris from the tops of the mounting to allow the gun hinges to fit properly. The semi circular resin weather shield may be cut away and replaced with the open frame, etched part 61, if desired.

40mm Bofors STAAG Assembly

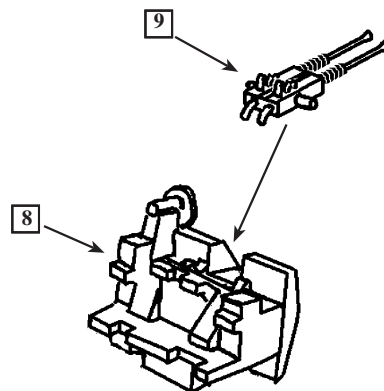

Fit the 40mm twin gun barrels, metal part 9 so that the side lugs locate in the central part of the mounting, resin part 8. Make two of these and fit to the top of the aft superstructure, en echelon as shown in a later section.

Twin 40mm Bofors Mk5 Assembly

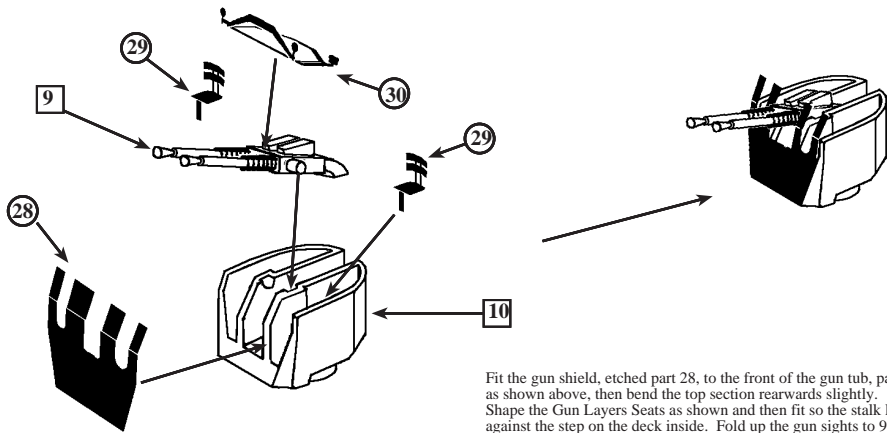

Fit the gun shield, etched part 28, to the front of the gun tub, part 10 as shown above, then bend the top section rearwards slightly. Shape the Gun Layers Seats as shown and then fit so the stalk locates against the step on the deck inside. Fold up the gun sights to 90° on the mounting frame, then fit to the top of the gun barrels as shown. Fit the gun barrels, metal part 9, into the gun tub so that the side lugs locate into the recesses in the central mounting.

Single 40mm Bofors Mk7 Assembly

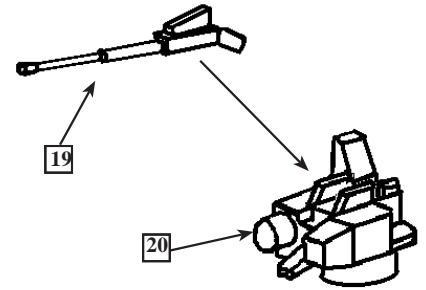

Fit the body of the 40mm Bofors gun, part 19, into the recess on the top of the Gun Mounting, part 20. Make two of these.

This gun mounting was fitted to the gun platforms on each side of the forward superstructure below the bridge.

293 Radar Antenna Variants

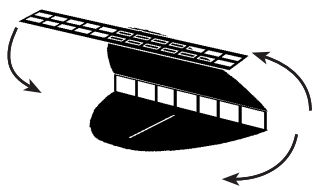

There are two different sizes of 293 Radar antennas provided in this set. To assemble these the sequence is basically the same for all three. Fold the radar antenna part over in stages of 90° at the front grill, then fold the rear grill down 90° and gently curve to shape so that it fits around the curved top and bottom edges of the antenna plates. Secure into place. Fit the mounting/transducer horn parts centrally to the underside of the bottom plate. Shape the mounting base by folding down the side panels so that they are parallel.

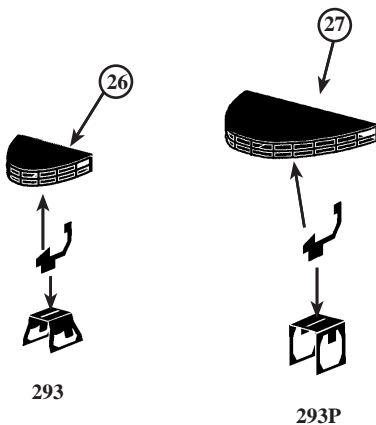

USN Mk 37 DCT Assembly

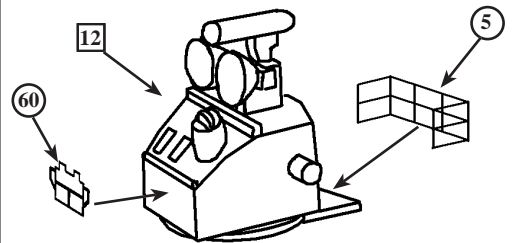

Shape and fit the railing section, etched part 5 to the edge of the access platform to the rear of the director. Fit the radar reflector panel, etched part 60 to the front of the director as shown.

Bridge Fittings Location

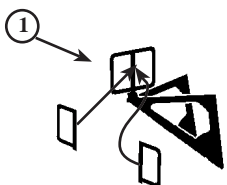

Fold the mounting brackets of the DF Antenna, etched part 1, to the rear as shown left, so that they form a triangle when viewed from above. Fit the two half loops to the sides of the centre post so that they form a cross when viewed from above. Fit to the front of the bridge structure, centrally just below the upper edge.

Fit the Mk37 Director assembly into the circular top of the barbette.

Fit the Bridge Windscreen sections, etched parts 25, to the edges of the bridge as shown below.

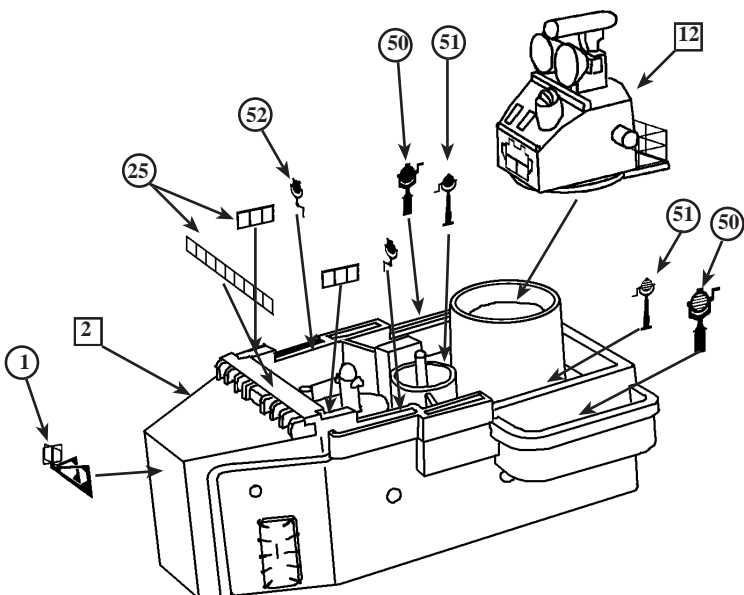

Fit the large Signal/Searchlights, etched parts 50 into the side extensions of the bridge platform. Fit the smaller free standing Signal Lamps, etched parts 51, onto the semi circular platforms inside the bridge rear platform. Fit the bulwark mounted Signal Lamps, etched parts 52, to the sides of the bridge as shown above. These lamps may be given a more 3D appearance by backing the central part of the lamp with a slice of plastic rod to the same diameter as the lamp.

Lattice Fore Mast Assembly

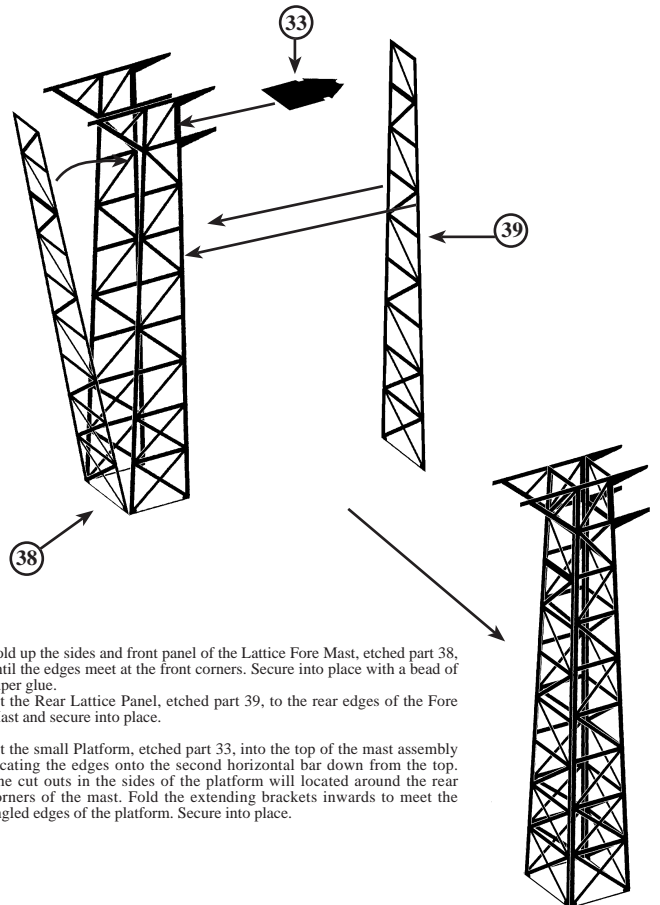

Fold up the sides and front panel of the Lattice Fore Mast, etched part 38, until the edges meet at the front corners. Secure into place with a bead of super glue. Fit the Rear Lattice Panel, etched part 39, to the rear edges of the Fore Mast and secure into place.

Fit the small Platform, etched part 33, into the top of the mast assembly locating the edges onto the second horizontal bar down from the top. The cut outs in the sides of the platform will locate around the rear corners of the mast. Fold the extending brackets inwards to meet the angled edges of the platform. Secure into place.

Lattice Fore Mast Fittings Location

Fit the two half dipoles to the centre post of the Mast DF Antenna, etched part 62, so that they form a cross when viewed from above. Fit to the rear starboard corner of the mast as shown below, between the second and third horizontal bars down from the top.

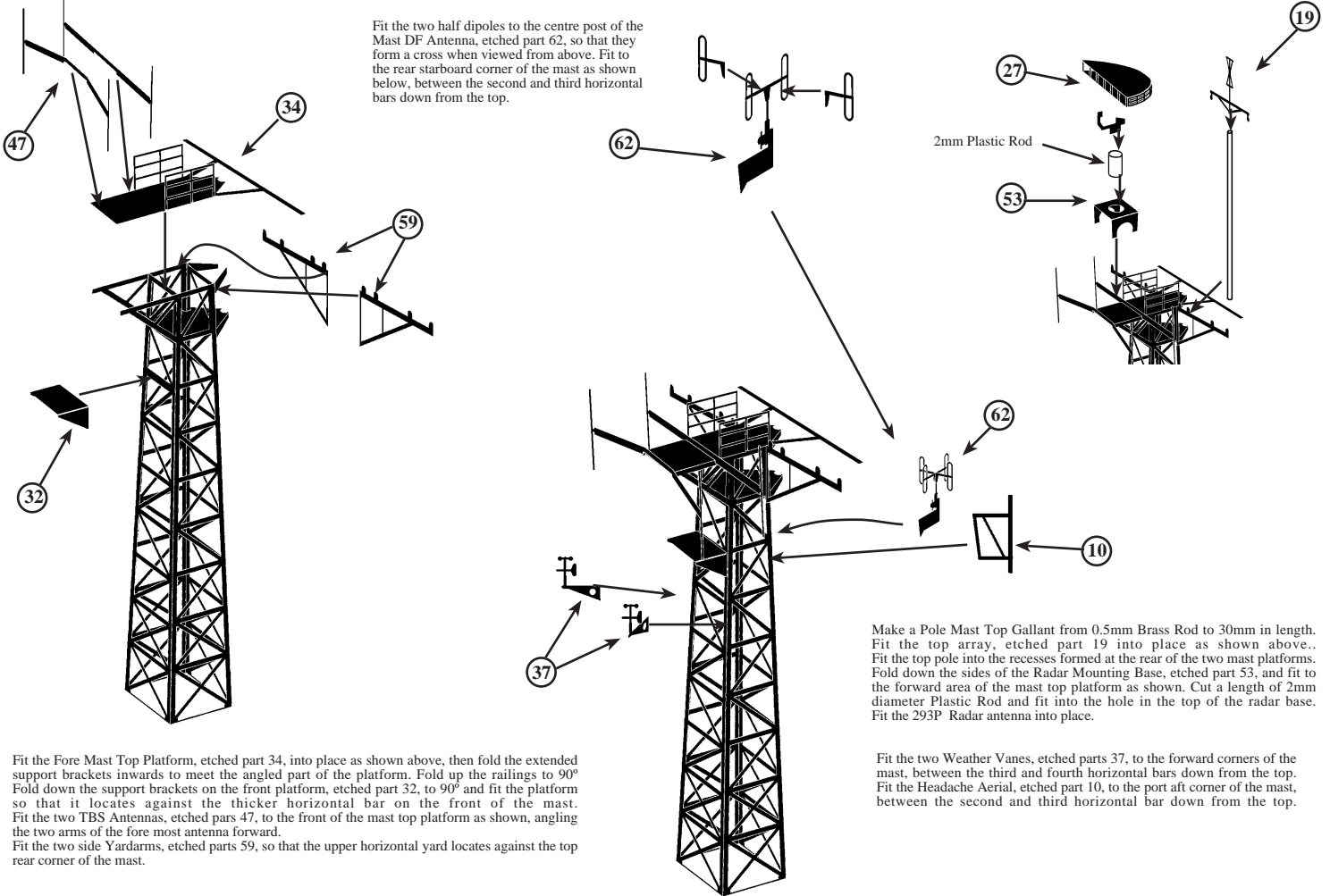

Fit the Fore Mast Top Platform, etched part 34, into place as shown above, then fold the extended support brackets inward to meet the angled part of the platform. Fold up the railings to 90°. Fold down the support brackets on the front platform, etched part 32, to 90° and fit the platform so that it locates against the thicker horizontal bar on the front of the mast. Fit the two TBS Antennas, etched parts 47, to the front of the mast top platform as shown, angling the two arms of the fore mast antenna forward. Fit the two side Yardarms, etched parts 59, so that the upper horizontal yard locates against the top rear corner of the mast.

Make a Pole Mast Top Gallant from 0.5mm Brass Rod to 30mm in length. Fit the top array, etched part 19 into place as shown above. Fit the top pole into the recesses formed at the rear of the two mast platforms. Fold down the sides of the Radar Mounting Base, etched part 53, and fit to the forward area of the mast top platform as shown. Cut a length of 2mm diameter Plastic Rod and fit into the hole in the top of the radar base. Fit the 293P Radar antenna into place.

Fit the two Weather Vanes, etched parts 37, to the forward corners of the mast, between the third and fourth horizontal bars down from the top. Fit the Headache Aerial, etched part 10, to the port aft corner of the mast, between the second and third horizontal bar down from the top.

Fo'c'sle Deck and Forward Superstructure Fittings

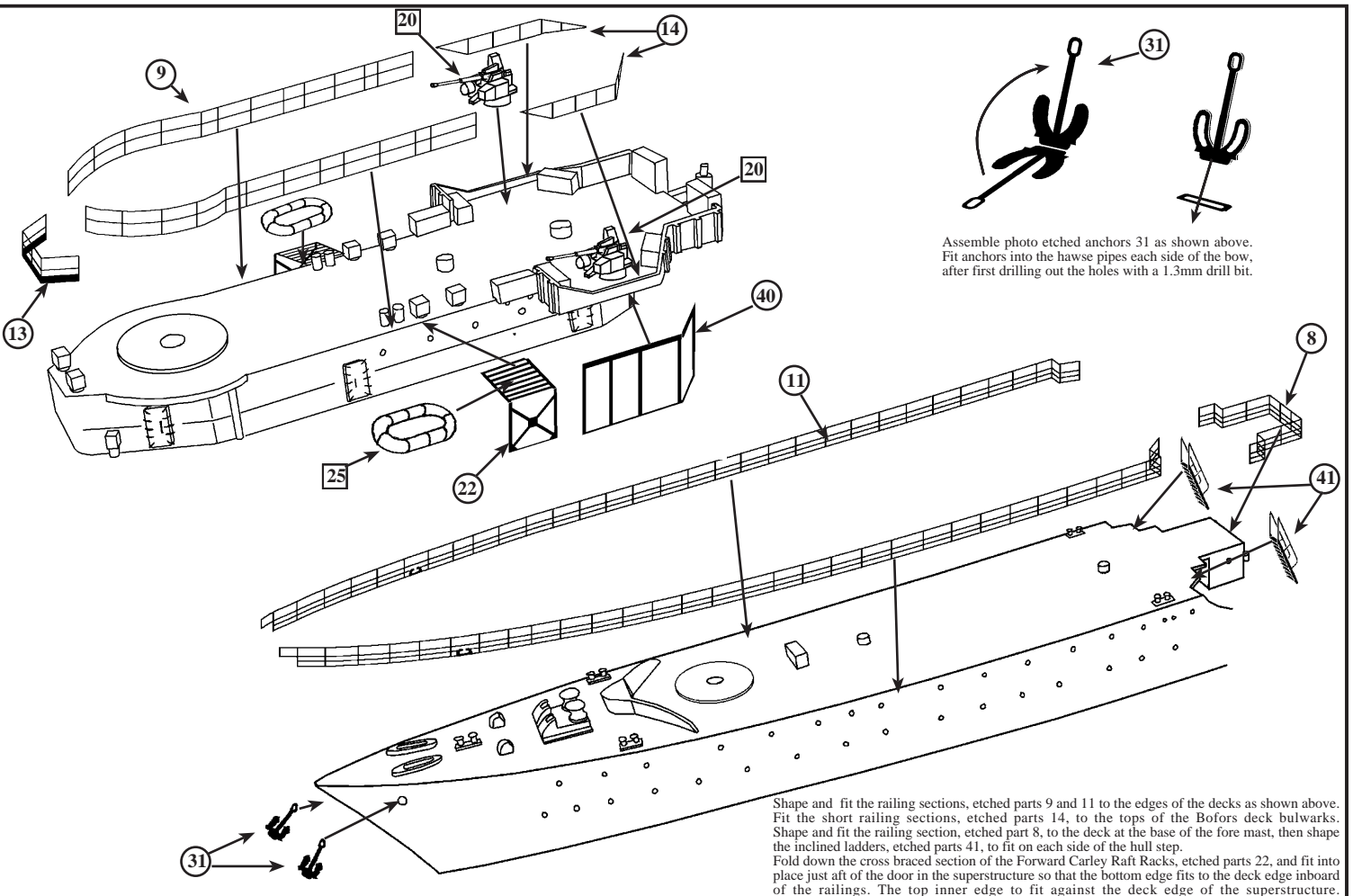

Assemble photo etched anchors 31 as shown above. Fit anchors into the hawse pipes each side of the bow, after first drilling out the holes with a 1.3mm drill bit.

Shape and fit the railing sections, etched parts 9 and 11 to the edges of the decks as shown above. Fit the short railing sections, etched parts 14, to the tops of the Bofors deck bulwarks. Shape and fit the railing section, etched part 8, to the deck at the base of the fore mast, then shape the inclined ladders, etched parts 41, to fit on each side of the hull step. Fold down the cross braced section of the Forward Carley Raft Racks, etched parts 22, and fit into place just aft of the door in the superstructure so that the bottom edge fits to the deck edge inboard of the railings. The top inner edge to fit against the deck edge of the superstructure.

Middle Gun Deck Fittings

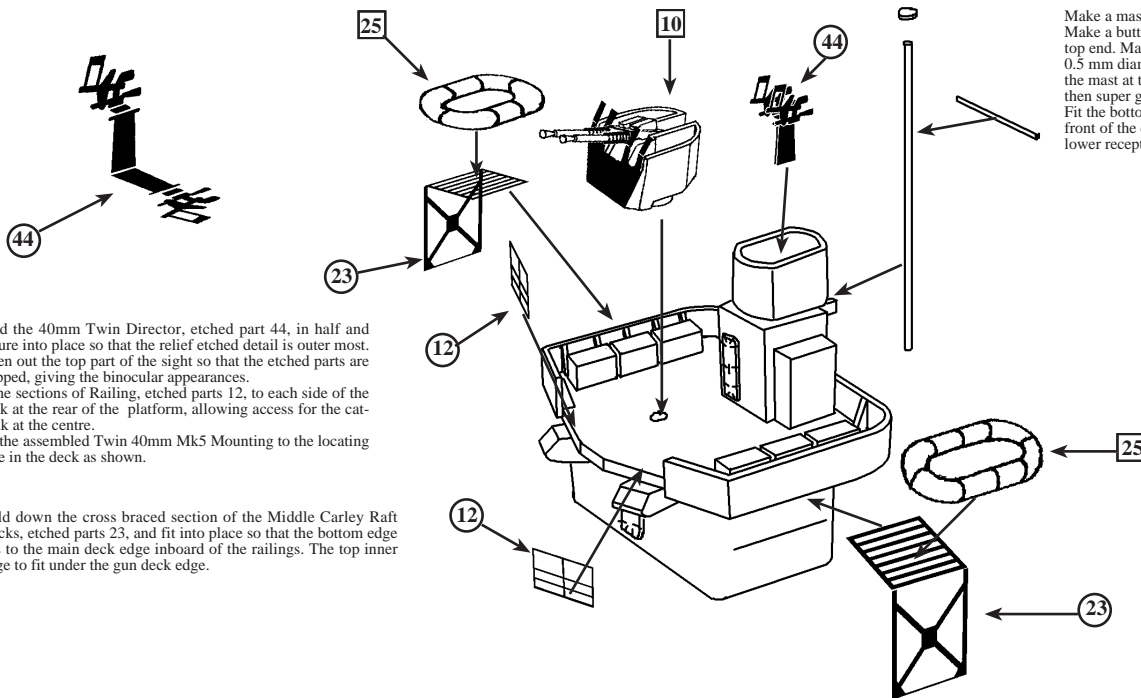

Make a mast from a 28mm length of 0.75mm brass rod. Make a button from a disc of plastic card fitted to the top end. Make a small yard arm from a 15mm length of 0.5 mm diameter brass rod. File a notch in the front of the mast at the point where the yardarm is to locate and then super glue the yardarm into place centrally. Fit the bottom of the mast into the two receptacles on the front of the deck house, with the base of the mast in the lower receptacle.

Fold the 40mm Twin Director, etched part 44, in half and secure into place so that the relief etched detail is outer most. Open out the top part of the sight so that the etched parts are stepped, giving the binocular appearances. Fit the sections of Railing, etched parts 12, to each side of the deck at the rear of the platform, allowing access for the catwalk at the centre. Fit the assembled Twin 40mm Mk5 Mounting to the locating hole in the deck as shown.

Fold down the cross braced section of the Middle Carley Raft Racks, etched parts 23, and fit into place so that the bottom edge fits to the main deck edge inboard of the railings. The top inner edge to fit under the gun deck edge.

Aft Superstructure Fittings

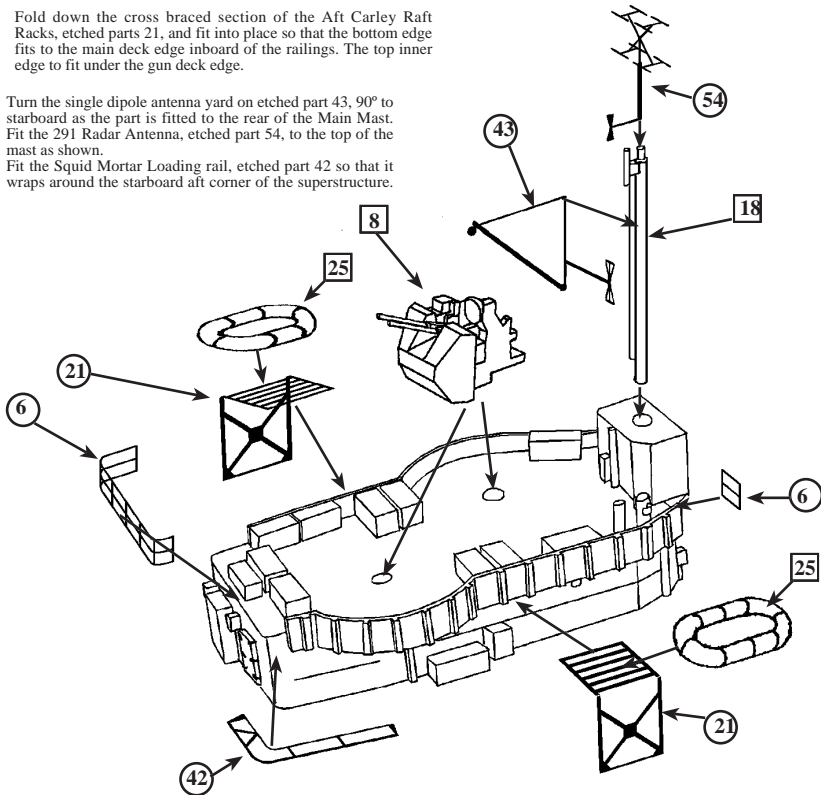

Fold down the cross braced section of the Aft Carley Raft Racks, etched parts 21, and fit into place so that the bottom edge fits to the main deck edge inboard of the railings. The top inner edge to fit under the gun deck edge.

Turn the single dipole antenna yard on etched part 43, 90° to starboard as the part is fitted to the rear of the Main Mast. Fit the 291 Radar Antenna, etched part 54, to the top of the mast as shown. Fit the Squid Mortar Loading rail, etched part 42 so that it wraps around the starboard aft corner of the superstructure.

Funnel and Forward Gun Deck Fittings

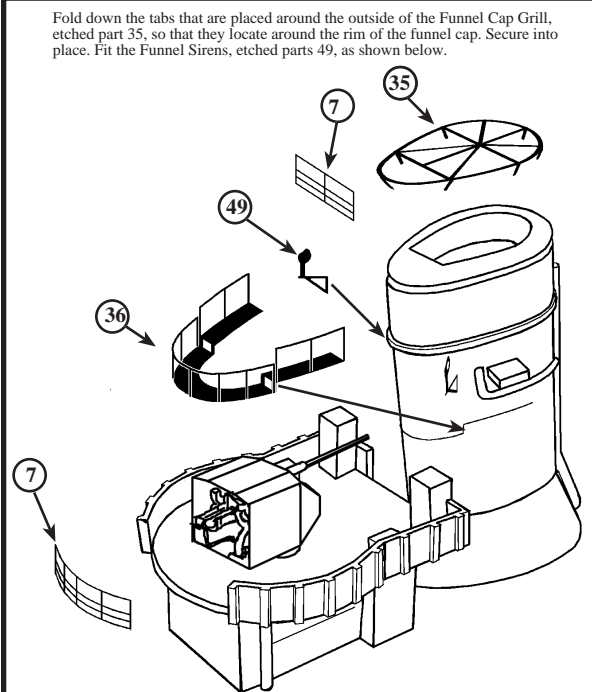

Fold down the tabs that are placed around the outside of the Funnel Cap Grill, etched part 35, so that they locate around the rim of the funnel cap. Secure into place. Fit the Funnel Sirens, etched parts 49, as shown below.

Shape and fit the Funnel Siren Access Platform, etched part 36 as shown above. Fit the Railings sections, etched parts 7, to the open edges of the forward gun platform.

Catwalk Locations

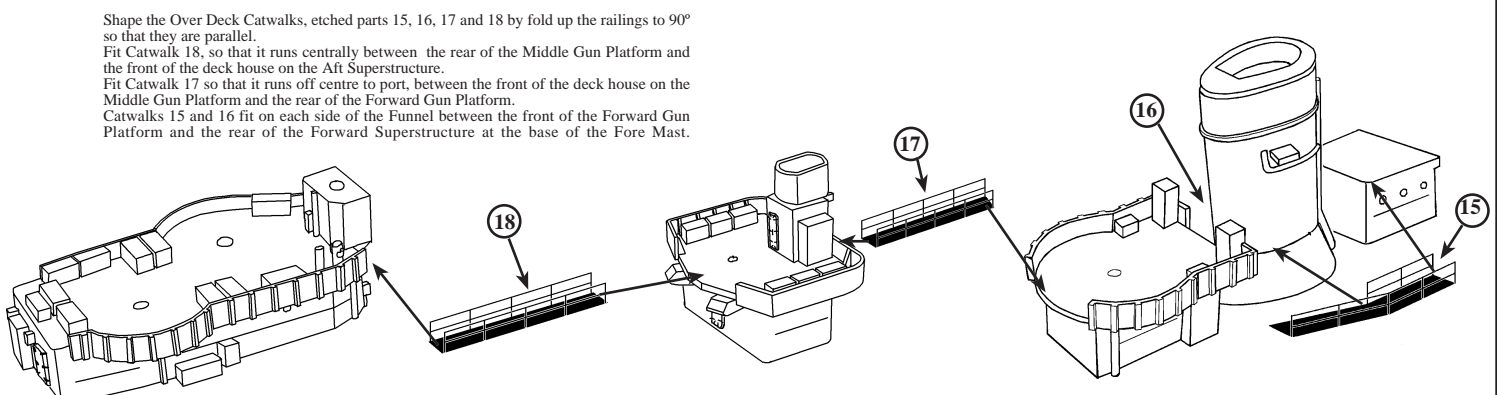

Shape the Over Deck Catwalks, etched parts 15, 16, 17 and 18 by fold up the railings to 90° so that they are parallel.

Fit Catwalk 18, so that it runs centrally between the rear of the Middle Gun Platform and the front of the deck house on the Aft Superstructure.

Fit Catwalk 17 so that it runs off centre to port, between the front of the deck house on the Middle Gun Platform and the rear of the Forward Gun Platform.

Catwalks 15 and 16 fit on each side of the Funnel between the front of the Forward Gun Platform and the rear of the Forward Superstructure at the base of the Fore Mast.

Main Deck and Quarterdeck Fittings

Fold and assemble the Depressor Paravane Platform, etched parts 45as shown below.

Fold the Torpedo Loading Davits, etched parts 58 in half so that they are double thickness. Fit to the tops of the cast on posts on the main deck.

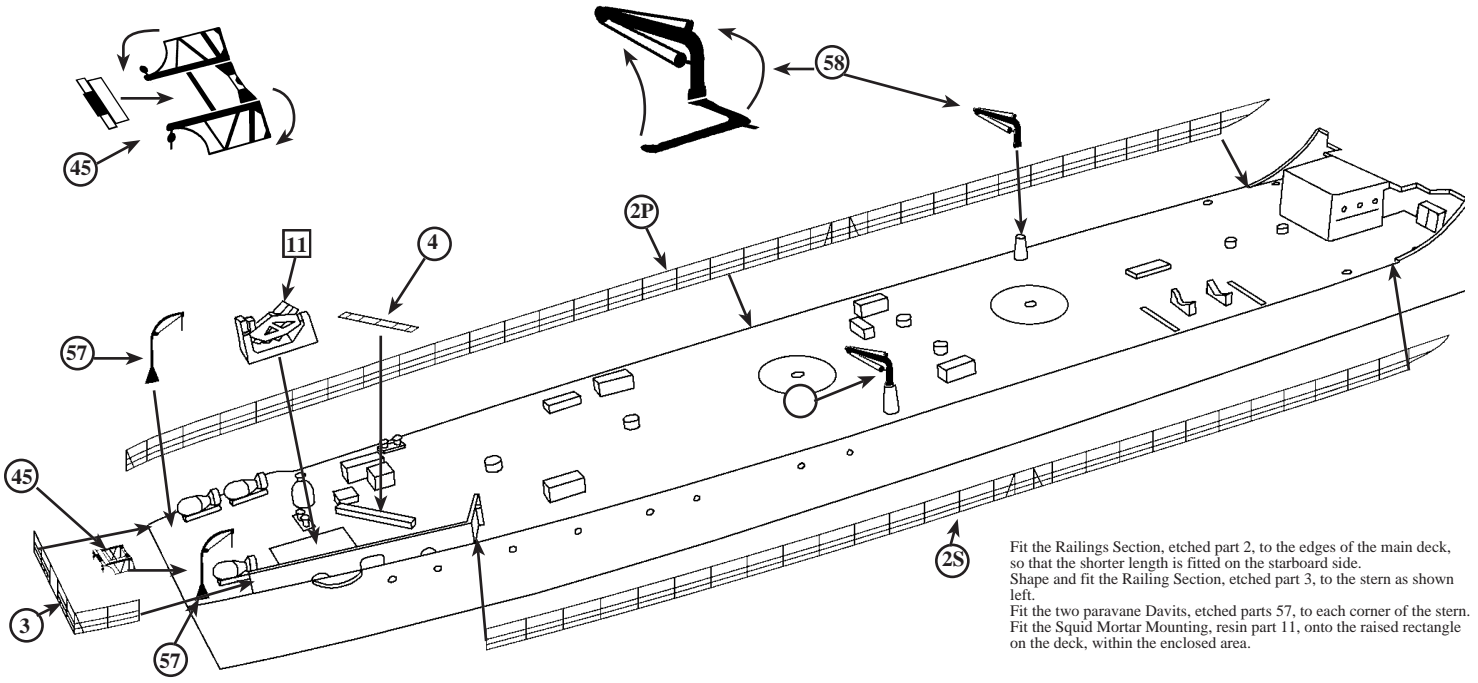

Fit the Railings Section, etched part 2, to the edges of the main deck, so that the shorter length is fitted on the starboard side. Shape and fit the Railing Section, etched part 3, to the stern as shown left.
Fit the two paravane Davits, etched parts 57, to each corner of the stern. Fit the Squid Mortar Mounting, resin part 11, onto the raised rectangle on the deck, within the enclosed area.

Ships Boats Location and Fittings

To assemble the davits, fold each one along the etched line at the base of the davit, so that the two sides meet and are secured in place with super glue. Ensure that the etched detail is facing outward.

Assemble the etched parts 56, to the Motor Cutters. Resin parts 23, then fit into place on the forward davits.

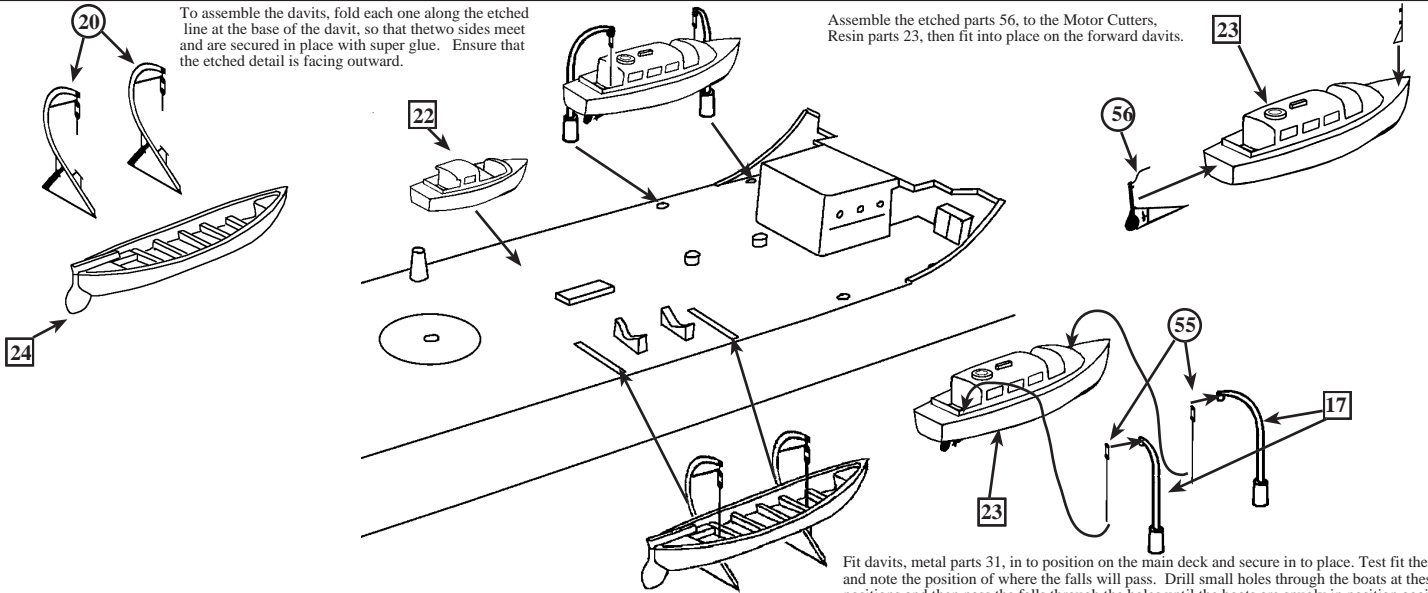

Fit davits, metal parts 31, in to position on the main deck and secure in to place. Test fit the boats and note the position of where the falls will pass. Drill small holes through the boats at these positions and then pass the falls through the holes until the boats are snugly in position against the davits. Secure in to place.

Propeller and Rudder Fitting

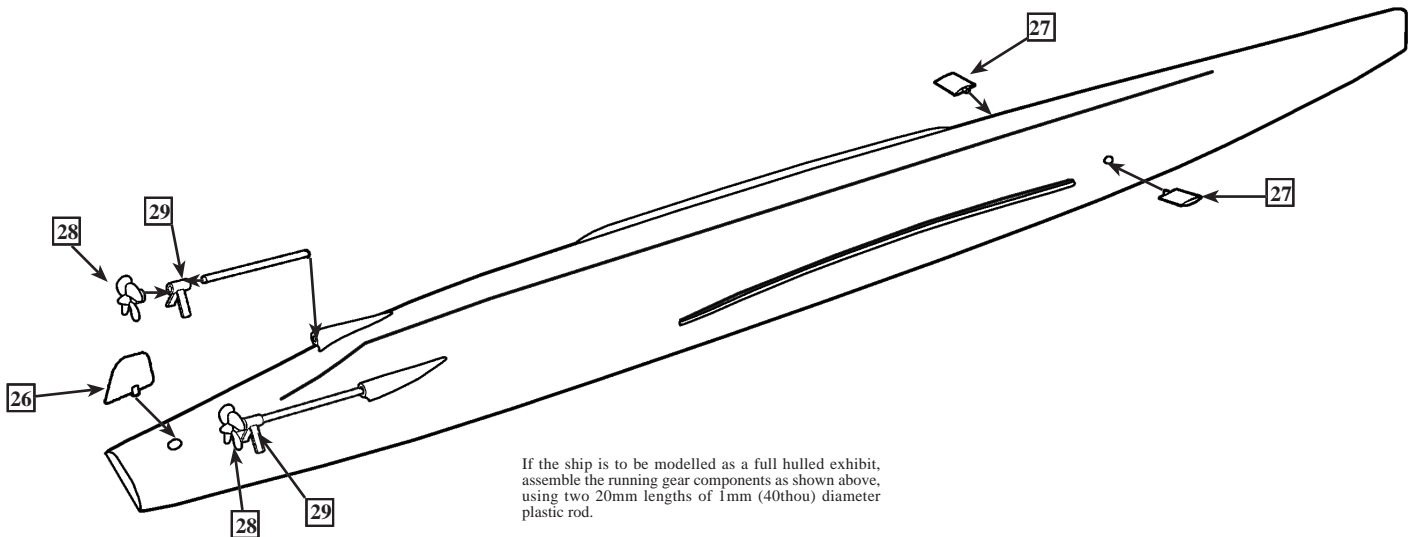

If the ship is to be modelled as a full hulled exhibit, assemble the running gear components as shown above, using two 20mm lengths of 1mm (40thou) diameter plastic rod.

Colour Chart and Painting Guide



Light Admiralty Grey
Humbrol 127



Deck Steel Grey
Humbrol 27



Anti Fouling Red
Humbrol 100

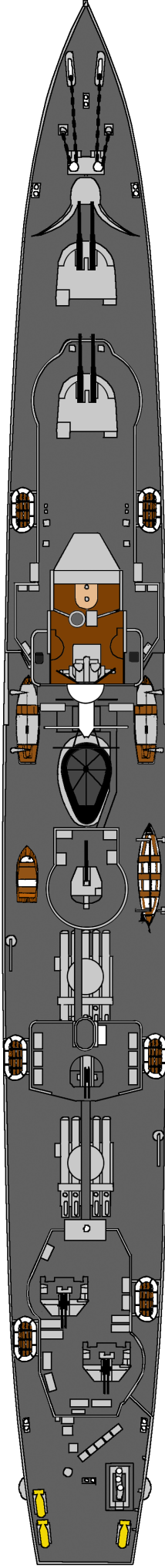
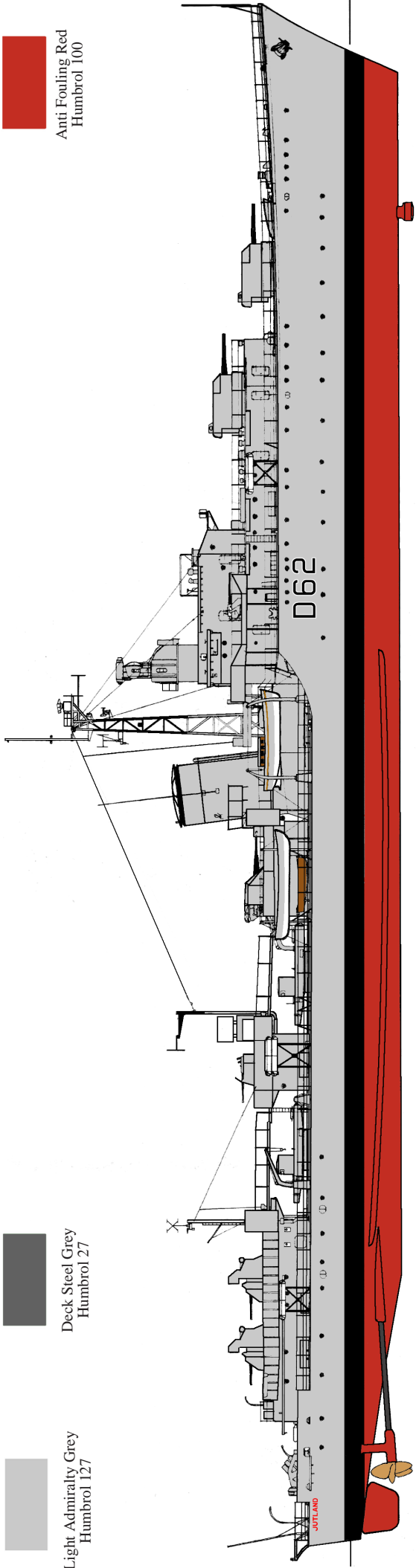

All colours quoted are from the Humbrol range of authentic colours for ease of purchase.

Other colours used

Matt Black 33

Fore Mast up to the third horizontal up, to the first horizontal below the top platform.
Gun Barrels, Waterline Boot Topping, Funnel Cap and Grill.

Matt White 34

Fore Mast Top and Yardarms from the third horizontal from the top platform.
Bollards and Fairleads, Capstans and Deck Fittings, Ships Boats below waterline
Carley Rafts.

Bronze 55.

Propellers

LA Grey 127

All Vertical Surfaces on hull and Superstructure Ships Boats above waterline.

Natural Wood 110

Boat Thwarts and Deck. Inside Grating on Carley Rafts

Linoleum 186

Bridge and Signal Deck



Stern Transom Decal Location