

History

HMS Kelly was laid down on 26th August 1937 at Hawthorn Leslie Shipbuilders on Tyneside and launched on 25th October 1938.

Kelly became the ship of Captain (D) Lord Louis Mountbatten in August 1939 and was preparing to serve in the Mediterranean when hostilities broke out. Kelly and the 5th Flotilla served in Home and Northern waters to start with, and in late Autumn 1939 Kelly was damaged at the stern by a magnetic mine, for which she had to be towed back to the builders yard for repairs until February 1940.

In May 1940 Kelly was hit by a torpedo in No1 boiler room, which caused flooding in both boiler rooms and nearly resulted in the loss of the ship. But once again she was successfully towed back to the Tyne for repairs which took until the following December.

Kelly and the rest of the 5th Flotilla were finally deployed to the Mediterranean in late April 1941 and took up escort duties there. The Kelly became involved in the Battle of Crete in May 1941, then on the morning of the 22nd after carrying out shore bombardments with Kashmir, she was caught by a squadron of JU87 dive bombers 13 miles south of Gavdo. Kashmir was hit and sunk first. Kelly was then hit just aft of the engine room whilst turning at speed. She capsized and sank after 30 minutes.

Specifications

Length: 356ft 6ins oa. Beam: 35ft 8ins Displacement: 1965 tons standard 2330 tons deep. Speed: 33 knots

Armament: 6 x 4.7inch guns in three twin HA/LA mountings. 5 x 21 inch Torpedoes in one quintuple tubed mounting. 30 Depth Charges fired from 1 x Mk 1 depth charge rail and 2 x Mk 11 depth charge throwers. 1 x 4 barrelled 2 pounder Pom Pom. 1 x 4" HA AA Mounting. 4 x 20mm Oerlikon.

Equipment: 1 x 44 inch Searchlight projector on platform between torpedo tubes. 2 x 20inch signal projectors.

Resin and Metal Parts Identification

1. Carley Rafts x 8	2. 4 Barrelled Pom Pom	3. 4 Barrelled Pom Pom Base	4. Depth Charges Reloads x 6	5. Depth Charge Throwers x 2	6. 4" HA AA Gun Mounting	7. Propeller x 1pair	8. Prop Shaft 'A' Frame x 2	9. 4.7" Twin Gun Barrels	10. 4.7" Twin Gun Mounting	11. 40" Searchlight Projector	12. Director Control Tower (DCT)	13. 14' Fast Motor Dinghy	14. 27' Naval Whaler	15. 25' Fast Motor Boat	16. 25' Admiralty Motor Cutter	17. Forward Torpedo Tube Mounting	18. HA Director Tower	19. Pom Pom Platform	20. Foremast Pole
---------------------	------------------------	-----------------------------	------------------------------	------------------------------	--------------------------	----------------------	-----------------------------	--------------------------	----------------------------	-------------------------------	----------------------------------	---------------------------	----------------------	-------------------------	--------------------------------	-----------------------------------	-----------------------	----------------------	-------------------

The major parts are not included on this list, but come as one of each of the following.
Upper Hull, Lower Hull, Bridge Superstructure, Funnel, Aft Superstructure and Deck Plate.
The Main Superstructure may be a separate part or may be supplied already attached to the upper hull.

This kit contains a mixture of resin and white metal small parts, of which some of the resin parts have been attached to sprues for ease of casting.

Care must be taken when detaching the parts from the sprues, to remove the flash without causing damage.

When cleaning off the excess material using files or abrasive paper, it is recommended that a mask is worn as resin dust can be harmful to health if inhaled.

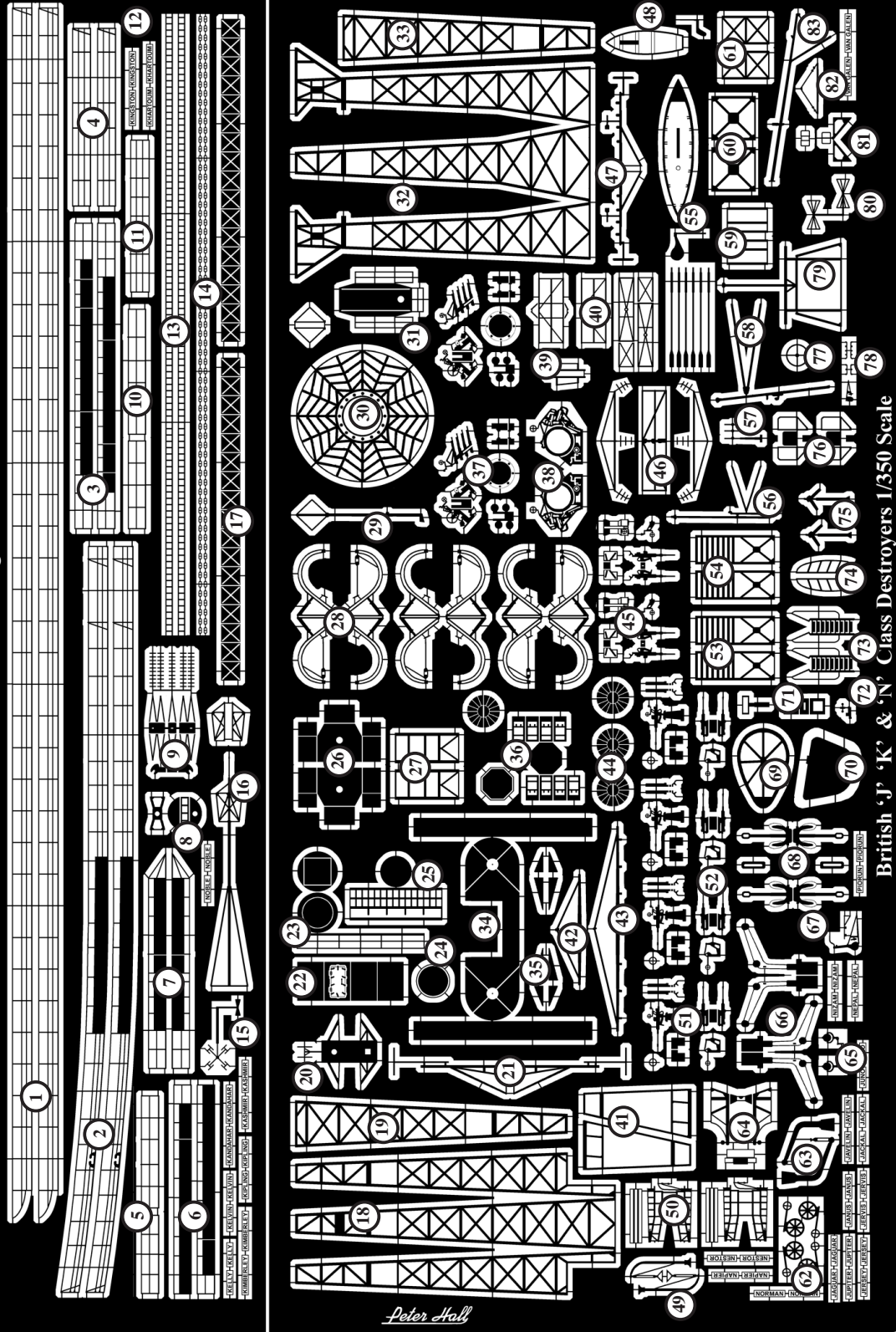

- | | | | | |
|--------------------------------------|----------------------------------|------------------------------------|---------------------------------------|-------------------------------------|
| 1. Railings (Main Deck) | 29. Foremast Top DF Antenna | 43. Tripod Foremast Lower Yard | 57. Radar Lantern Top Antenna | 71. 276 Radar Antenna |
| 2. Railings (Foccle) | 30. 4" AA Gun Foot Plate | 44. 20mm Oerlikon Footplates | 58. Ensign Staff | 72. Anemometer Vane |
| 3. Railings (X Gun Deck Leader) | 31. Lattice Mast Top Platform | 45. Twin 20mm Oerlikons | 59. Fwd AA gun Platform Supports | 73. Inclined Ladders (Hull Step) |
| 4. Railings (Amidships AA Platform) | 32. Lattice Mast (Kelvin) | 46. 286 Radar Antenna Type 2 | 60. Mid AA Platform Supports (Type 1) | 74. A Gun Training Stops |
| 5. Railings (X Gun Deck Fwd) | 33. Lattice mast Front Frame | 47. Lattice Mast Yardarms | 61. Mid AA Platform Supports (Type 2) | 75. Bridge Semaphores |
| 6. Railings (X Gun Deck) | 34. Mid AA Platform (Jervis) | 48. 14' Dinghy Thwarts and Rudder | 62. TSDDS Winch Drum Wheels | 76. Funnel Siren Platforms |
| 7. Railings (B Gun Deck) | 35. Lattice Mast Yardarms | 49. Depth Charge Davits | 63. Torpedo Loading Davits | 77. Searchlight Lens Cross |
| 8. 293 Radar Antenna | 36. Radar Lantern House | 50. Depth Charge Rails | 64. TSDDS Stern Gantry | 78. 25' Fast Motor Boat Parts |
| 9. 285 Radar Yagi Antenna | 37. Radar Lantern Platform | 51. Single 20mm Oerlikon Mountings | 65. Signal Lamps | 79. Main Mast Wire Antenna Spreader |
| 10. Railings (X Gun Deck Fwd Leader) | 38. Quad Pom Pom Side Plates | 52. Twin 20mm Powered Mountings | 66. TSDDS Davits | 80. Fore Mast Top ECM Antenna |
| 11. Railings (Searchlight Platform) | 39. Headache Antennas | 53. Carley Raft Racks (Forward) | 67. Adm Motor Cutter Parts | 81. Bridge Front DF Antenna |
| 12. Ships Name Plates | 40. 286 Radar Antenna Type 1 | 54. Carley Raft Rack (Mid) | 68. Anchor Assemblies | 82. Main Mast Pole Yard |
| 13. Vertical Ladder Stock | 41. Tripod Fore Mast Leg Spacers | 55. 27' Whale Thwarts and Oars | 69. Funnel Cap Grill | 83. Pole Main Mast |
| 14. Anchor Chain | 42. Tripod Fore Mast Upper Yard | 56. Jack Staff | 70. Rudder | |

Major Parts Location Diagram

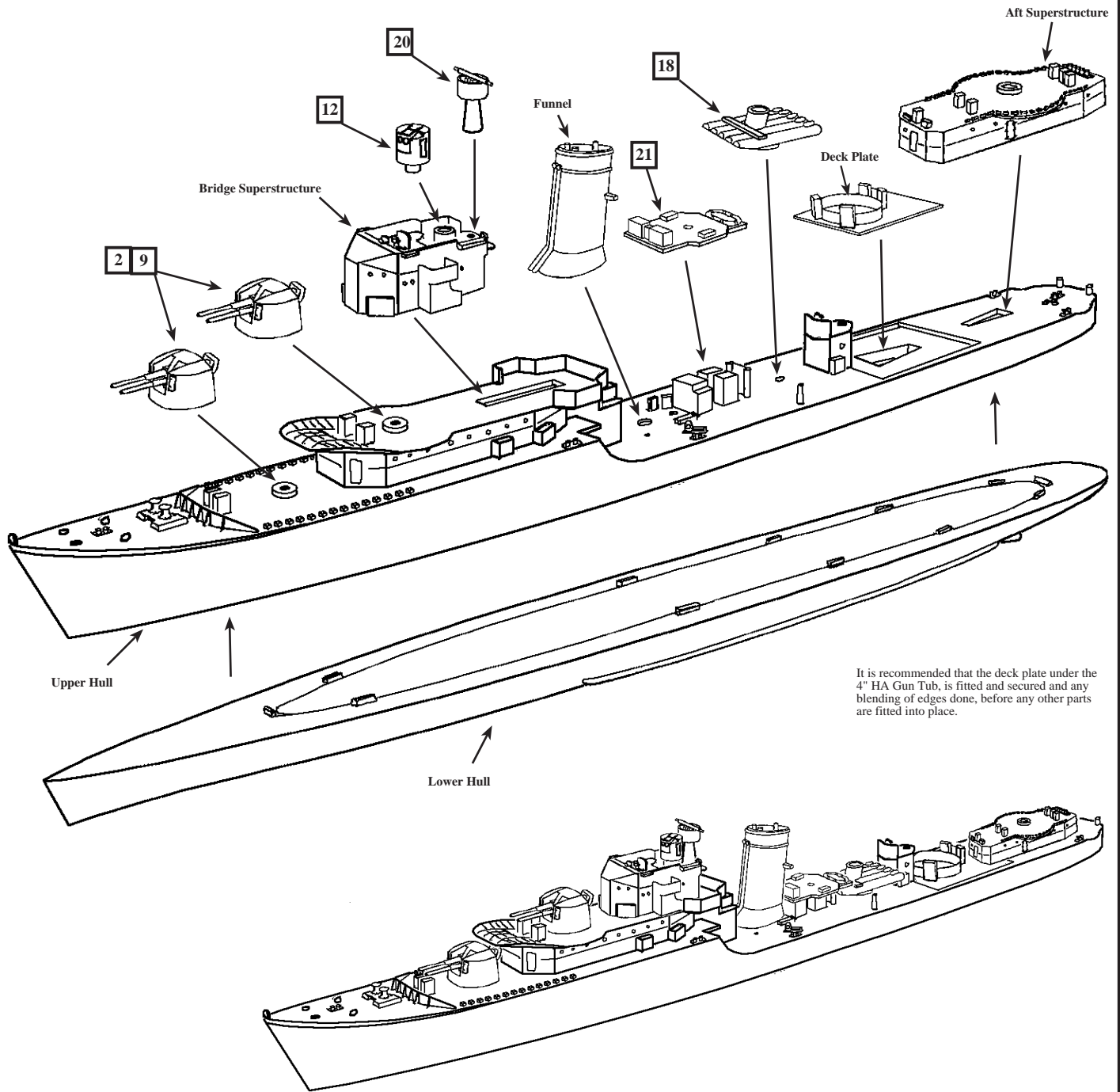

20mm Oerlikon

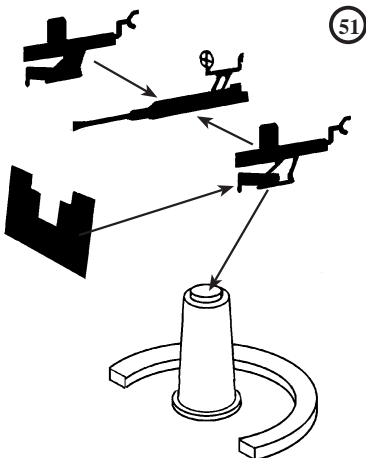

Assemble the 20mm Oerlikon mounting as shown above. Locate these into positions on either side of the lower signal platforms and on the special platforms each side of the searchlight platform.

4 Barrelled Pom Pom Assembly

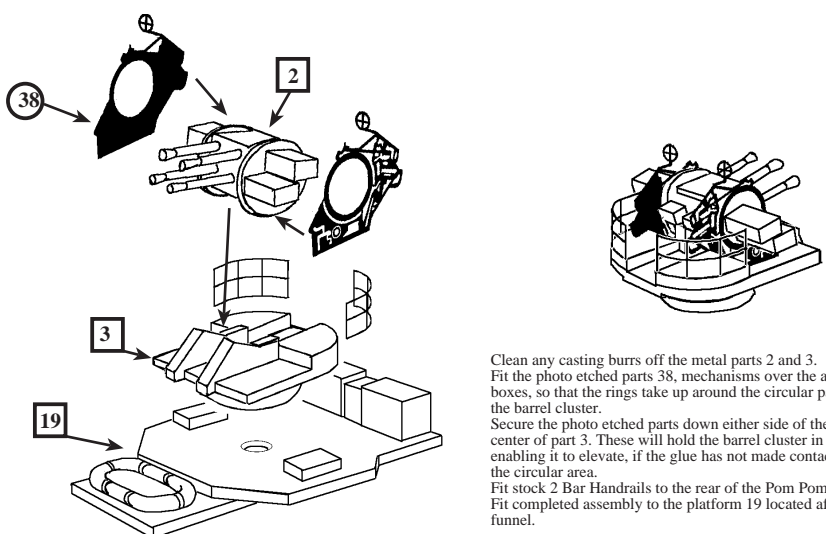

Clean any casting burrs off the metal parts 2 and 3. Fit the photo etched parts 38, mechanisms over the ammo boxes, so that the rings take up around the circular part of the barrel cluster. Secure the photo etched parts down either side of the angled center of part 3. These will hold the barrel cluster in place, enabling it to elevate, if the glue has not made contact with the circular area. Fit stock 2 Bar Handrails to the rear of the Pom Pom mounting. Fit completed assembly to the platform 19 located aft of the funnel.

4.7" Turret Assembly

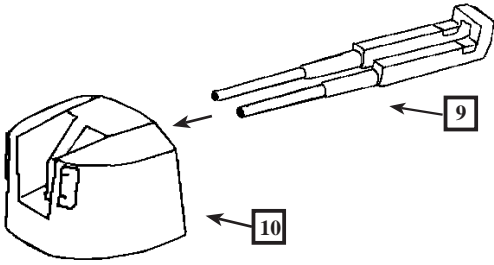

Fit the twin barrels in to the turret housing simply by pushing them through from the rear, ensuring the barrels pass either side of the centre pillar. Secure to the desired elevation before fitting to the decks. Make three items.

4" HA Anti Aircraft Gun Assembly

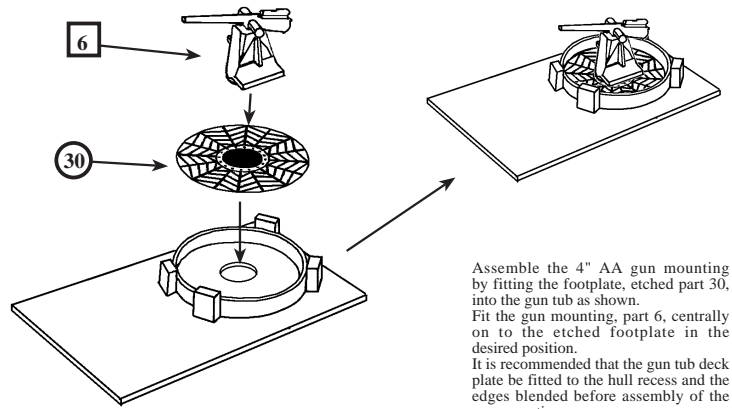

Assemble the 4" AA gun mounting by fitting the footplate, etched part 30, into the gun tub as shown. Fit the gun mounting, part 6, centrally on to the etched footplate in the desired position. It is recommended that the gun tub deck plate be fitted to the hull recess and the edges blended before assembly of the gun mounting.

Boats Assembly

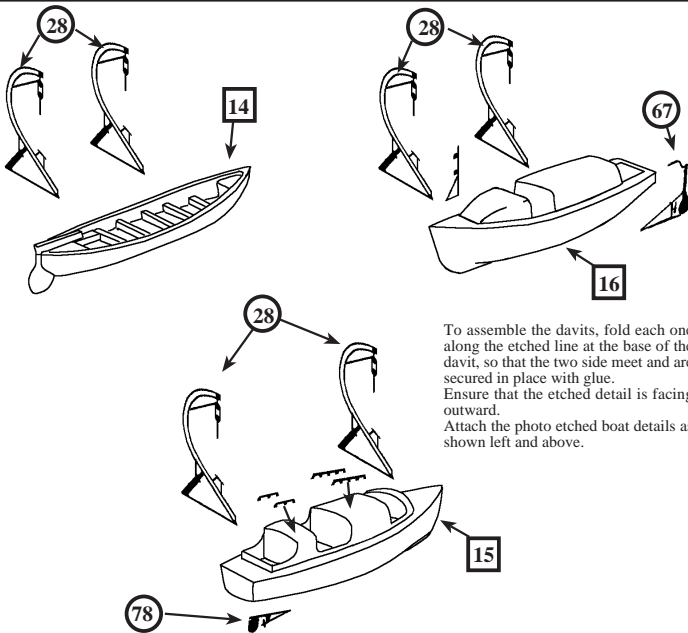

To assemble the davits, fold each one along the etched line at the base of the davit, so that the two side meet and are secured in place with glue. Ensure that the etched detail is facing outward. Attach the photo etched boat details as shown left and above.

Starboard Side Boat Location

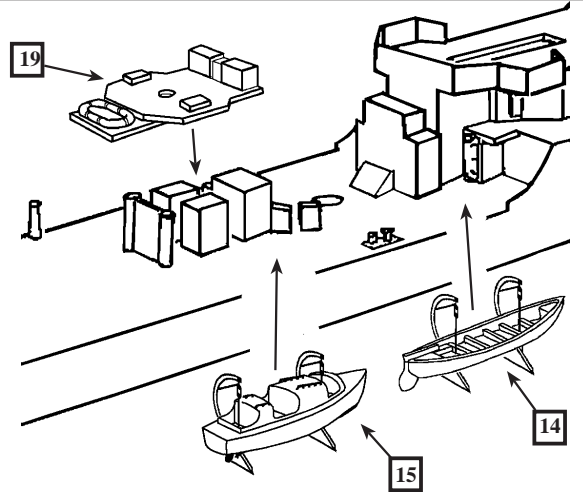

It may be easier for some, to fit the davits to the deck first, before fitting the boats. The positions of each davit is as follows. Fit each one parallel to the next along the edge of the deck. The first one being 9mm from the hull step, the second 23mm, the third 41mm and the fourth 55mm. Measure out these distances and mark with pencil to ensure an exact fit. The boats may now be fitted to the falls by drilling fine holes into the coach roof or attaching the falls to the thwarts or bulkheads as necessary.

Port Side Boat Location

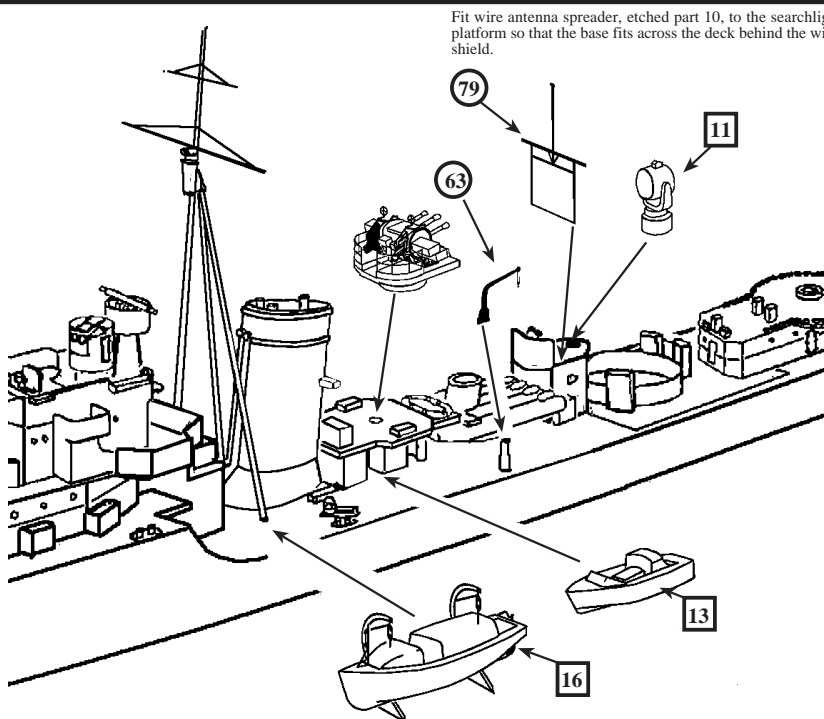

Fit wire antenna spreader, etched part 10, to the searchlight platform so that the base fits across the deck behind the wind shield.

If the davits are to be fitted to the deck before fitting the boat in place, measure and mark out 9mm from the hull step and 23mm. This is the position to fit the two davits on this side. The small motor dinghy is placed directly on to the deck along side the pom pom platform.

Bridge Wing Fittings

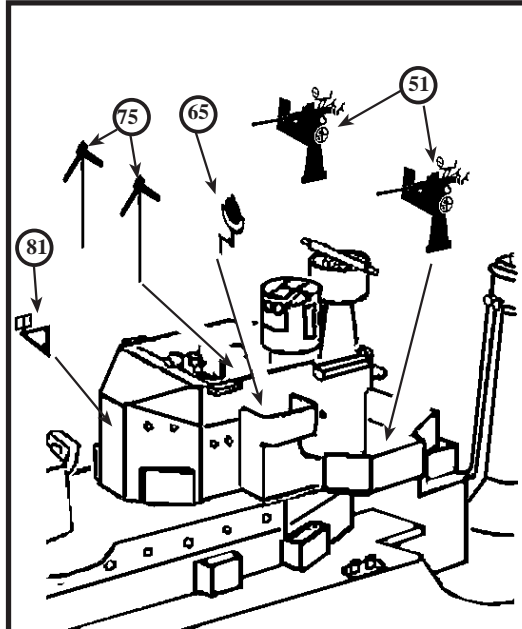

Fit the two 20mm Oerlikon assemblies into position on the bridge wing platforms. Fit the two signal lamps 65 to the bulwarks around the signal platforms. It may help to give depth to these lamps, by adding a piece of circular plastic rod to the back of the lamp itself. Fit the semaphores 75, to each side of the bridge as shown. Fit the DF, antenna etched part 81, centrally to the bridge front as shown.

Depth Charge Rails

Fold over the sides of the depth charge rails so that they are parallel. Fold the rail section so that there is an angle approx half way along that will match the rail on the sides of the frame. Fit rail section inside frame and secure in place.

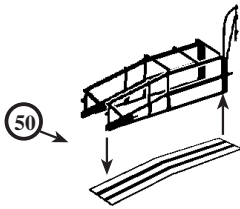

HF/DF Antenna

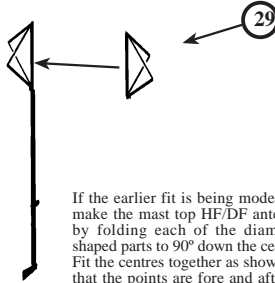

If the earlier fit is being modelled, make the mast top HF/DF antenna by folding each of the diamond shaped parts to 90° down the centre. Fit the centres together as shown so that the points are fore and aft and athwartships.

286 Radar Antenna

Assemble the 286 Radar Antenna as shown below, and secure to the mast top pole in the place of the upper yardarm, etched part 42. This part also replaces The HF/DF antenna etched part 29.

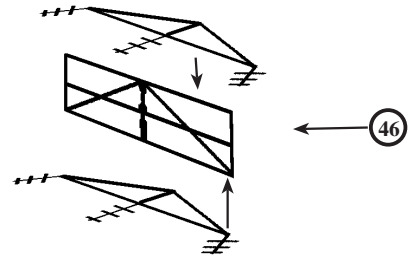

Stern Fittings Location

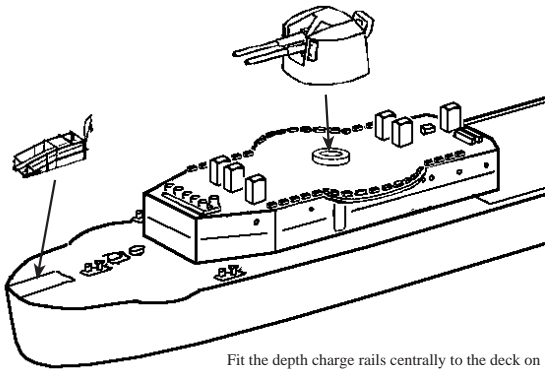

Fit the depth charge rails centrally to the deck on the stern as shown.

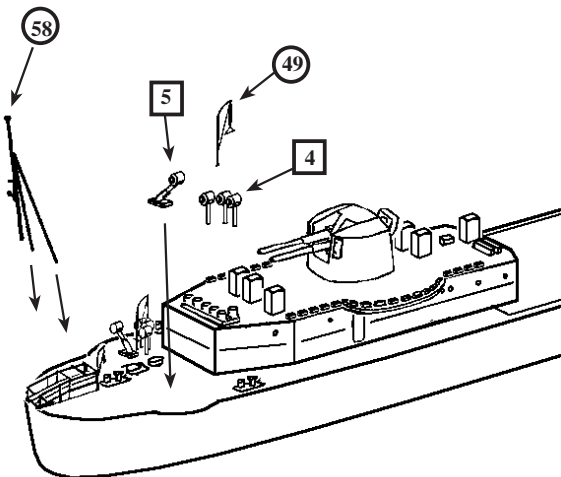

Fit the depth charge throwers, parts 5, so that they point outboard, one on each side. Fit the relays, parts 4, in clusters of three next to each thrower. Fit the etched davits 49, in place next to each depth charge thrower. To fit the ensign staff, etched part 58, the lower end of the main pole will need to be trimmed shorter, so that it can locate on the top of the depth charge rails.

Foremast Assembly

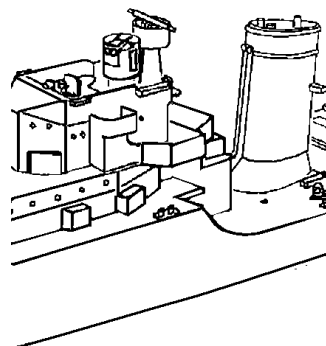
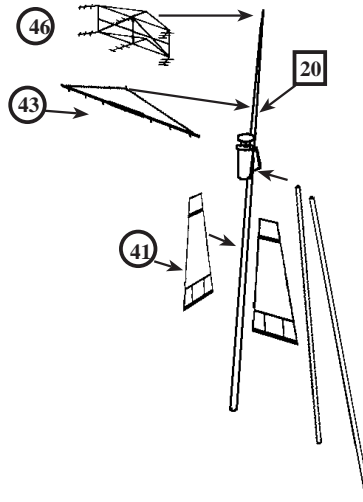

Assemble Foremast as shown above using the photo etched parts 41 and two 48mm lengths of 20thou (.5mm) diameter brass rods to make the tripod legs.

Funnel Fittings

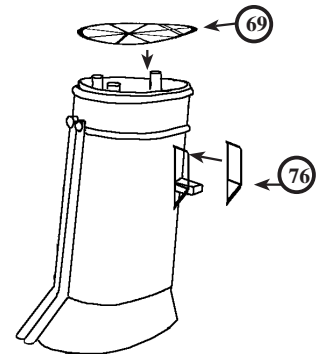

Fit Funnel Cap grill 26 as shown, ensuring that the pipework passes through the holes. Fit handrails to the sides of the funnel platforms in pairs. A section of vertical ladder may also be fitted from the main deck to the platform.

Anchor Assembly

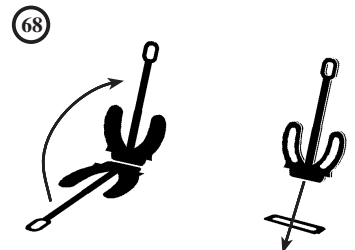

Assemble photo etched anchors 68 as shown above. Fit anchors into the hawse pipes each side of the bow, after first drilling out the holes with a 1.5mm drill bit.

Propeller and Rudder Fittings

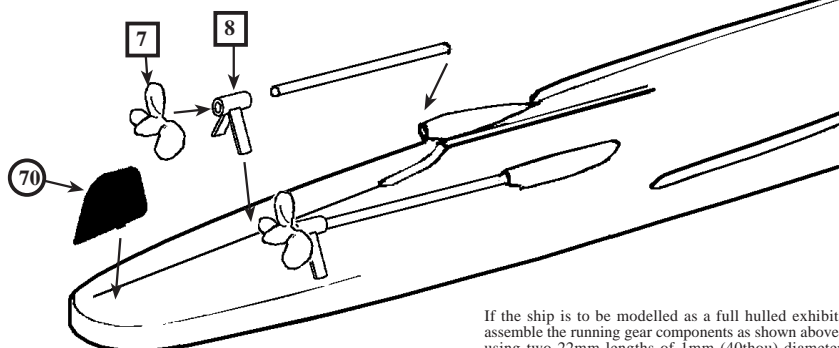

If the ship is to be modelled as a full hulled exhibit, assemble the running gear components as shown above, using two 22mm lengths of 1mm (40thou) diameter brass rod.

COLOUR CHART & PAINTING GUIDE

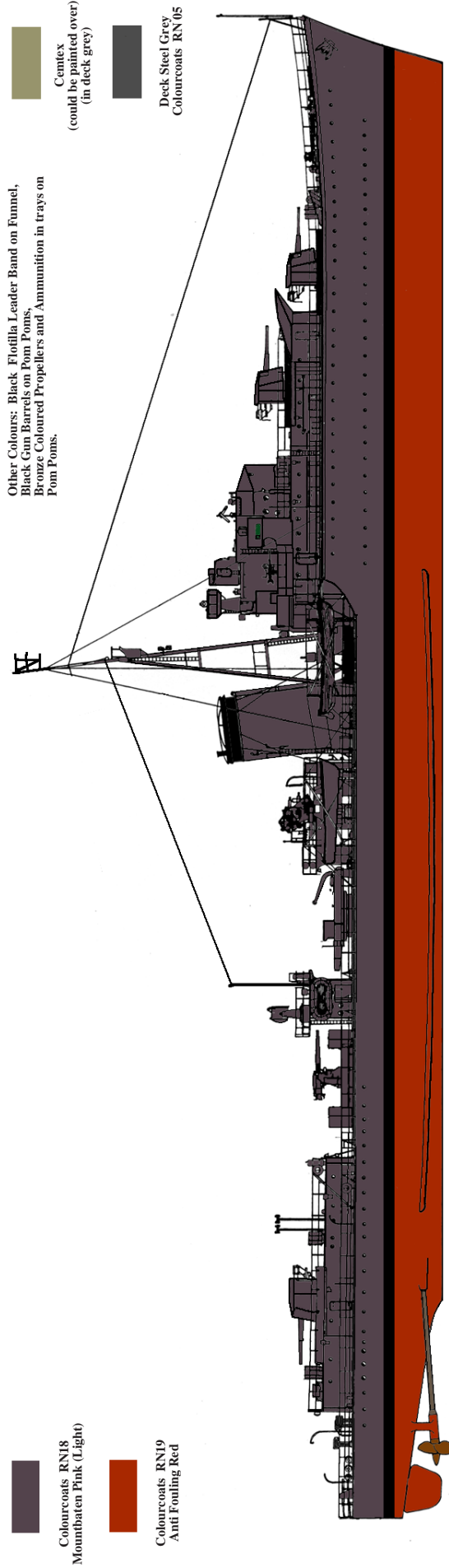

OTHER INSTRUCTIONS

1. The positions of the Carley Rafts have not been shown in the main assembly instructions, but can be seen clearly on the painting guide plan and profile above. The rafts were over painted in the colour and shape of the camouflage pattern against which they were positioned.
2. Safety Rails, etched parts 47, are for fitting on top of the fore and aft deckhouses adjacent to 'B' and 'X' turrets. These have enclosed sections of canvas dodgers that were fitted, to prevent empty shell cases from rolling off on to the deck below or even over the side. These sections are fitted against the deck.
3. Upswept Bow railing has been provided in the form of etched parts 49. Again these have canvas dodgers, that fit adjacent to 'A' Turret this time.
4. Ships name plates are provided in the form of etched parts 48. There are a pair of these with the name KELLY that are fitted to each side of the aft deck house. You will have noticed that name plates have also been provided for ship in the J,K and N classes.
5. Kelly may have been fitted with circular 20mm Oerlikon platforms on each side of the searchlight platform prior to departure to the Mediterranean. Unfortunately no plans have been found of these parts to date so they have been omitted. They be made if desired, but further research will be necessary.
6. You will notice that there are several extra parts and antennas provided on the photo etched detail set. This is to allow other ships of the class to be modelled at a later date or at the modellers discretion after further private research.
7. Inclined ladders are fitted on each side at the hull step, from the main deck to the fo'c's'le deck via the small platform that protrudes aft from the step. Vertical ladders are fitted on the port side of the bridge for access. On the forward bulkhead of the aft deck house for gun crew access. On the forward bulkhead of the searchlight platform. Up each side of the funnel to the small platforms. Up the foremast to the crow's nest