

'N' Class Fleet Destroyer ORP Piorun (HMS Noble) 1944

Resin & Photo Etched Metal Kit in 1/350 scale

History

Laid down on 25th July 1939 at John Browns Shipbuilding and Engineering Company, Clydebank, Scotland, she was built and launched on 7th May 1940 as HMS Nerissa.

When she was completed, she was handed over to the Polish Navy and commissioned on 4th November 1940 as the ORP PIORUN. With Cdr Plawski in command, Piorun's first few months were spent with the 7th Flotilla and was involved with the search for the Scharnhorst and Gneisenau.

Later in May 1941 whilst attached to the 4th Flotilla under Captain Vian in the Cossack, orders were given to seek out and chase the German Battleship Bismarck after it had broken out into the Atlantic and sunk the pride of the Royal Navy, HMS Hood. Due to bad weather, Piorun lost contact with the rest of the Flotilla, but found the Bismarck and engaged with her 4.7 inch guns. Several hits were scored and the ships traded shots for 59 minutes, with Piorun transmitting radio reports until the Flotilla arrived. A torpedo attack was then carried out by the Flotilla which was unsuccessful. Piorun was then ordered to return to Plymouth as she was low on fuel, and played no further part in that action.

Throughout 1942 Piorun was involved in the escorting of the North Atlantic convoys, during which she located and gave chase to several U Boats. 1943 She was transferred to the Mediterranean for the Malta convoys and the landings on Sicily. Piorun was transferred back to the Home Fleet in 1944 for the D Day landings at Normandy and she served at home until the end of the war. In 1946 Piorun was handed back to Britain and commissioned in to the Royal Navy as HMS Noble. Eventually decommissioned and scrapped at Dunston in December 1955.

Specifications

Length: 356ft 6ins oa. Beam: 35ft 8ins Displacement: 1965 tons standard 2330 tons deep. Speed: 33 knots

Armament: 6 x 4.7inch guns in three twin HA/LA mountings. 5 x 21 inch Torpedoes in one quintuple tubed mounting. 45 Depth Charges fired from 1 x Mk 1 depth charge rail and 2 x Mk 11 depth charge throwers. 1 x 4 barrelled 2 pounder Pom Pom. 1 x 4" HA AA Mounting. 4 x 20mm Oerlikon Mk 5 Powered Mountings. 2 x 20mm Oerlikons on single mountings

Equipment: 1 x 44 inch Searchlight projector on platform aft of torpedo tubes, later replaced with a 271 Radar Lantern. 2 x 20inch signal projectors.

Resin and Metal Parts Identification

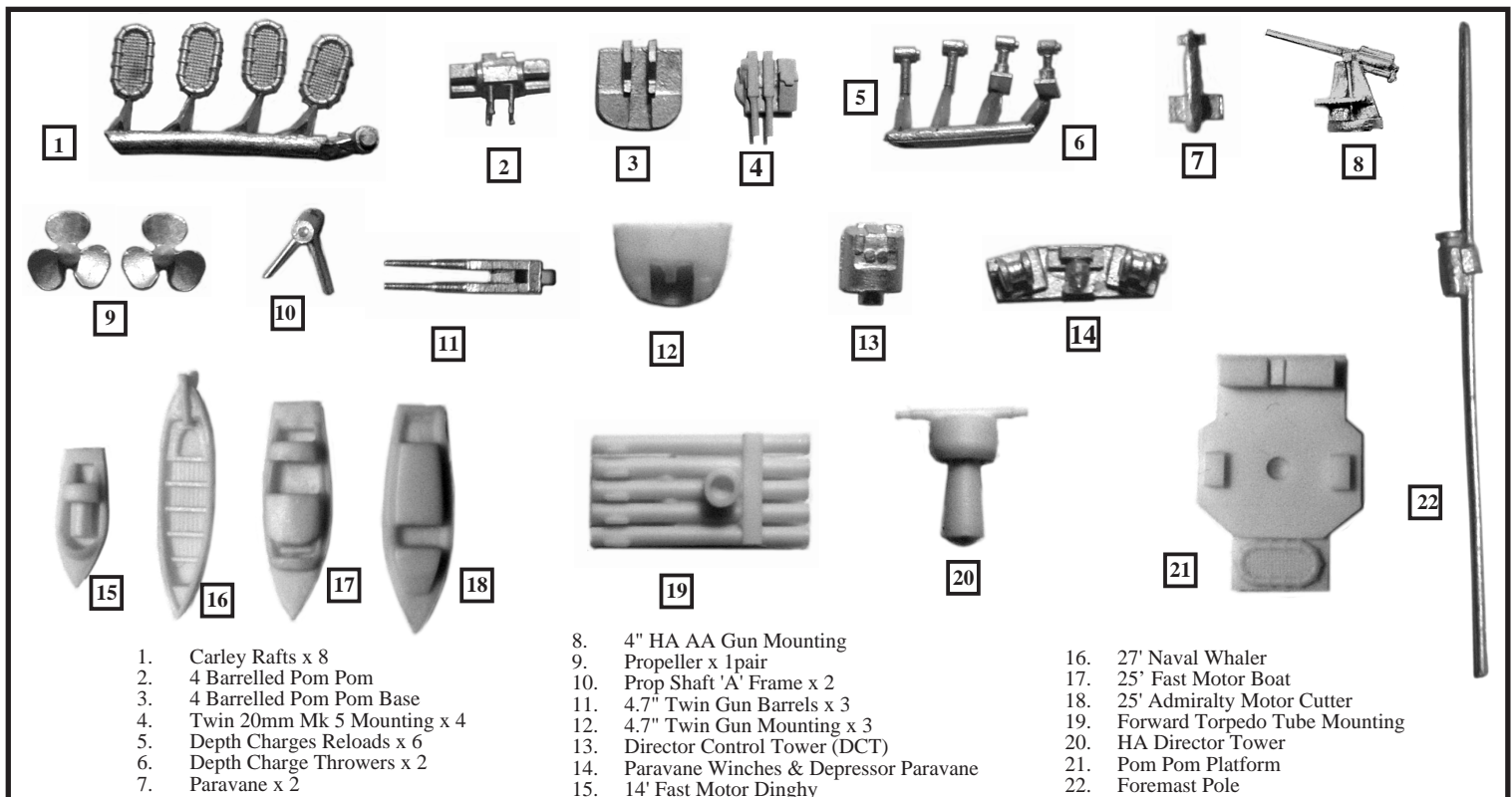

The major parts are not included on this list, but come as one of each of the following.
Upper Hull, Lower Hull, Bridge Superstructure, Funnel, Aft Superstructure and Deck Plate.
The Main Superstructure may be a separate part or may be supplied already attached to the upper hull.

This kit contains a mixture of resin and white metal small parts, of which some of the resin parts have been attached to sprues for ease of casting.

Care must be taken when detaching the parts from the sprues, to remove the flash without causing damage.

When cleaning off the excess material using files or abrasive paper, it is recommended that a mask is worn as resin dust can be harmful to health if inhaled.

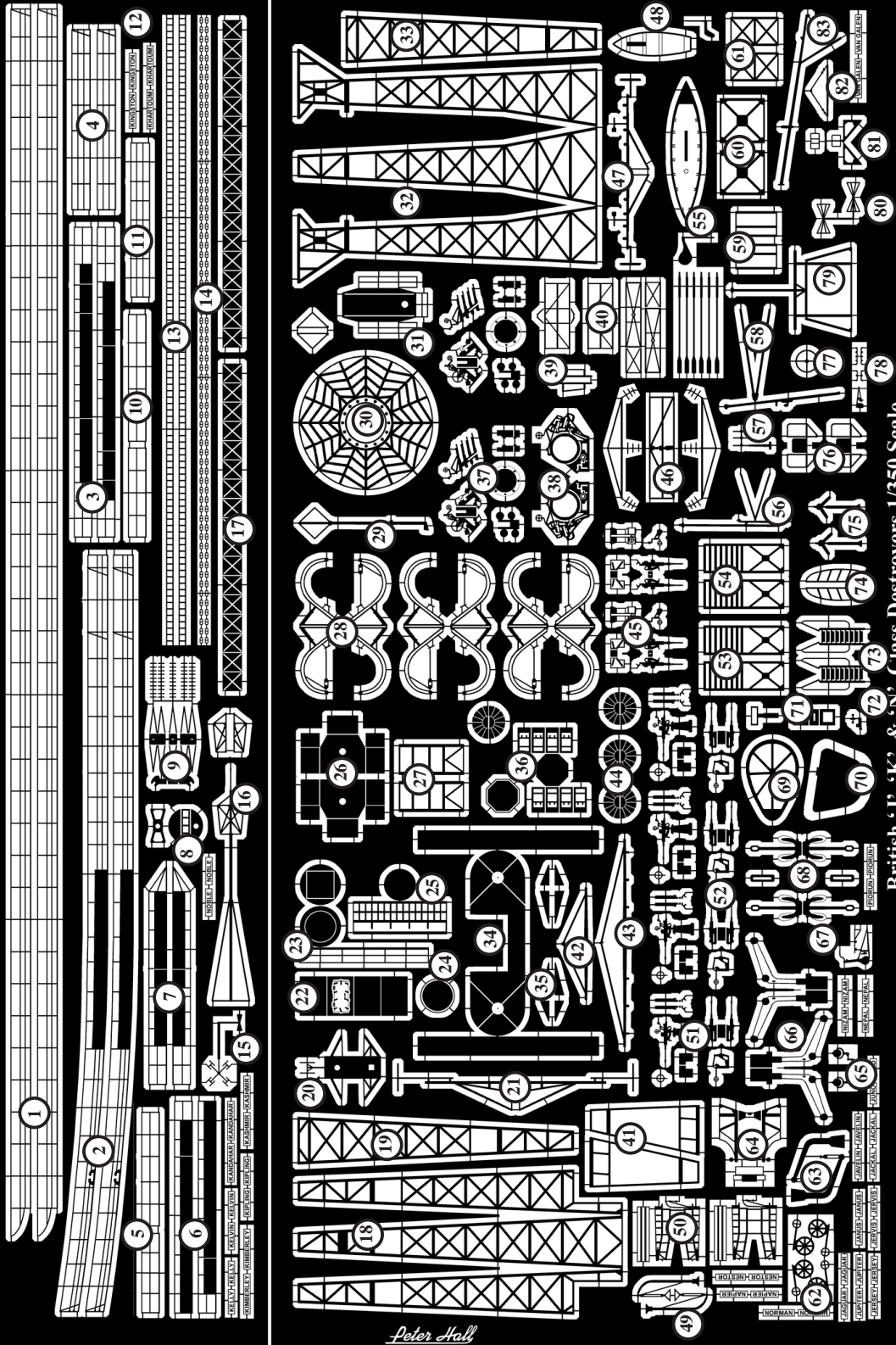

British 'J', 'K' & 'N' Class Destroyers 1/350 Scale

- | | | | | |
|--------------------------------------|----------------------------------|------------------------------------|---------------------------------------|-------------------------------------|
| 1. Railings (Main Deck) | 29. Foremast Top DF Antenna | 43. Tripod Foremast Lower Yard | 57. Radar Lantern Top Antenna | 71. 276 Radar Antenna |
| 2. Railings (Foosle) | 30. 4" AA Gun Foot Plate | 44. 20mm Oerlikon Footplates | 58. Ensign Staff | 72. Anemometer Vane |
| 3. Railings (X Gun Deck Leader) | 31. Lattice Mast Top Platform | 45. Twin 20mm Oerlikons | 59. Fwd AA gun Platform Supports | 73. Inclined Ladders (Hull Step) |
| 4. Railings (Amidships AA Platform) | 32. Lattice Mast (Kelvin) | 46. 286 Radar Antenna Type 2 | 60. Mid AA Platform Supports (Type 1) | 74. A Gun Training Stops |
| 5. Railings (X Gun Deck Ends) | 33. Lattice Mast Front Frame | 47. Lattice Mast Yardarms | 61. Mid AA Platform Supports (Type 2) | 75. Bridge Semaphores |
| 6. Railings (X Gun Deck) | 34. Lattice Mast Top Platform | 48. 14" Dingley Thwarts and Rudder | 62. TSDS Winch Drum Wheels | 76. Funnel Siren Platforms |
| 7. Railings (B Gun Deck) | 35. Mid AA Platform (Jervis) | 49. Depth Charge Davits | 63. Torpedo Loading Davits | 77. Searchlight Lens Cross |
| 8. 293 Radar Antenna | 36. Radar Lantern House | 50. Depth Charge Rails | 64. TSDS Stern Gantry | 78. 25' Fast Motor Boat Parts |
| 9. 285 Radar Yagi Antenna | 37. Quad Vickers Machine Gun | 51. Single 20mm Oerlikon Mountings | 65. Signal Lamps | 79. Main Mast Wire Antenna Spreader |
| 10. Railings (X Gun Deck Fwd Leader) | 38. Radar Lantern Platform | 52. Twin 20mm Powered Mounts | 66. TSDS Davits | 80. Fore Mast Top ECM Antenna |
| 11. Railings (Searchlight Platform) | 39. Radar Lantern Base Plate | 53. Canley Raft Racks (Forward) | 67. Adm Motor Cutter Parts | 81. Bridge Front DF Antenna |
| 12. Ships Name Plates | 40. 286 Radar Antenna Type 1 | 54. Carley Raft Rack (Mid) | 68. Anchor Assemblies | 82. Main Mast Pole Yard |
| 13. Vertical Ladder Stock | 41. Tripod Fore Mast Leg Spacers | 55. 27" Whale Thwarts and Oars | 69. Funnel Cap Grill | 83. Pole Main Mast |
| 14. Anchor Chain | 42. Tripod Fore Mast Upper Yard | 56. Jack Staff | 70. Rudder | |

Major Parts Location Diagram

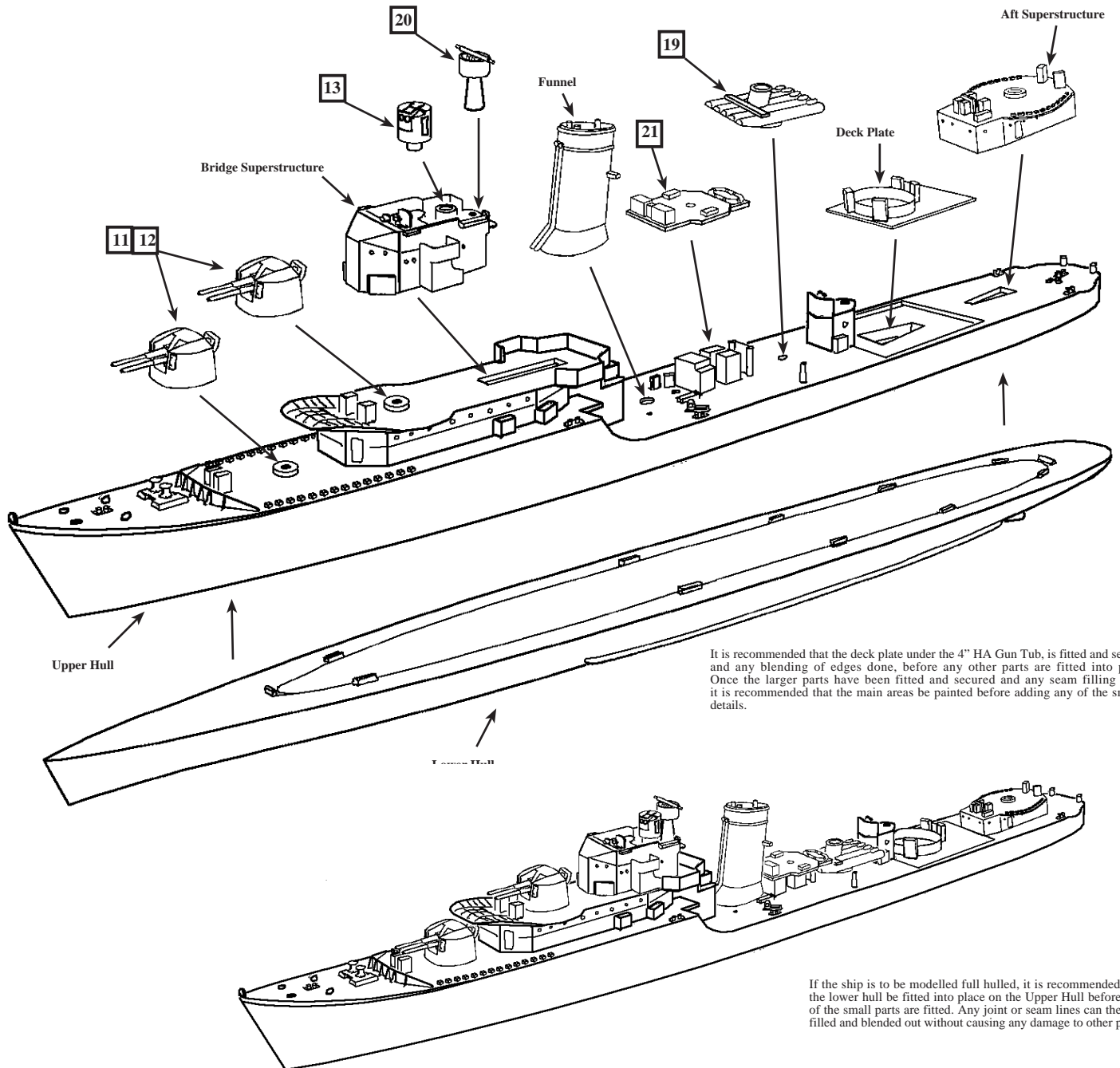

If the ship is to be modelled full hulled, it is recommended that the lower hull be fitted into place on the Upper Hull before any of the small parts are fitted. Any joint or seam lines can then be filled and blended out without causing any damage to other parts.

4.7" Turret Assembly

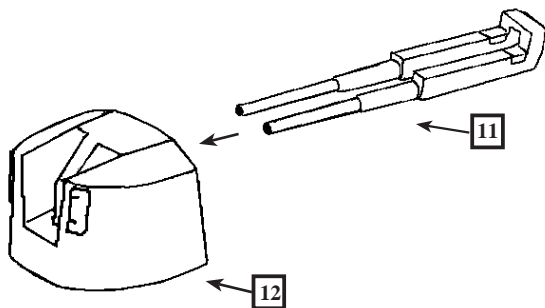

Fit the twin barrels in to the turret housing simply by pushing them through from the rear, ensuring the barrels pass either side of the centre pillar. Secure to the desired elevation before fitting to the decks. Make three items.

4 Barrelled Pom Pom Assembly

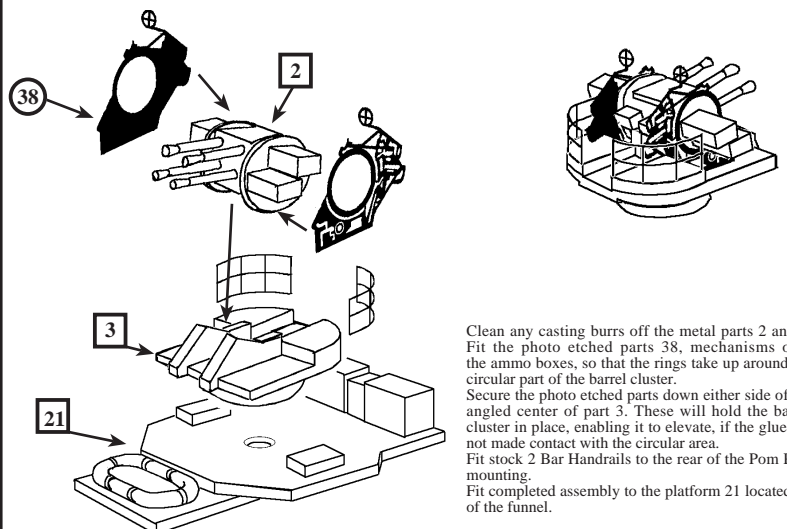

Clean any casting burrs off the metal parts 2 and 3. Fit the photo etched parts 38, mechanisms over the ammo boxes, so that the rings take up around the circular part of the barrel cluster. Secure the photo etched parts down either side of the angled center of part 3. These will hold the barrel cluster in place, enabling it to elevate, if the glue has not made contact with the circular area. Fit stock 2 Bar Handrails to the rear of the Pom Pom mounting. Fit completed assembly to the platform 21 located aft of the funnel.

Twin 20mm Powered Mounting

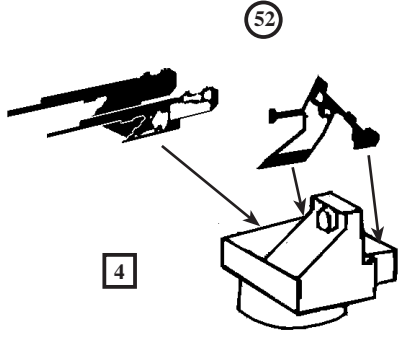

If the photo etched gun parts are to be used, remove the moulded metal gun barrels from the base.
 Fold up the gun barrel sides of the etched parts 52 to 90° so that they are parallel and fit into place where the moulded barrels had been.
 Fit the elevation mechanism to the right side of the trainers position and turn the gun sight across the front as shown

20mm Oerlikon

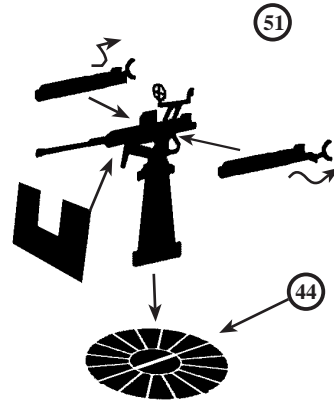

Assemble the 20mm Oerlikon mounting as shown above.
 Locate these into positions on either side of the quarter deck, aft of the TSDS winches

285 Radar Yagi Antenna Assembly

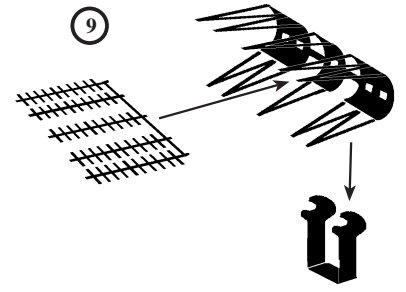

Assemble the 285 Fire Control antenna by folding a gentle curve on to the rectangular reflectors then folding over the stays so that they face forwards. Fit the set of dipoles centrally on to the reflector faces, locating the pegs into the slots.
 Nip the pointed ends of the stays together so that they trap the centre bar of the dipoles between them. Fit the mounting arms to the spindles between the reflectors.
 The complete assembly then fit on to the top of the main gun director part 20, so that the points face over the front of the director.

276 Radar Lantern Assembly

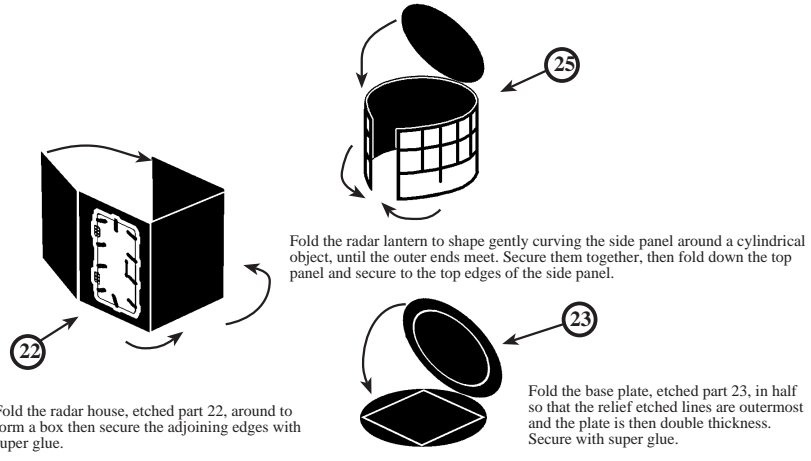

Fold the radar lantern to shape gently curving the side panel around a cylindrical object, until the outer ends meet. Secure them together, then fold down the top panel and secure to the top edges of the side panel.

Fold the radar house, etched part 22, around to form a box then secure the adjoining edges with super glue.

Fold the base plate, etched part 23, in half so that the relief etched lines are outermost and the plate is then double thickness. Secure with super glue.

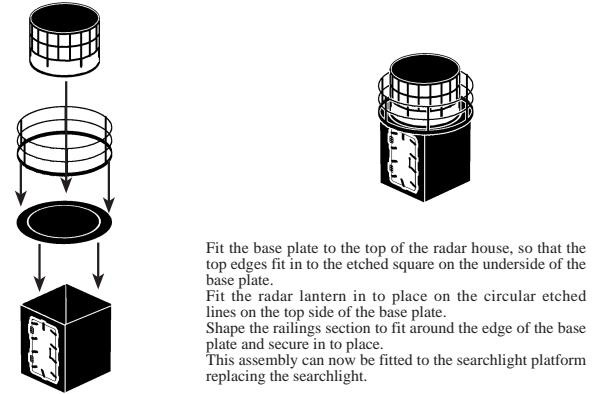

Fit the base plate to the top of the radar house, so that the top edges fit in to the etched square on the underside of the base plate.
 Fit the radar lantern in to place on the circular etched lines on the top side of the base plate. Shape the railings section to fit around the edge of the base plate and secure in to place.
 This assembly can now be fitted to the searchlight platform replacing the searchlight.

Bridge Fittings Location

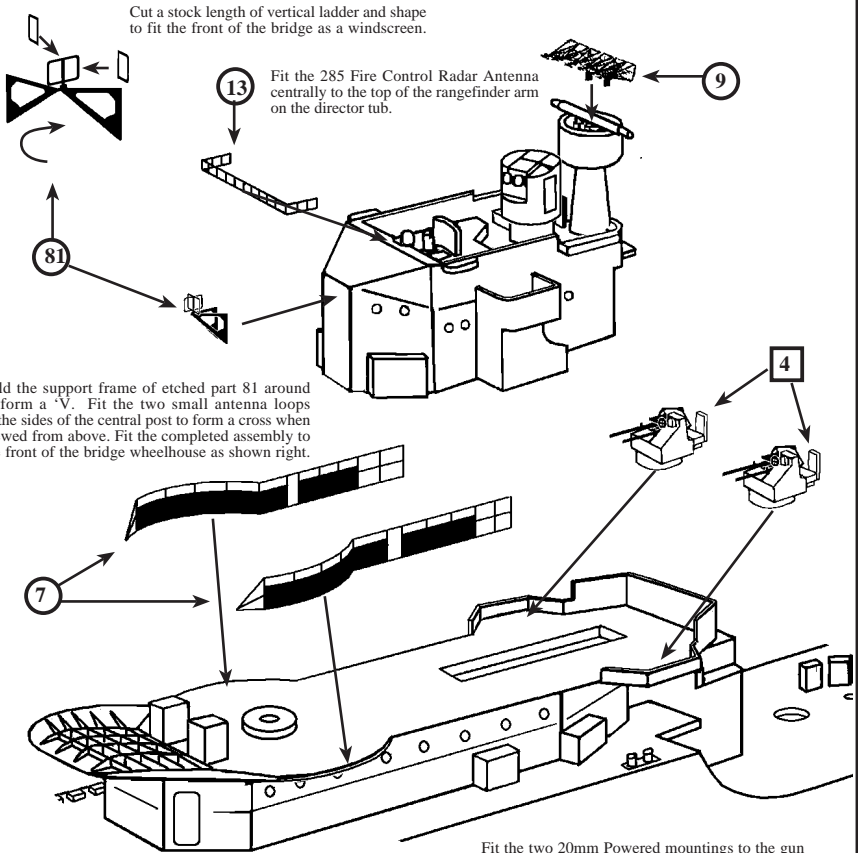

Cut a stock length of vertical ladder and shape to fit the front of the bridge as a windscreen.

Fit the 285 Fire Control Radar Antenna centrally to the top of the rangefinder arm on the director tub.

Fold the support frame of etched part 81 around to form a 'V'. Fit the two small antenna loops to the sides of the central post to form a cross when viewed from above. Fit the completed assembly to the front of the bridge wheelhouse as shown right.

Shape and fit the railings sections, etched parts 7, to the edges of B gun deck as shown right. The rear stanchion butts against the spray shield below the signal lamp platforms.

Fit the two 20mm Powered mountings to the gun platforms on each side of the bridge as shown left. The bulwarks may be cut down as shown to show the gun mountings being trained.

Aft AA Platform Assembly

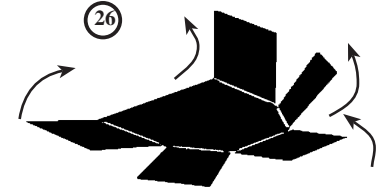

Fold up the splinter shield sides of the aft AA gun tubs, etched parts 26, to 90° Ensure the vertical edges mate up then secure the joins with super glue. Make two of these to fit to the sides of the radar house as shown in a later section.

Funnel Fittings

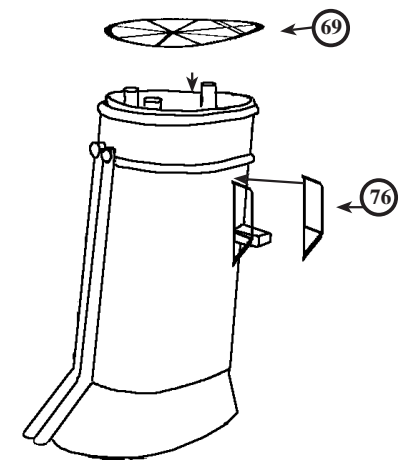

Fit Funnel Cap grill 69 as shown, ensuring that the pipework passes through the holes.
 Fit handrails to the sides of the funnel platforms in pairs. A section of vertical ladder may also be fitted from the main deck to the platform.

Aft Superstructure Railings Location

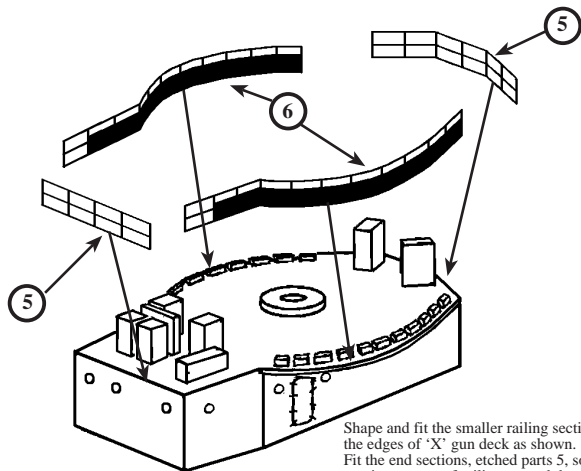

Shape and fit the smaller railing sections, etched parts 6, to the edges of 'X' gun deck as shown.
Fit the end sections, etched parts 5, so that they form a continuous run of railing around the deck edge.

Amidships Searchlight and AA Platform Railings

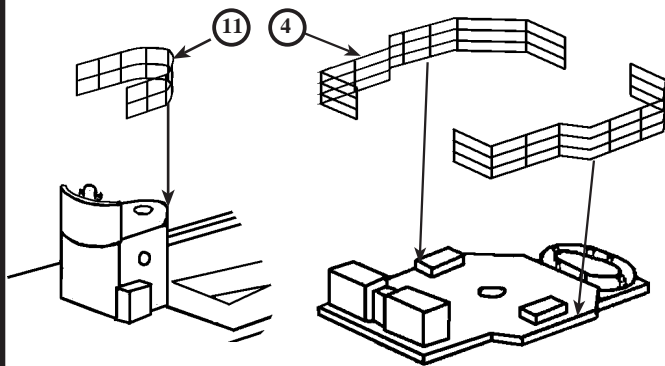

Shape and fit the railings sections, etched parts 4, around the edges of the amidships AA Platform. This is best done after the AA platform has been fitted into place behind the funnel. See diagram below. Shape the railing section, etched part 11, around the edge of the searchlight platform.

Boats Assembly

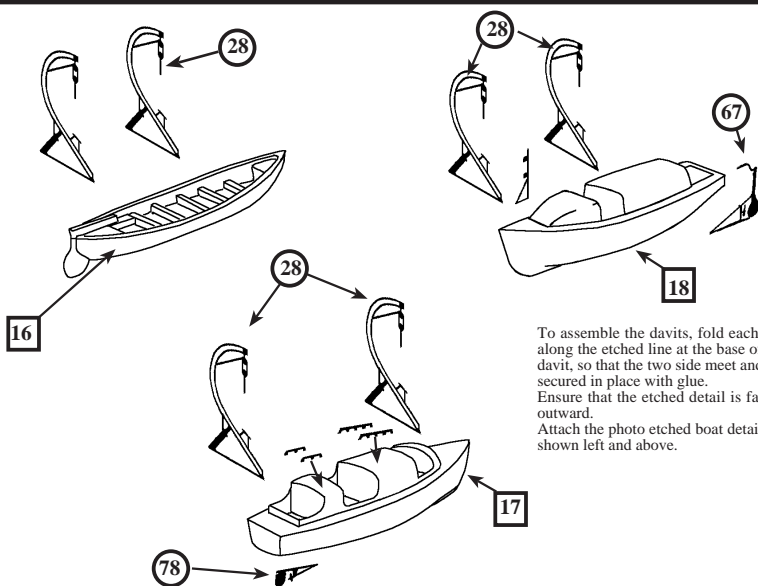

To assemble the davits, fold each one along the etched line at the base of the davit, so that the two side meet and are secured in place with glue. Ensure that the etched detail is facing outward.
Attach the photo etched boat details as shown left and above.

Starboard Side Boat Location

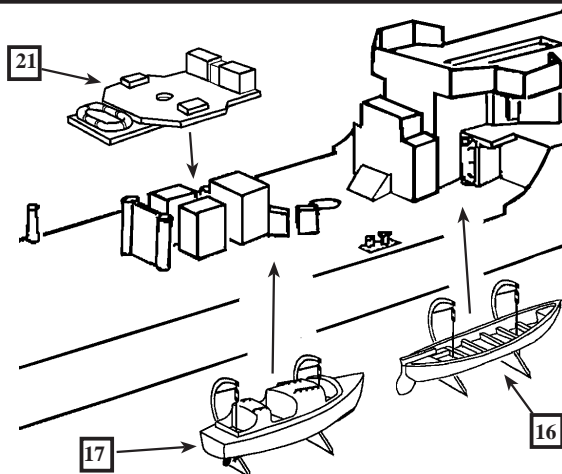

It may be easier for some, to fit the davits to the deck first, before fitting the boats. The positions of each davit is as follows. Fit each one parallel to the next along the edge of the deck. The first one being 9mm from the hull step, the second 23mm, the third 41mm and the fourth 55mm. Measure out these distances and mark with pencil to ensure an exact fit.
The boats may now be fitted to the falls by drilling fine holes into the coach roof or attaching the falls to the thwart or bulkheads as necessary.

Fore Mast Assembly

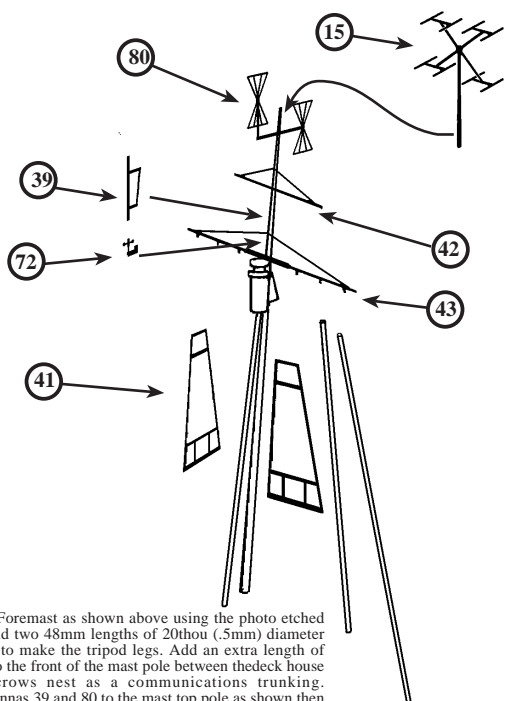

Assemble Foremast as shown above using the photo etched parts 41 and two 48mm lengths of 20thou (.5mm) diameter brass rods to make the tripod legs. Add an extra length of brass rod to the front of the mast pole between the deck house and the crows nest as a communications trunking. Fit the antennas 39 and 80 to the mast top pole as shown then fit the anemometer 72 to the front of the mast just above the lower yardarm.

The 291 radar antenna, etched part 15, is folded in to shape by bending the outer dipoles so that they face in the direction shown above. Fit to the very top of the mast as shown.

Port Side Boat Location

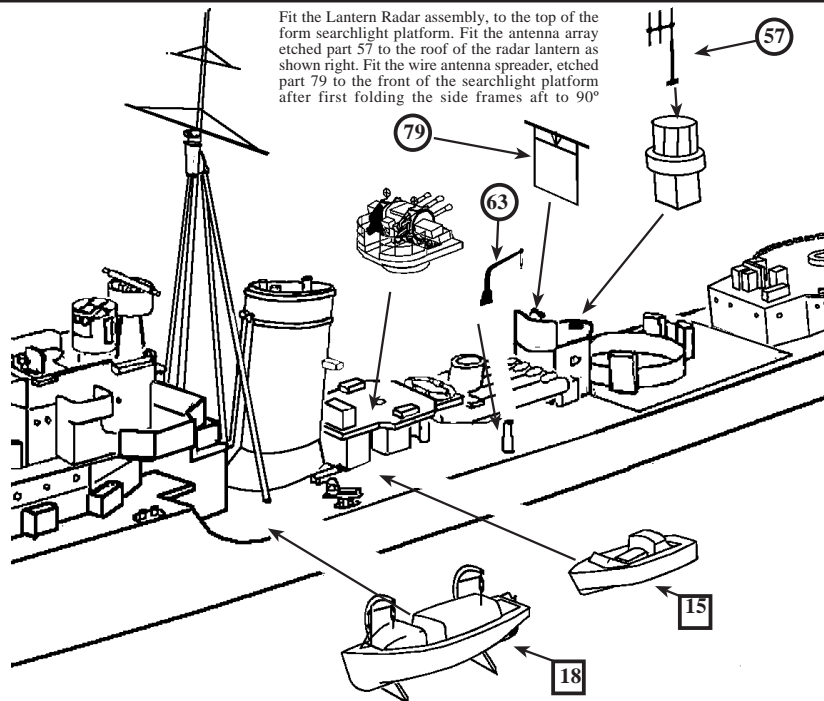

Fit the Lantern Radar assembly, to the top of the form searchlight platform. Fit the antenna array etched part 57 to the roof of the radar lantern as shown right. Fit the wire antenna spreader, etched part 79 to the front of the searchlight platform after first folding the side frames aft to 90°

If the davits are to be fitted to the deck before fitting the boat in place, measure and mark out 9mm from the hull step and 23mm. This is the position to fit the two davits on this side. The small motor dinghy is placed directly on to the deck along side the Pom Pom platform.

Aft Twin 20mm Mk5 Mountings

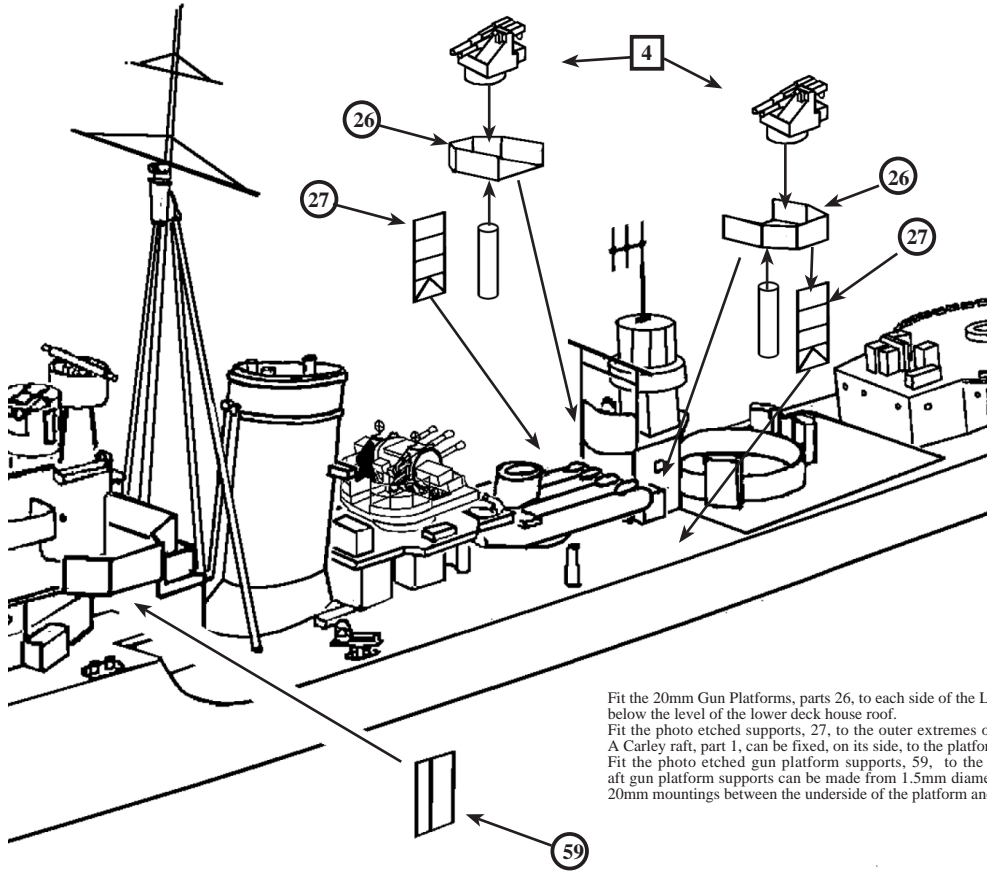

Fit the 20mm Gun Platforms, parts 26, to each side of the Lantern Radar lower deck house so that they are 2.5mm below the level of the lower deck house roof.
 Fit the photo etched supports, 27, to the outer extremes of the gun platforms undersides and to the main deck.
 A Carley raft, part 1, can be fixed, on its side, to the platform supports so that the open top of the raft is outwards.
 Fit the photo etched gun platform supports, 59, to the undersides of the forward gun platforms. Additional aft gun platform supports can be made from 1.5mm diameter plastic rod. Trim to length to fit directly under the 20mm mountings between the underside of the platform and the main deck.

Depth Charge Thrower and 4" Gun Location

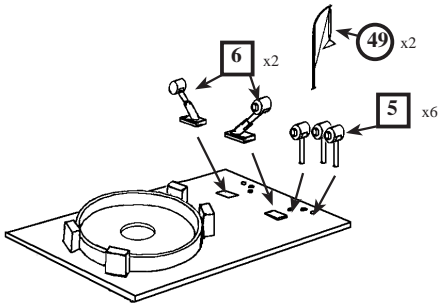

The deck plate has been shown away from the hull for clarity, but at this stage should be fitted into its position before further work.
 Fit the depth charge throwers and the re loads as shown left, along with photo etched handling davits 49.

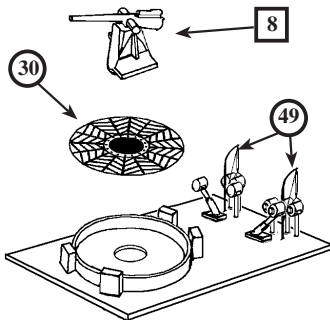

Assemble the 4" AA gun mounting by fitting the foot plate, etched part 30, into the gun tub as shown. Fit the gun mounting, part 8, centrally on to the etched foot plate in the desired position.

Stern and TSDS Fittings

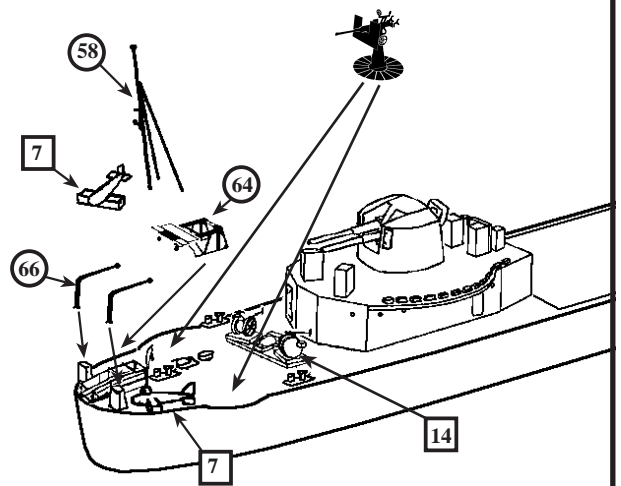

Fit the depressor paravane platform so that the sides straddle the depth charge rails and secure to the deck. Fit the ensign staff so that the pole passes aft of the platform and the support legs go either side.
 Fit the main paravanes on to the deck on each side and forward of the handling derricks.

TSDS Fittings

Fold over the sides of the depth charge rails so that they are parallel.
 Fold the rail section so that there is an angle approx half way along that will match the rail on the sides of the frame. Fit rail section inside frame and secure in place.

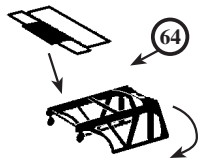
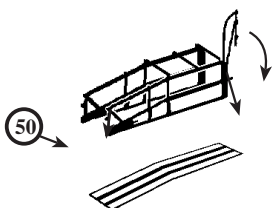

Fold and assemble the depressor paravane platform as shown above.

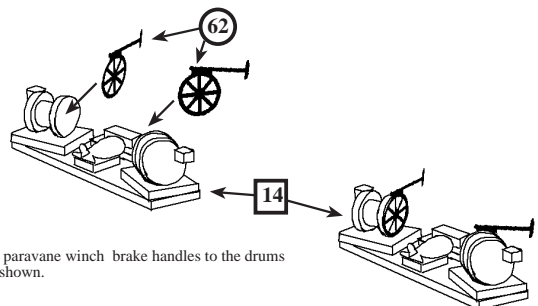

Fit paravane winch brake handles to the drums as shown.

MF/DF Antenna

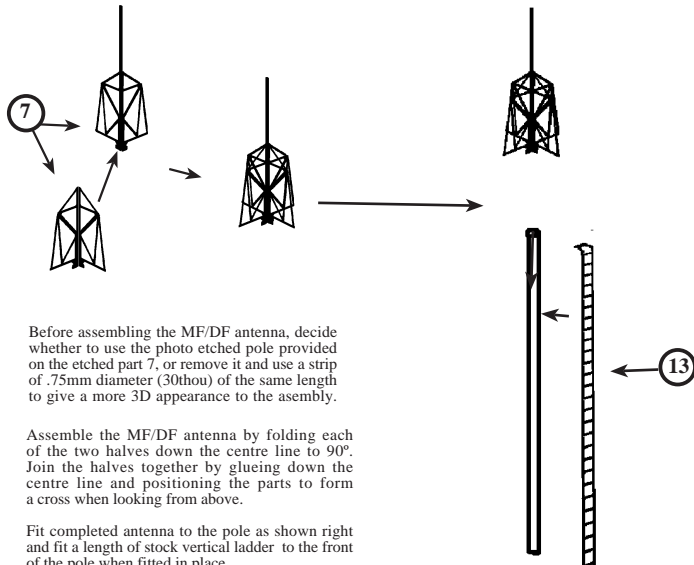

Before assembling the MF/DF antenna, decide whether to use the photo etched pole provided on the etched part 7, or remove it and use a strip of .75mm diameter (30thou) of the same length to give a more 3D appearance to the assembly.

Assemble the MF/DF antenna by folding each of the two halves down the centre line to 90°. Join the halves together by glueing down the centre line and positioning the parts to form a cross when looking from above.

Fit completed antenna to the pole as shown right and fit a length of stock vertical ladder to the front of the pole when fitted in place.

TSDS Equipment Location

Fit the TSDS winches, depth charge rails and the MF/DF antenna as shown below.

Fit the 4.7" gun turret so that the mounting faces aft.

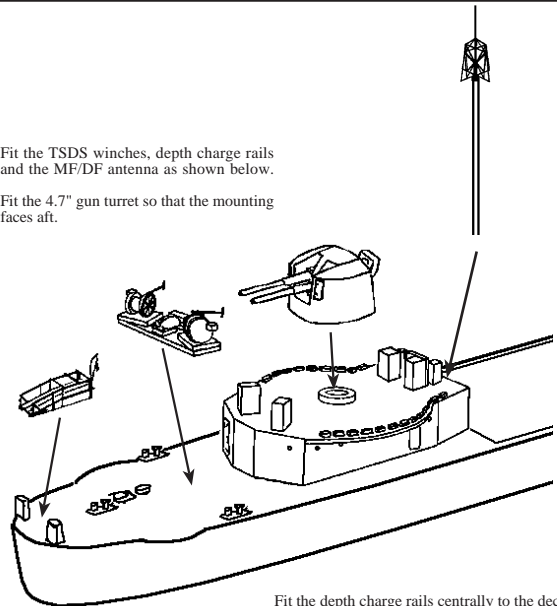

Fit the depth charge rails centrally to the deck on the stern as shown.

Foc's'le and Main Deck Railing Location

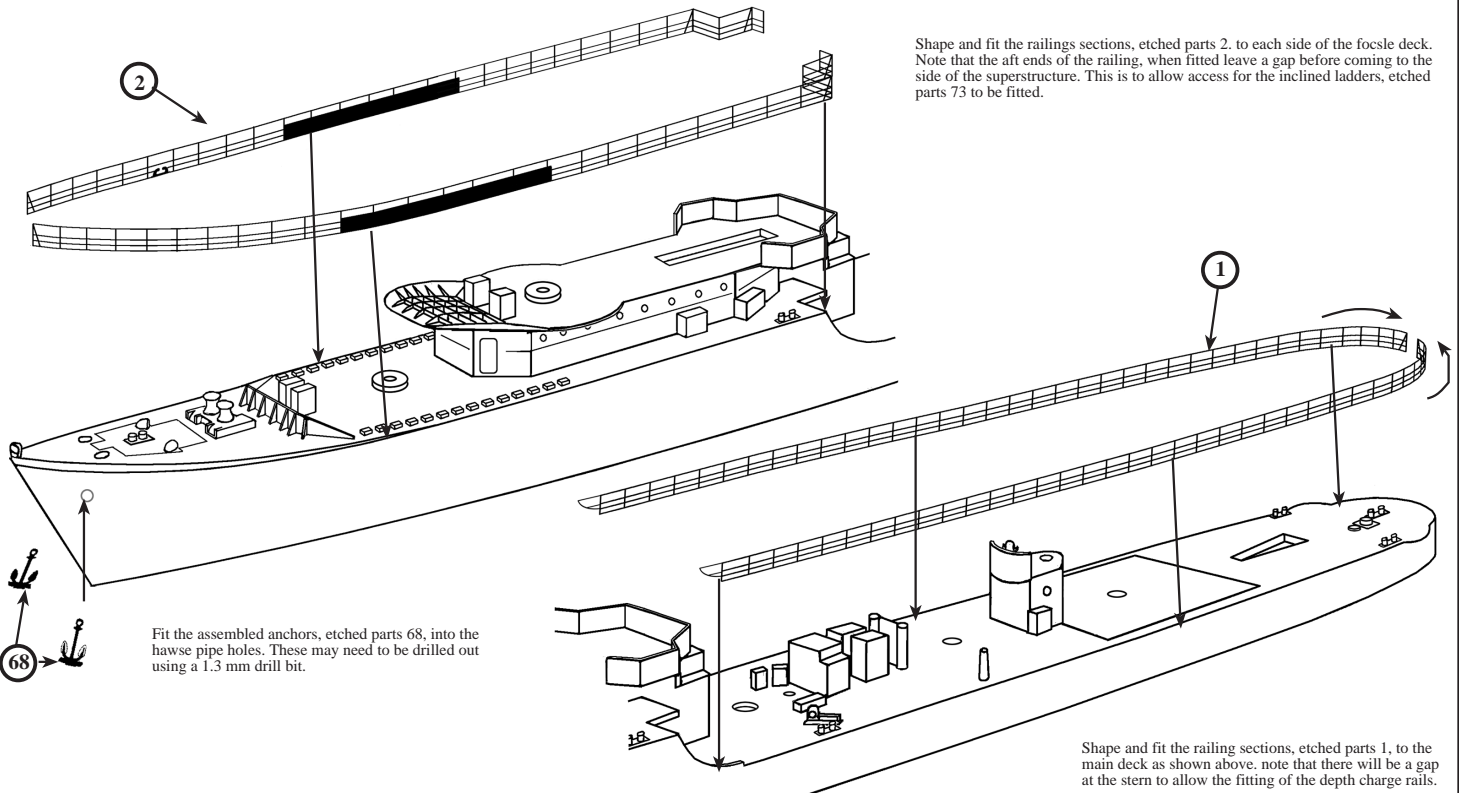

Shape and fit the railings sections, etched parts 2, to each side of the foc'sle deck. Note that the aft ends of the railing, when fitted leave a gap before coming to the side of the superstructure. This is to allow access for the inclined ladders, etched parts 73 to be fitted.

Fit the assembled anchors, etched parts 68, into the hawse pipe holes. These may need to be drilled out using a 1.3 mm drill bit.

Shape and fit the railing sections, etched parts 1, to the main deck as shown above, note that there will be a gap at the stern to allow the fitting of the depth charge rails.

Anchor Assembly

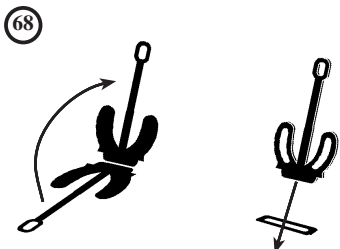

Assemble photo etched anchors 68 as shown above. Fit anchors into the hawse pipes each side of the bow, after first drilling out the holes with a 1.3mm drill bit.

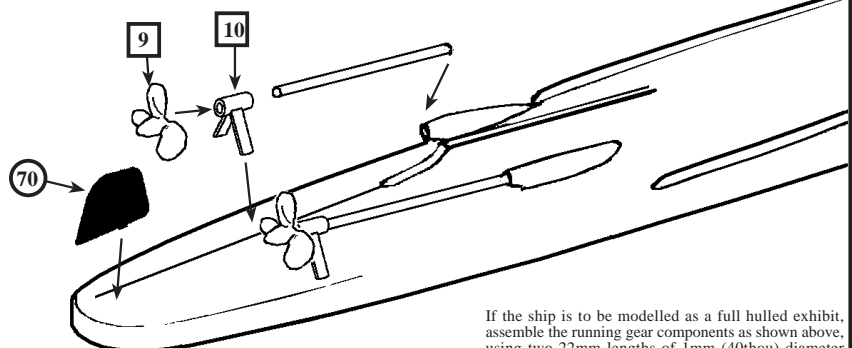

Propeller and Rudder Fittings



If the ship is to be modelled as a full hulled exhibit, assemble the running gear components as shown above, using two 22mm lengths of 1mm (40thou) diameter brass or plastic rod.

COLOUR CHART & PAINTING GUIDE

ORP PIORUN Special Home Fleet Destroyer Design JUNE - DECEMBER 1944

	WARM LIGHT GREY G45 Colourcoats RN14
	MEDIUM BLUE GREEN B30 Colourcoats RN21
	MEDIUM GREY GREEN G20 Colourcoats RN25

	DECK STEEL GREY Colourcoats RN05
	CEMTEX (could be painted over) (in deck grey)
	ANTI FOULING RED Colourcoats RN19

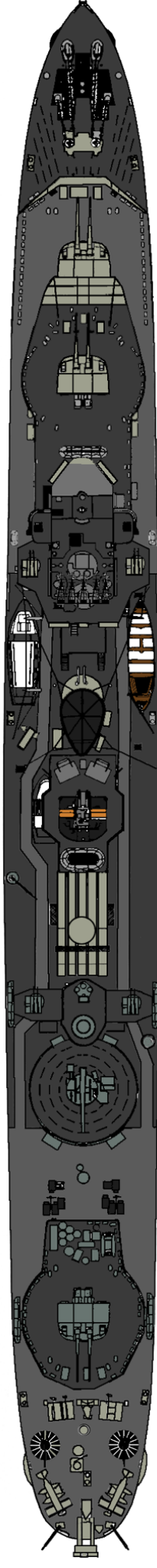
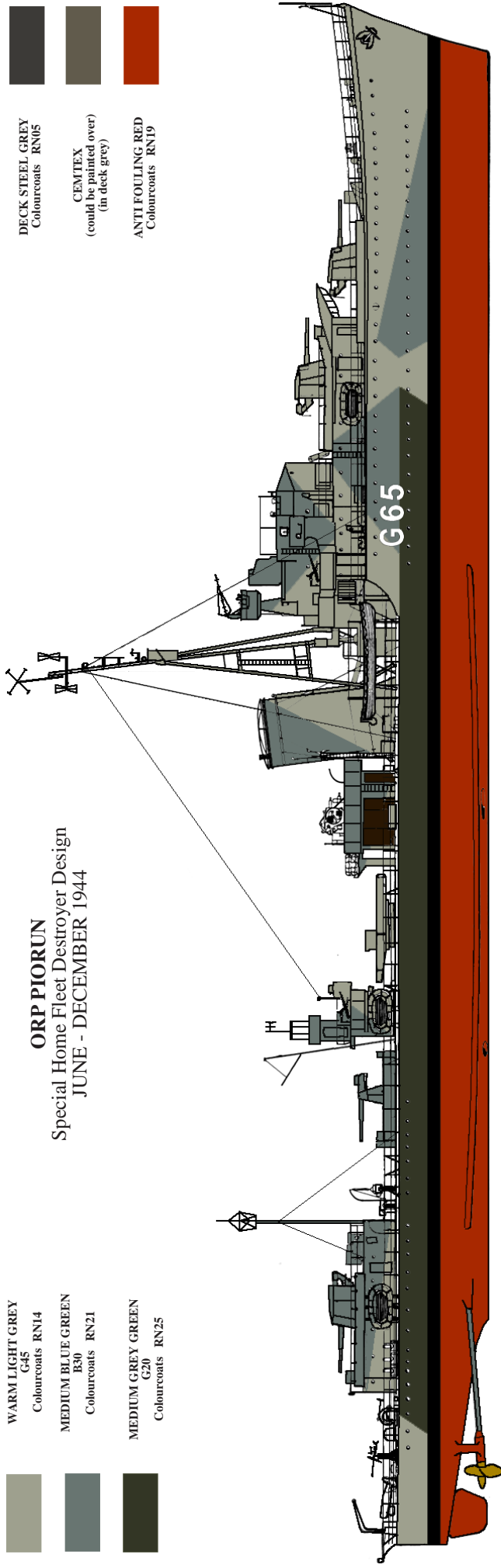

OTHER INSTRUCTIONS

1. The positions of the Carley Rafts have not been shown in the main assembly instructions, but can be seen clearly on the painting guide plan and profile above. The rafts were over painted in the colour and shape of the camouflage pattern against which they were positioned.
2. Safety Rails, etched parts 47, are for fitting on top of the fore and aft deckhouses adjacent to 'B' and 'X' turrets. These have enclosed sections of canvas dodgers that were fitted, to prevent empty shell cases from rolling off on to the deck below or even over the side. These sections are fitted against the deck.
3. Upswept Bow railing has been provided in the form of etched parts 49. Again these have canvas dodgers, that fit adjacent to 'A' Turret this time.
4. Ships name plates are provided in the form of etched parts 48. There are a pair of these with the name PIORUN that are fitted to each side of the aft deck house. You will have noticed that name plates have also been provided for ship in the J,K and N classes.
5. The splinter matting, etched parts 44, are purely optional and may be fitted if desired, on the bulwarks and railings around AA gun mountings and even the bridge. It is recommended that further research into the precise location of these mats be carried out.
6. Inclined ladders are fitted on each side at the hull step, from the main deck to the fo's'sle deck via the small platform that protrudes aft from the step. Vertical ladders are fitted on the port side of the bridge for access. On the forward bulkhead of the aft deck house for gun crew access. Up each side of the funnel to the small platforms. Up the foremast to the crow's nest