

HMS ARCHER

P2000 Patrol/ Training Craft

1/350 Scale

Resin and Metal Parts Identification

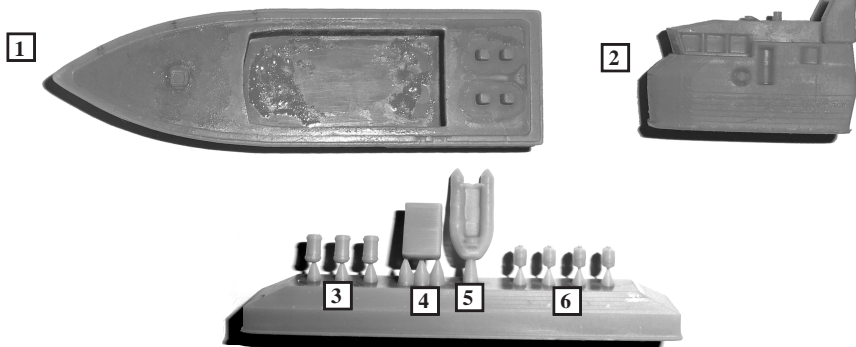

- | | | |
|------------------|-------------------------|---------------------------|
| 1. Hull | 3. Life Raft Canisters | 5. Gemini Inflatable Boat |
| 2. Cabin/ Bridge | 4. Large Raft Container | 6. Small Raft Containers |

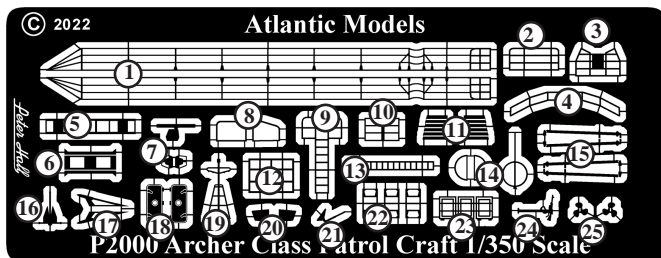

- | | | |
|-----------------------|---------------------------|------------------------------|
| 1. Main Deck Railings | 9. Bridge Access Ladder | 18. Cabin Doors |
| 2. Stern Railing | 10. Bridge Rear Railing | 19. Mast Top |
| 3. Stern Rack | 11. Vent Grills | 20. Rudders |
| 4. Bridge Wind Screen | 12. Gemini Stowage Rack | 21. Kedge Anchor |
| 5. Mast Goal Posts | 13. Radar Platform Ladder | 22. Life Raft Canister Racks |
| 6. Radar Platform | 14. DF Loop Antenna | 23. GPMG Enclosure |
| 7. Navigation Radar | 15. Boat Crane Jibs | 24. GPMG Mounting |
| 8. Bow Railing | 16. Danforth Anchor | 25. Propellers |
| | 17. Propeller Shafts | |

WARNING

This kit contains a mixture of resin and photo etched metal parts, of which some of the resin parts have been attached to sprues for ease of casting. Care must be taken when detaching the parts from the sprues, to remove the flash without causing damage. When cleaning off the excess material using files or abrasive paper, it is recommended that a mask is worn as resin dust can be harmful to health if inhaled.

General Instructions for working with Photo Etched Metal

1. Do not remove the etched parts from the fret until you are ready to use them.
2. Before assembly, soak the etched parts in a suitable solvent, such as white spirit, to de-grease the surfaces for painting.
3. Cyanoacrylate adhesive (Super glue) or contact adhesive such as Elmers white glue may be used. These can be applied with a pin or piece of stretched sprue.
4. When removing parts from the fret, place the fret on a hard surface, such as a smooth ceramic tile, in order to prevent parts bending whilst cutting through the holding tabs. It is suggested that a #11 type of modelling knife blade is used for this purpose.
5. When shaping or bending a part, a straight edged blade such as a chisel blade #17 or # 18 will give a good sharp corner, or alternatively a small pair of smooth jawed pliers may be used.
6. If a part is bent incorrectly, lay it on a hard flat surface and roll it flat with a cylindrical object such as a modelling knife handle.
7. It is suggested that rails are pre-measured, where practical, using a pair of compass dividers and then tacked to the deck edge every third or fourth stanchion with a small drop of glue. When a section is complete, run a thin line of glue along the inside edge to attach it firmly to the deck.

Main Deck Fittings (Forward)

Fold down the outer ends of etched parts 22, to form the stowage racks for the Life Raft Canisters, resin parts 3.

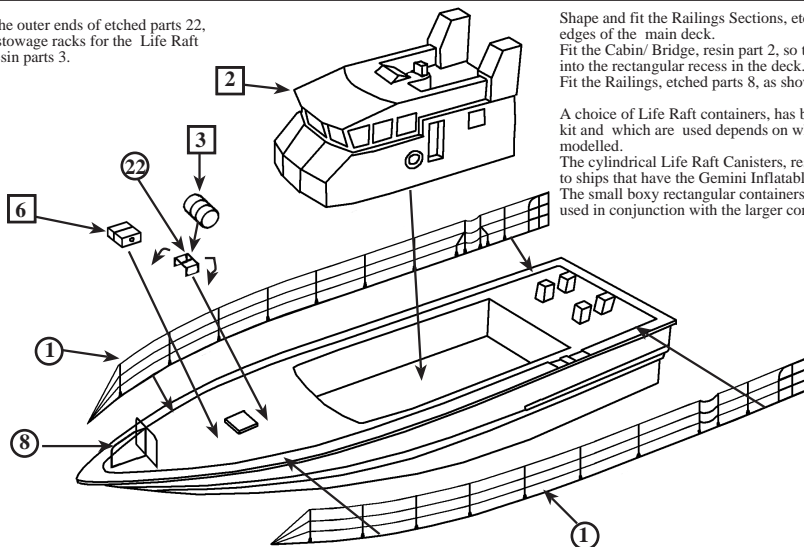

Shape and fit the Railings Sections, etched parts 1, to the edges of the main deck.

Fit the Cabin/ Bridge, resin part 2, so that it fully fits into the rectangular recess in the deck.

Fit the Railings, etched parts 8, as shown to the fore deck.

A choice of Life Raft containers, has been supplied in the kit and which are used depends on which ship is being modelled.

The cylindrical Life Raft Canisters, resin parts 3, are fitted to ships that have the Gemini Inflatable Boat.

The small boxy rectangular containers, resin parts 6, are used in conjunction with the larger container, part 4.

Mast and Cabin Fittings

Fit the two doubler plates to each side of etched part 7 as shown above, with the relief detail outermost. Turn the radar antenna 90° to the base.

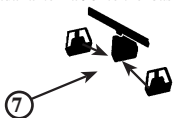

Fit the two half circular loops so that the vertical pole fits onto each side of the vertical pole of the full circular loop. This should form a cross when viewed from above.

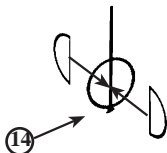

Fold up the narrow sides of etched part 6 to 90° and fit into place between the exhaust stacks. Shape the mast base goal posts, etched part 5 as shown and fit to the radar platform. Fit the assembled radar, etched parts 7, centrally to the radar platform, etched part 6.

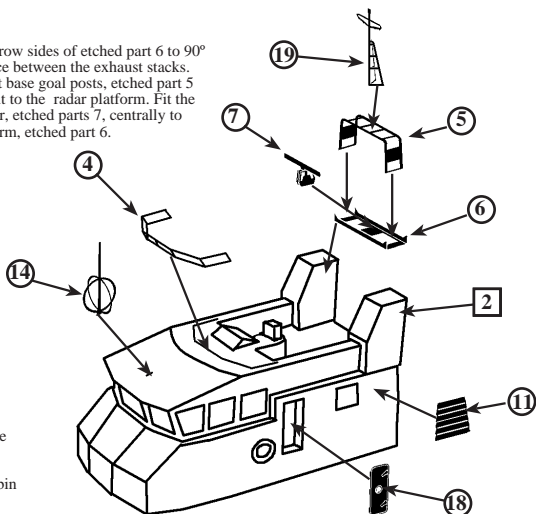

Fold the lower section of the Mast, etched part 19, so that the legs form a 'V' at 45° on each side of the mast central pole.

Fit into place centrally on top of etched part 5.

Fit the Vent Grills, etched parts 11, to the aft sides of the cabin directly below the exhaust stacks.

Cabin Fittings (Aft)

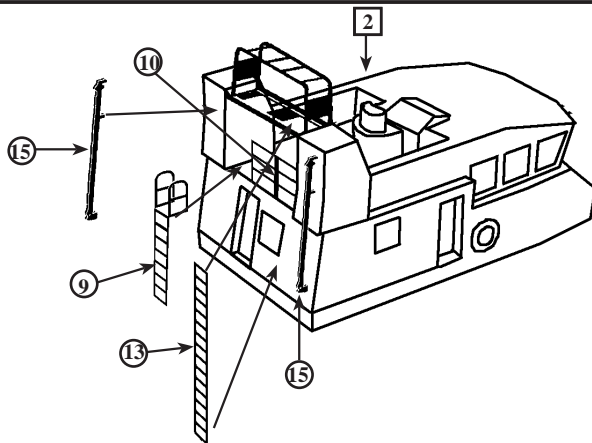

Fold the two boat crane jibs, etched parts 15, in half with the relief detail outmost. Secure into place and fit to the rear of the exhaust stacks as shown left.

Shape and fit the Bridge Access Ladder, etched part 9, and fit to the port side of the rear bulkhead. Fit the small section of railing, etched part 10, to the starboard side of the bridge deck aft.

Fit the Radar Platform Access Ladder, etched part 13 to the starboard side, running down from the radar platform to fit the bottom against the rear cabin bulkhead.

Main Deck Fittings (Aft)

Fold down the outer ends of etched parts 22, to form the stowage racks for the Life Raft Canisters, resin parts 3.

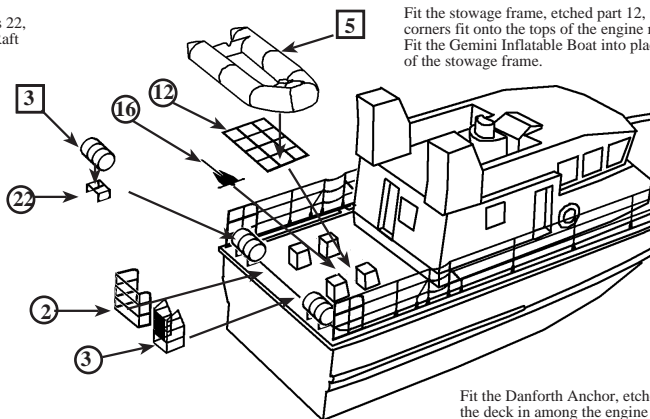

Shape the small Railing Section, etched part 2, as shown and fit into place off centre to port on the stern. The shorter length inboard.

Shape and fit the stowage rack, etched part 3, to the starboard side of the deck edge.

These assemblies fit into place after the life rafts have been fitted to the outboard positions

Fit the stowage frame, etched part 12, so that the corners fit onto the tops of the engine room vents. Fit the Gemini Inflatable Boat into place on top of the stowage frame.

Fit the Danforth Anchor, etched part 16, to the deck in among the engine room vents

Main Deck Fittings (Aft Alternative)

Fold down the outer ends of etched parts 22, to form the stowage racks for the Raft Containers, resin parts 3.

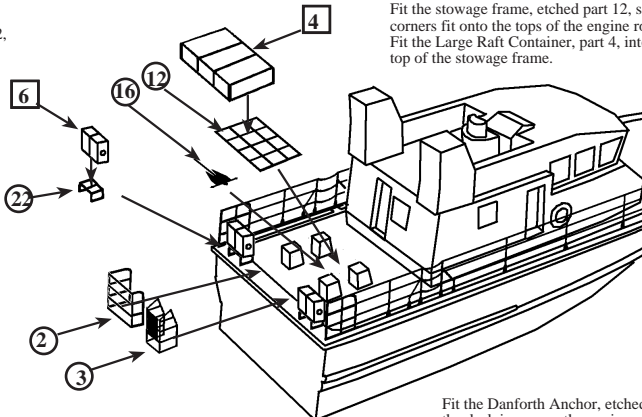

Shape the small Railing Section, etched part 2, as shown and fit into place off centre to port on the stern. The shorter length inboard.

Shape and fit the stowage rack, etched part 3, to the starboard side of the deck edge.

These assemblies fit into place after the Raft Containers have been fitted to the outboard positions

Fit the stowage frame, etched part 12, so that the corners fit onto the tops of the engine room vents. Fit the Large Raft Container, part 4, into place on top of the stowage frame.

Fit the Danforth Anchor, etched part 16, to the deck in among the engine room vents

Running Gear Assembly and Location (Alternative)

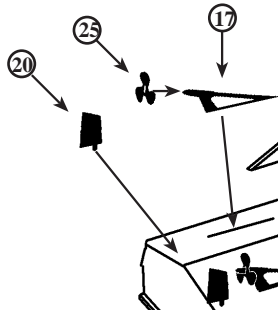

Fit the propellers, etched parts 25 so that they slot onto the bullet shaped part of the propeller shafts, etched parts 17. Fit into place on each side of the hulls at the positions shown.

Fit the rudders, etched parts 20, directly behind the propellers.

The kit has been printed so that the underside of the hull can be used to mount the model as a waterline display. However enough material has been left to allow the lower hull to be shaped out if it is required as a full hulled model. If this is the case then a strip of 20 thou (0.5mm) plastic card will need to be shaped and fitted to form the keel skeg as shown above.

Colour Chart and Painting Guide

Light Weatherwork
Grey
Humbrol 127

Deck Olive
Green
Humbrol 120

Anti Fouling Red
Humbrol 100

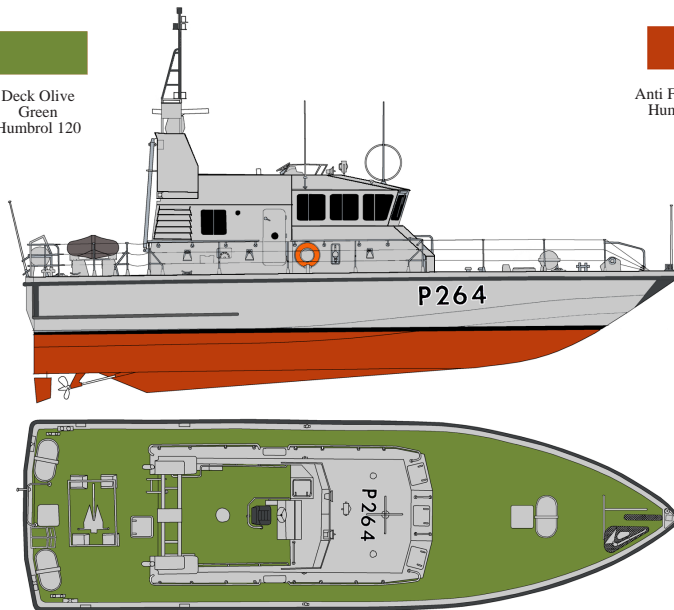

Other Colours Used:

Matt Black Humbrol 33
Matt Dark Grey Humbrol 67
Matt Dark Grey Humbrol 32

Hull Boot Topping, GPMG Mounting, Cabin Windows
Rubbing Strip Around the Hull
Gemini Inflatable Boat

The colours of this kit has been listed using equivalents from the Humbrol range of paints as they are easily obtained from most hobby and craft stores in either enamel or acrylic format.