

# 'Town' Class Destroyer H.M.S. Montgomery 1941

Resin & Photo Etched Metal Kit in 1/350 scale

## History

Laid down by Bath Ironworks as the USS Wickes in 1917, this was the nameship of a large class of new flush deck destroyers for the US Navy. With the end of the First World War, a lot of these destroyers were no longer required and so in May 1922 the USS Wickes was laid up in reserve. She was however reactivated during 1930 for service until 1937 when again she was laid up in reserve until the start of the war in Europe. Being reactivated again the USS Wickes served in the Atlantic on neutrality patrols along the eastern seaboard of the USA until October 1940 when she was transferred to the Royal Navy along with several of her sisters under the Lease Lend agreement.

She was renamed HMS Montgomery and was first allocated to the Western Approaches command based in Liverpool. From here the Montgomery served on anti submarine patrols and convoy escort in the eastern Atlantic. During one of these patrols she rescued 39 survivors from the tanker Scottish Standard which had been torpedoed and sunk.

Montgomery was later transferred to the 4th Escort Group base at Greenock in Scotland, and continued her service patrolling out into the Atlantic as far as some of the Canadian ports. In January 1942, Montgomery picked up the survivors from the steamer SS Fair Rock and was instrumental in chasing down several U.boats .

At the end of 1942 Montgomery was loaned to the Canadian Navy for a year, then on her return she served again on Atlantic escort duty. In February 1944, Montgomery was placed in reserve and laid up in the River Tyne until she was struck of the list and broken up for scrap in the early part of 1945.

## Specifications

Length Overall 314ft 5 ins. Beam 31 ft 8 ins. Displacement 1215 tons Speed 35 knots. Crew 103

## Armament (as Montgomery)

1 x 4" / 50 Deck Gun Forward 1 x 3"/50 Deck Gun Aft 4 x Single 20mm Oerlikon AA Mountings 2 x 0.5" Machine Guns  
3 x 21" Torpedo Tubes on 1 Triple Mounting 4 x Depth Charge Throwers with 2 x Reloads each  
2 x Depth Charge Stern Rails each with 8 Depth Charges

## Small Parts Identification

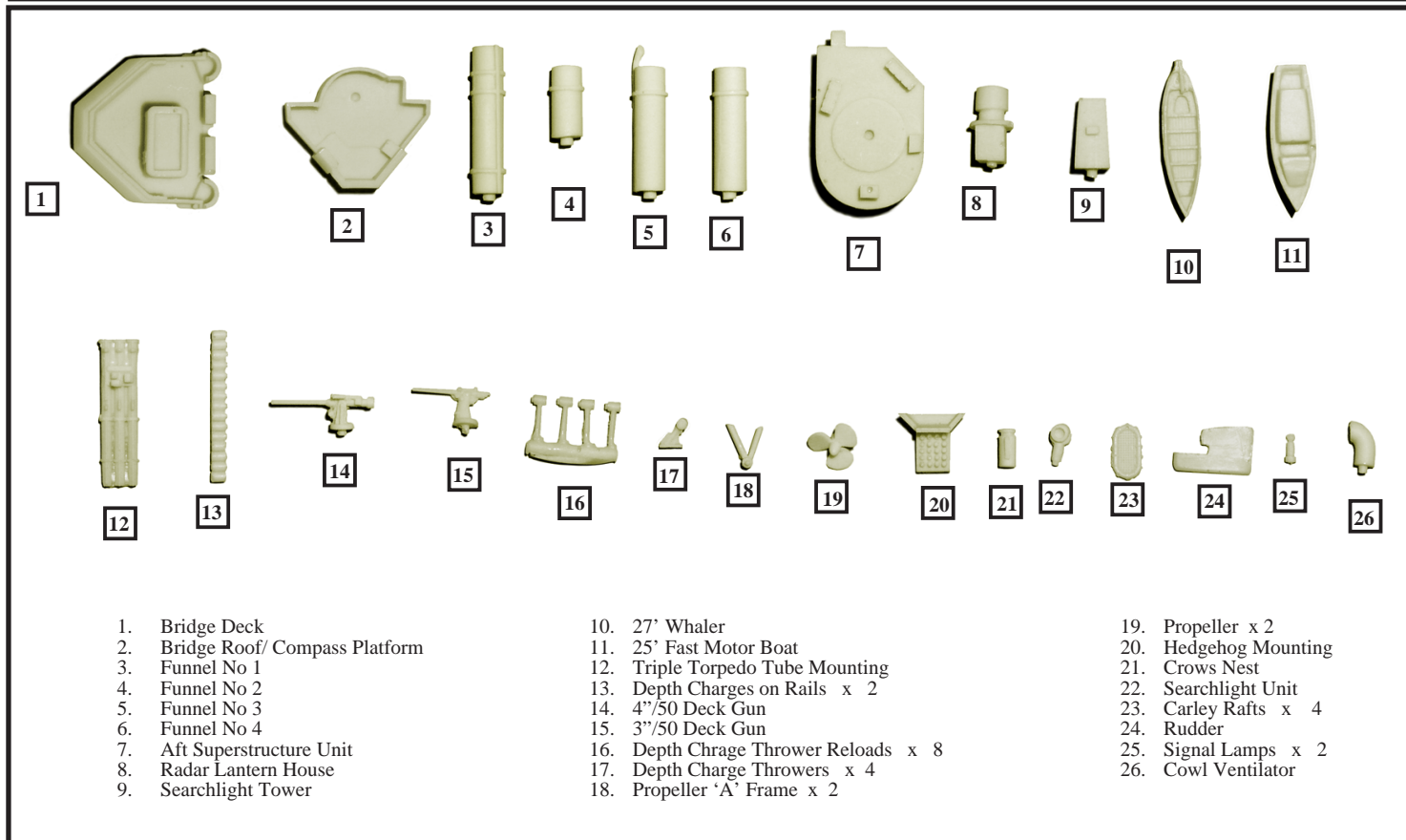

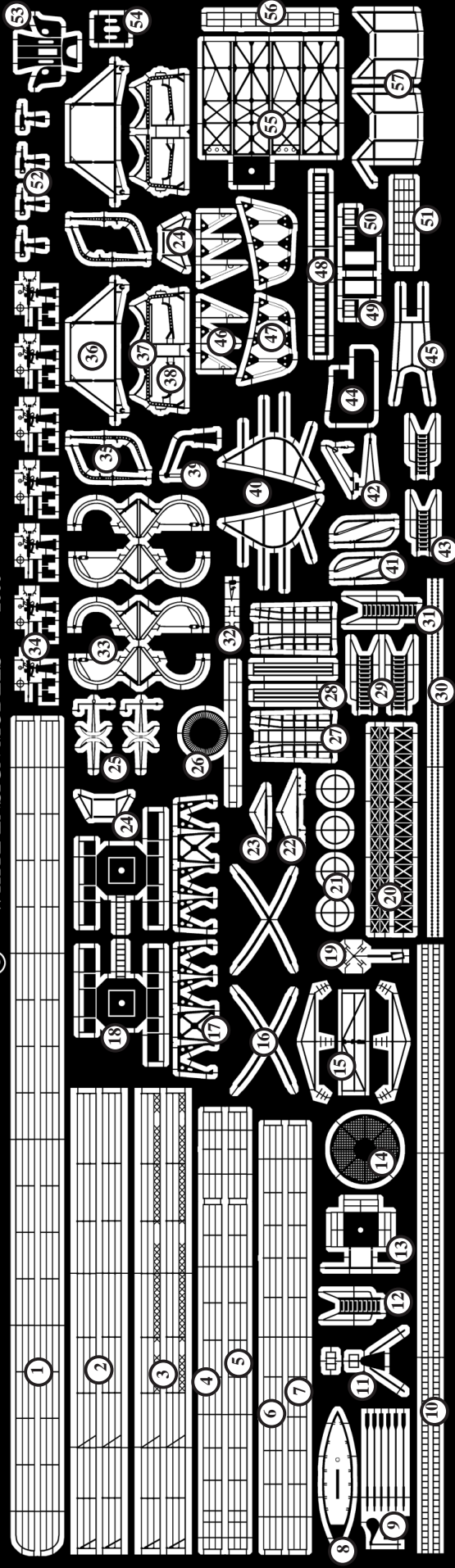

- |   |                                     |  |
|---|-------------------------------------|--|
| 1. Main Deck Railings (Aft)                     | 29. Inclined Ladders (Galley House) | 43. Inclined Ladder (Bridge Roof)          |
| 2. Foc's'le Railings                            | 30. Anchor Chain Stock              | 44. Rudder (Alternative)                   |
| 3. Foc's'le Railings (Optional)                 | 31. Inclined Ladder (Bridge)        | 45. Aft Compass Cover Frame                |
| 4. Aft Superstructure Railings                  | 32. 25' Fat Motor Boat Fittings     | 46. Prop Guard Supports (Late Fit British) |
| 5. Aft Superstructure Railings (Canvas Dodgers) | 33. Boat Davits                     | 47. Prop Guards (Late Fit British)         |
| 6. Galley Roof Railings                         | 34. 20mm Orlikon Mountings          | 48. Bridge Windows                         |
| 7. Galley Roof Railings (Canvas Dodgers)        | 35. USN Boat Skid Davits            | 49. Bridge Screen (Port Side)              |
| 8. 27' Whaler Thwarts                           | 36. USN Boat Skid Frame             | 50. Bridge Screen (Sbd Side)               |
| 9. 27' Whaler Oars and Rudder                   | 37. USN Boat Cradle Supports        | 51. Radar Lantern Frame                    |
| 10. Vertical Ladder Stock                       | 38. USN Boat Cradle Braces          | 52. 0.5" Machine Guns                      |
| 11. Bridge Front DF Antenna Platform            | 39. Torpedo Loading Davit           | 53. 4" / 50 Deck Gun Shield                |
| 12. Inclined Ladder (Aft Superstructure)        | 40. USN Style Prop Guards           | 54. 3" / 50 Deck Gun Shield                |
| 13. Searchlight Tower Platform                  | 41. DC Loading Davits               | 55. Searchlight Tower (Early USN Style)    |
| 14. Aft 3" Gun Footplate                        | 42. Bow Anchor Crane                | 56. Searchlight Tower Railing              |
| 15. 286 Radar Antenna Assembly                  |                                     | 57. Aft Carley Raft Racks                  |

**General Precautions**

- When assembling a Resin / Photoetched metal kit, certain precautions must first be taken.
1. Resin dust can be harmful if inhaled. It is recommended that you wear a suitable dust mask when drilling or sanding resin parts.
  2. Cyano adhesives (super glues) are generally used to assemble this type of kit. Care must be taken when using this type of adhesive as it will bond in seconds. Follow the advice on the container.
  3. Wash resin parts in a solution of warm soapy water before assembly. This will remove any residual mold release agents and ensure a good key for painting.
  4. Soak photoetch parts in a suitable solvent, such as white spirit, to degrease the surfaces prior to painting.

## Main Component Location

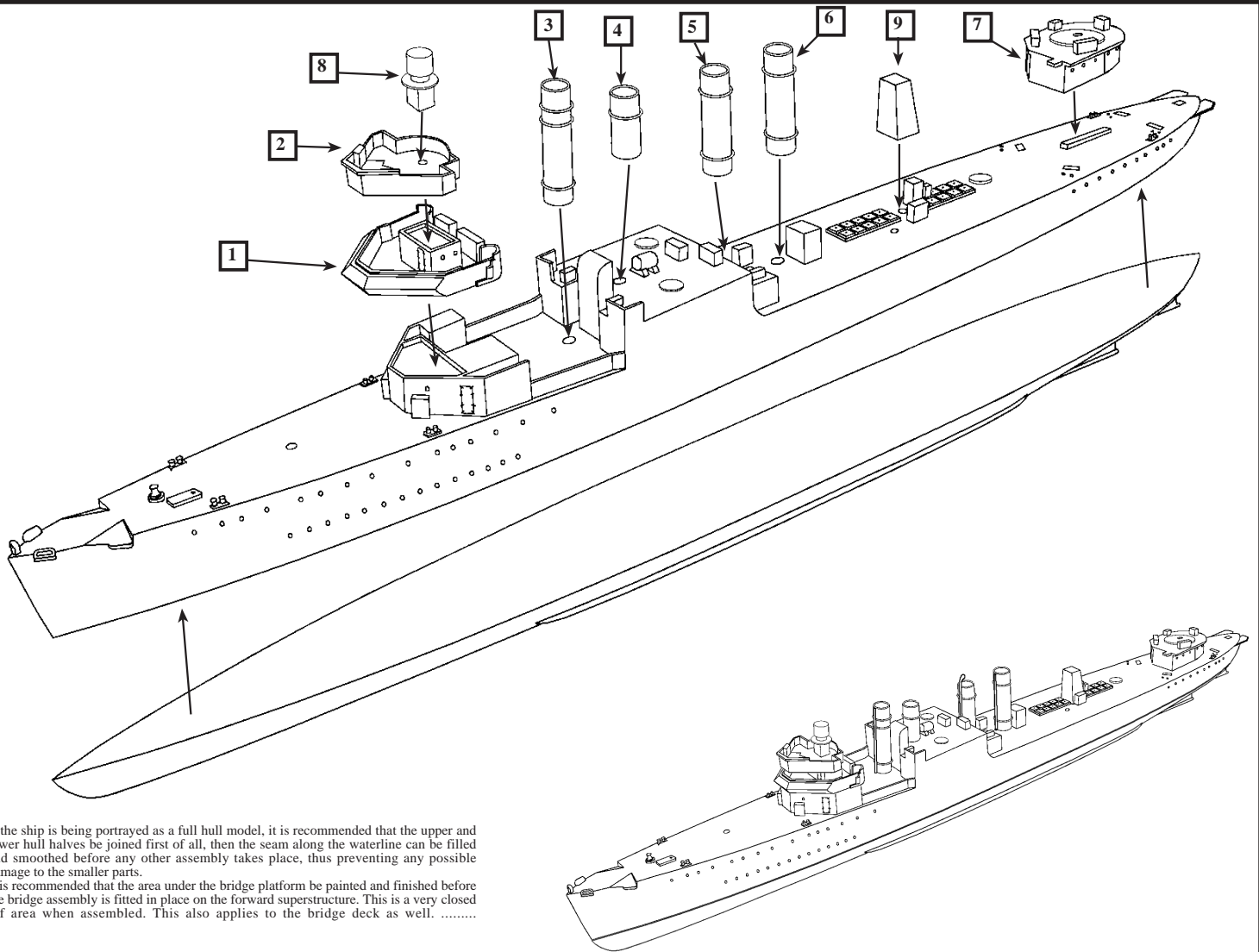

If the ship is being portrayed as a full hull model, it is recommended that the upper and lower hull halves be joined first of all, then the seam along the waterline can be filled and smoothed before any other assembly takes place, thus preventing any possible damage to the smaller parts.

It is recommended that the area under the bridge platform be painted and finished before the bridge assembly is fitted in place on the forward superstructure. This is a very closed off area when assembled. This also applies to the bridge deck as well. ....

### 4"/50 Deck Gun Assembly

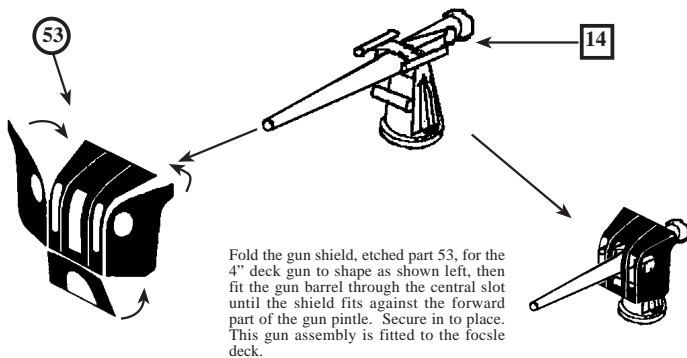

### 3"/50 Deck Gun and Shield

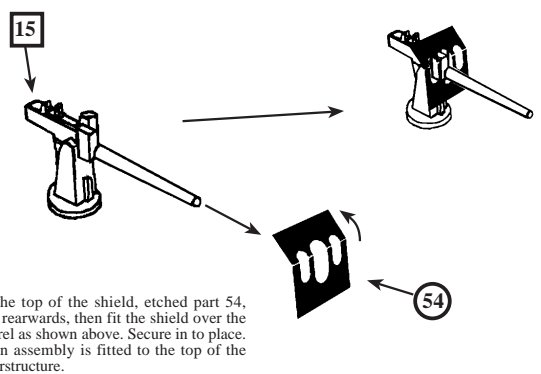

### 20mm Oerlikon

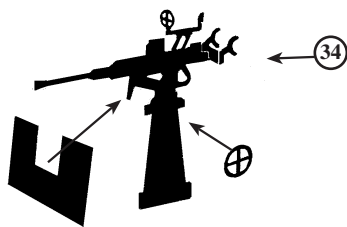

Assemble the single 20mm Oerlikons, etched parts 34, by first twisting the should braces round to 90° then bending the arms back so that they are parallel. Fit the shield into position centrally on the spigot below the barrel.

These gun mountings are located on the platforms on each side of the galley roof and on platforms located on the main deck amidships.

### Main Deck AA Gun Platforms Assembly

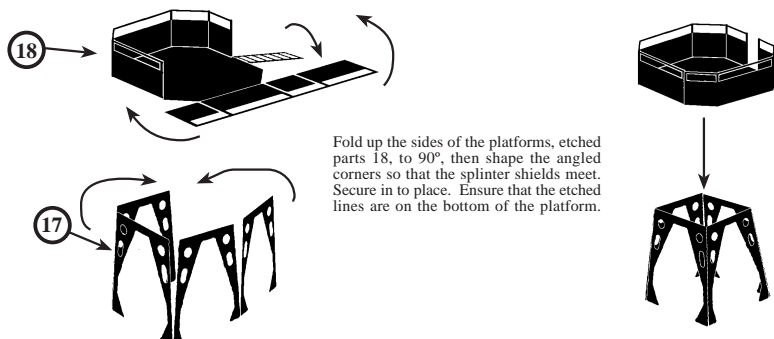

Fold the legs of etched parts 17 around in 90° stages until the two ends meet and form a square section. Taper the tops of the legs inwards and secure into place.

Fit the gun platform to the top of the legs, using the etched lines on the bottom of the platform as a guide.

### Fo'c'sle Details

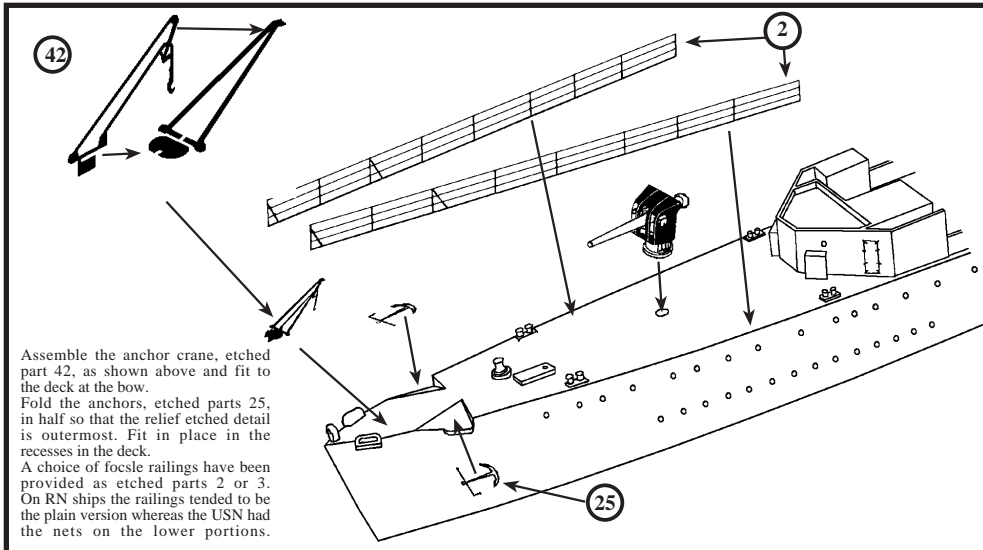

Assemble the anchor crane, etched part 42, as shown above and fit to the deck at the bow.  
 Fold the anchors, etched parts 25, in half so that the relief etched detail is outermost. Fit in place in the recesses in the deck.  
 A choice of focsle railings have been provided as etched parts 2 or 3. On RN ships the railings tended to be the plain version whereas the USN had the nets on the lower portions.

### Radar Lantern Assembly

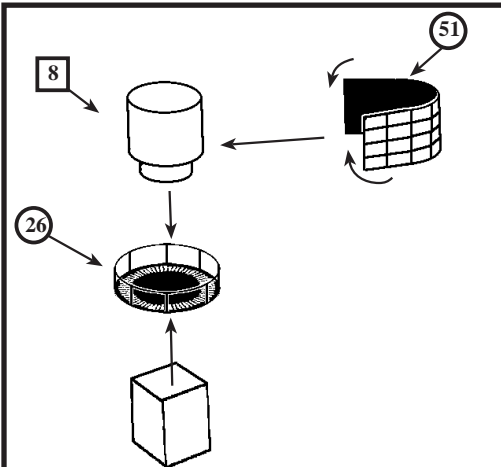

Although resin part 8 already has a circular platform fitted around the radar lantern it may be desired to fit a finer one in its place. Cut the lantern from the top of the platform then remove the resin platform completely. Re fit the lantern to the etched part 26, then fit to the deck house.

### Bridge Assembly

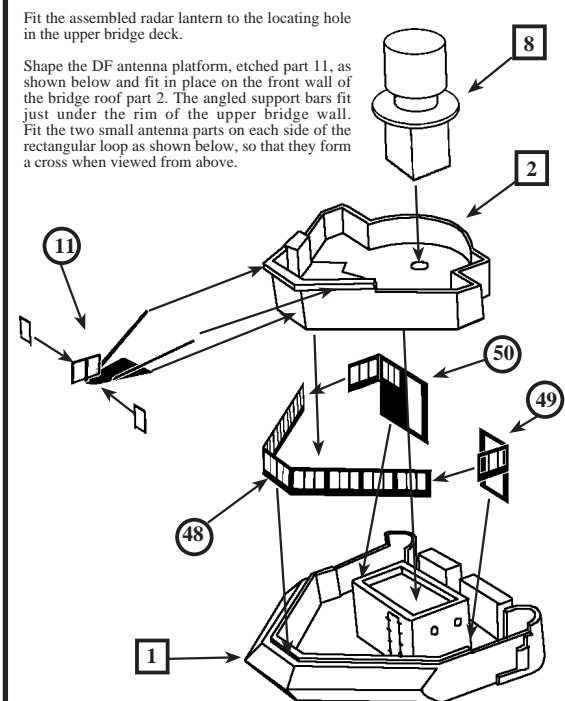

Fit the assembled radar lantern to the locating hole in the upper bridge deck.

Shape the DF antenna platform, etched part 11, as shown below and fit in place on the front wall of the bridge roof part 2. The angled support bars fit just under the rim of the upper bridge wall. Fit the two small antenna parts on each side of the rectangular loop as shown below, so that they form a cross when viewed from above.

Assemble bridge by shaping the forward window strip, etched part 48, and fit it against the raised ridge on the lip of the bridge wall. Shape the bridge rear screens and entry door sections 49 and 50 and fit so that the windows continue round until the entry door sections are folded to 90° and fitted into the bridge well. Fit the bridge roof, resin part 2, so that the raised rectangle on the underside locates into the corresponding recess on the bridge deckhouse. It is recommended that the bridge area is painted out to the desired finish before the roof part is fitted in to place.

### 286 Radar Antenna

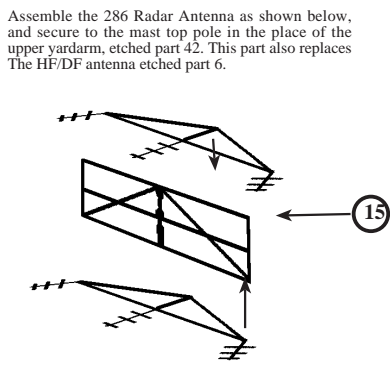

Assemble the 286 Radar Antenna as shown below, and secure to the mast top pole in the place of the upper yardarm, etched part 42. This part also replaces the HF/DF antenna etched part 6.

### 291 Radar Antenna

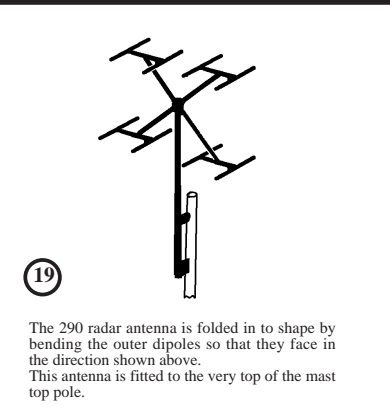

The 290 radar antenna is folded in to shape by bending the outer dipoles so that they face in the direction shown above. This antenna is fitted to the very top of the mast top pole.

### Mast Assembly

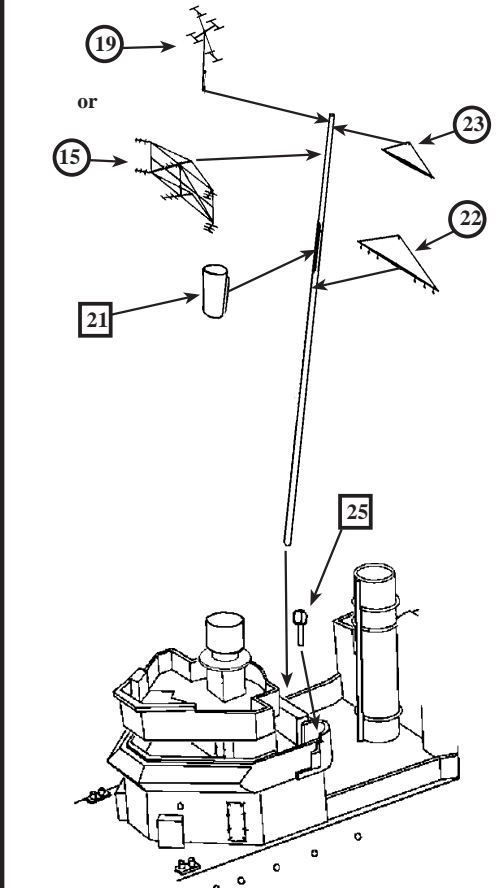

To make a mast, first cut a 74mm length of 1mm (40 thou) diameter brass rod. The rod will need to be gently tapered using a file, and spinning in a modellers drill chuck, until the upper part of the mast is around .5mm. The thicker part of the mast pole is then fitted in to the recess in the main deck and the mast is then secured to the recess between the flag lockers on the rear of the bridge deck.  
 Fit the crow's nest so that the top of the nest is 23 mm from the top of the mast.  
 Fit the yardarms so that the small yardarm, etched part 23 is at the top of the mast. Fit the larger yardarm so that it is just below the crow's nest.  
 Fit either the 291 or the 286 radar antennas, but not both. The 286 antenna was fitted first then replaced in 1943 by the 291.

### Galley Roof Gun Deck Details

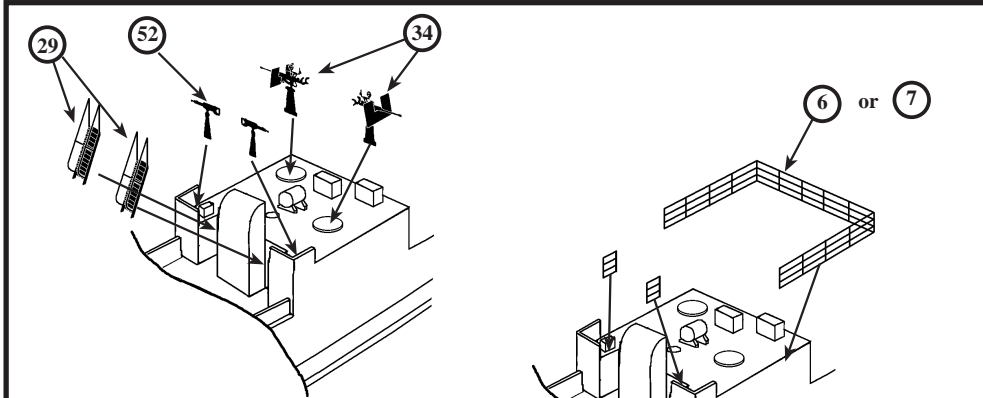

Shape and fit the two ladders, etched parts 29, to each side of the crew shelter, leading down from the galley roof.  
 Fit the 0.5" machine guns to the positions forward on the galley roof within the small splinter shields.  
 Fit the assembled 20mm Oerlikon mountings to the circular footplate's on the galley roof deck.  
 Shape and fit the section of railing 6 or 7 as desired to the rear and sides of the galley roof deck.

### Funnel Cap Grills

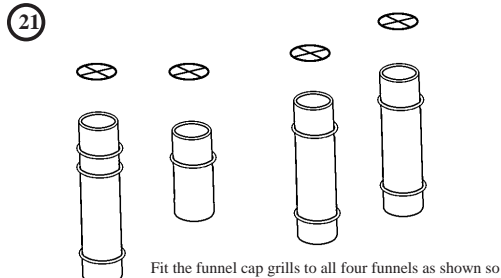

Fit the funnel cap grills to all four funnels as shown so that the crosses run fore and aft and athwartships.

### Main Deck Parts Location

Fold the railings and antenna spreader on the searchlight platform to shape as shown below.

Fit the searchlight platform centrally to the top of the searchlight tower, so that the wire spreader is forward.

Fit the assembled AA gun platforms in to place at the locations shown below. Make sure that the access ladders are positioned inboard.

Fit the triple torpedo tube mounting to the raised circle on the deck, then fit the davit, etched part 13, to starboard side forward of the tubes.

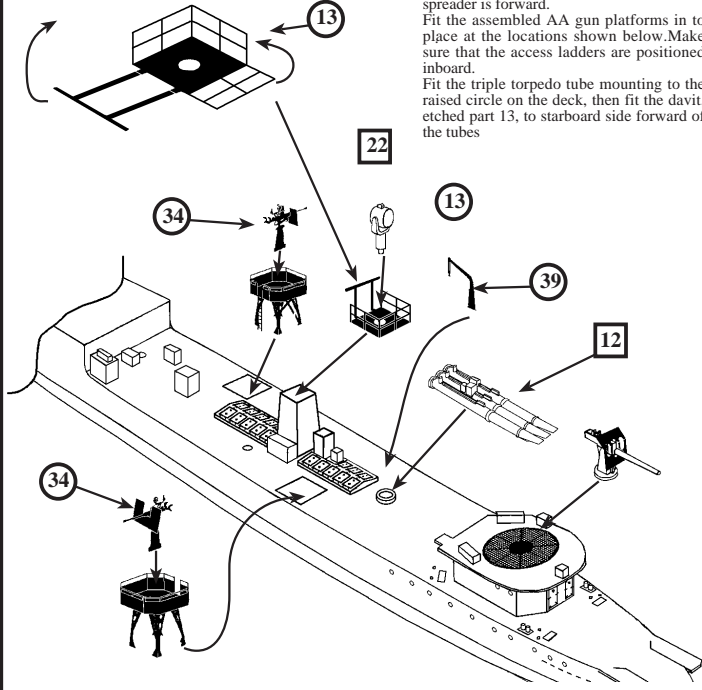

### Carley Raft Rack Locations

Fold and fit the Carley Raft Racks, etched parts 57, as shown and fit to each side of the aft superstructure, with the rack with the extended arm going to the starboard side and the arm attaching to the deck half way along the angled section.

Fold and fit etched parts 24, and fit to the positions shown amidships. Note the port rack is located directly between the boat davits on that side, whereby on the starboard side the rack is aft of the boat davits.

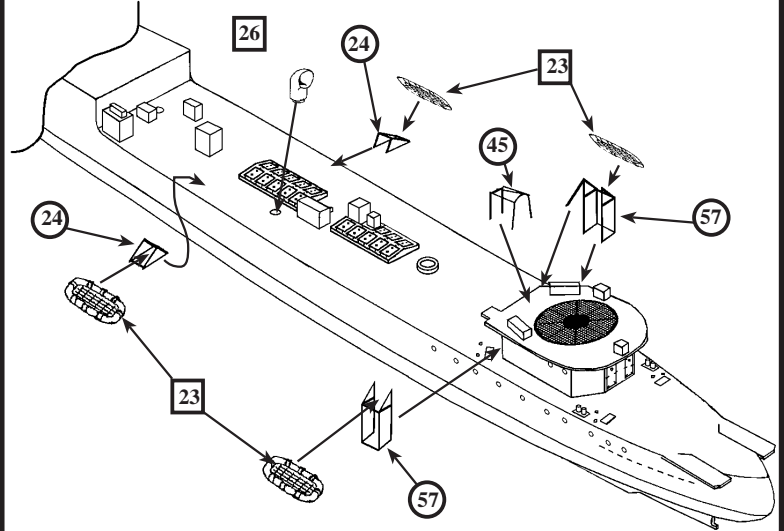

### Boats Assembly

To assemble the davits, fold each one of etched parts 33, along the etched line at the base of the davit, so that the two sides meet and are secured in place with glue. Ensure that the etched detail is facing outward.

Attach the photo etched boat details as shown left and below. Replacement thwart for the 27' Whaler are also provided as etched part 8, so that the molded ones can be removed.

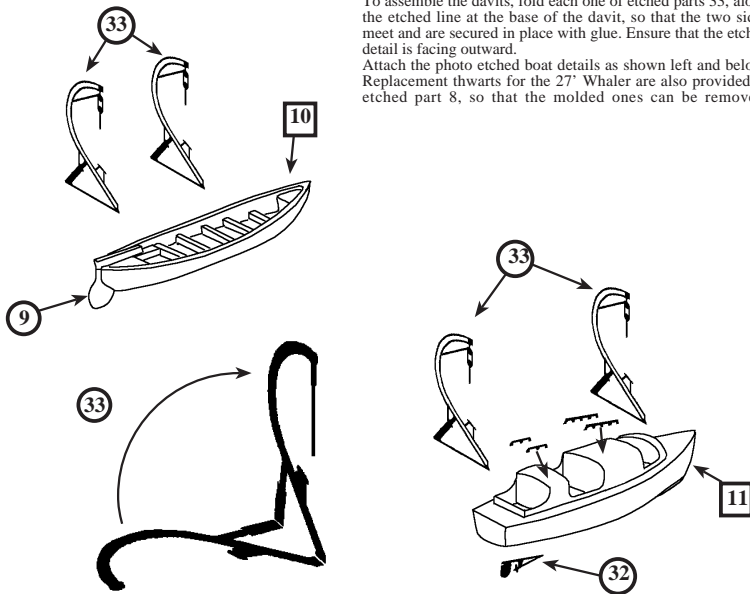

### Boats Location

Fit the 27' Whaler and davit assembly to the starboard side of the main deck just aft of the galley step.

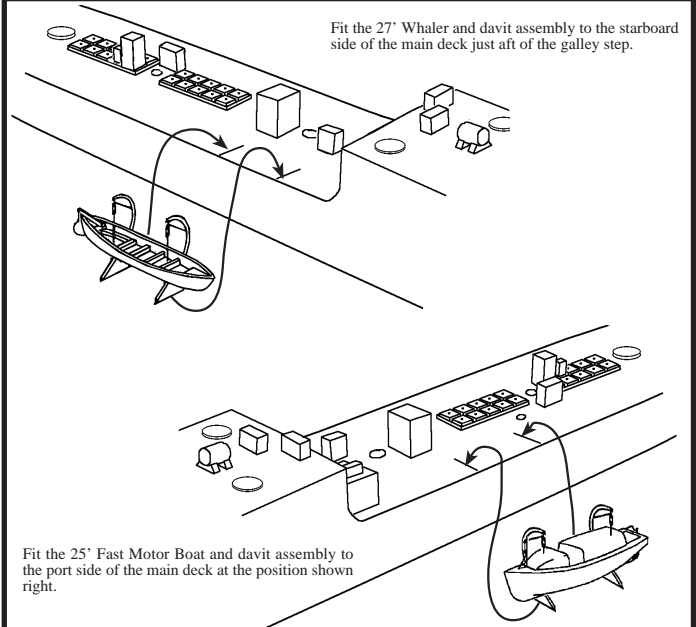

### Aft Deck House Details

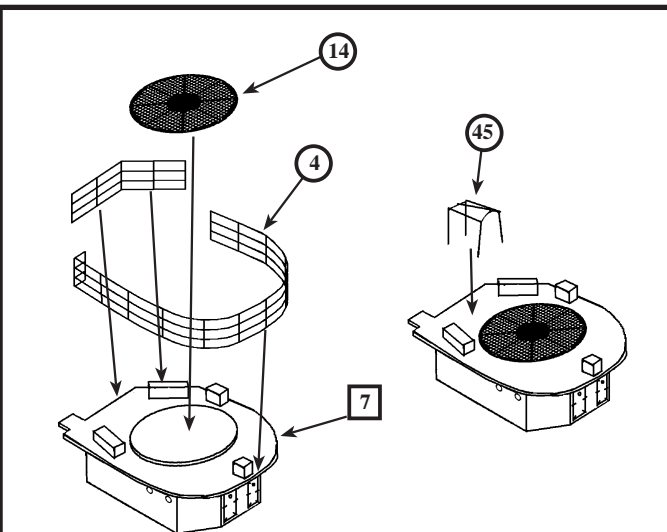

Shape and fit the railings etched parts 4 or 5, to the edges of the aft superstructure deck. Alternative railings with canvas dodgers fitted have been supplied so they can be fitted if desired. Shape and fit the auxiliary compass position cover frame, etched part 45, to the forward central part of the aft superstructure deck.

### Depth Charge Thrower Location

Fit the depth charge throwers, resin parts 17, on to the raised rectangles on the deck as shown.

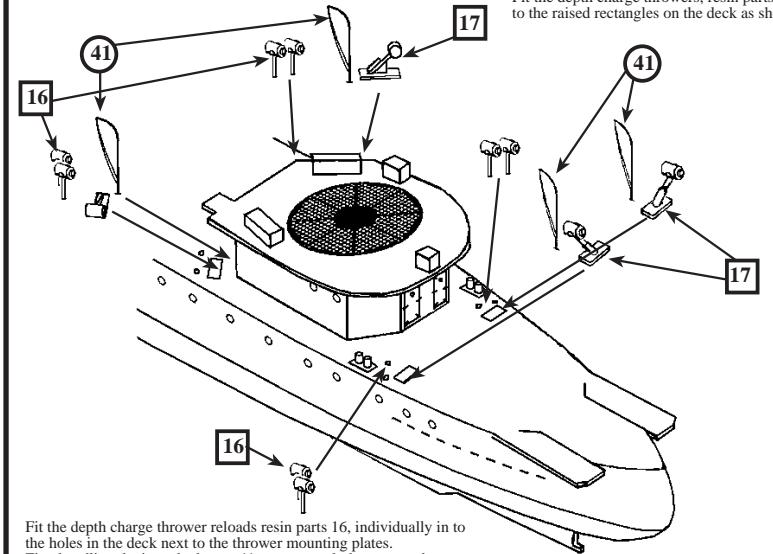

Fit the depth charge thrower reloads resin parts 16, individually in to the holes in the deck next to the thrower mounting plates. Fit a handling davit, etched parts 41, next to each thrower as shown.

## Depth Charge Rails Assembly and Location

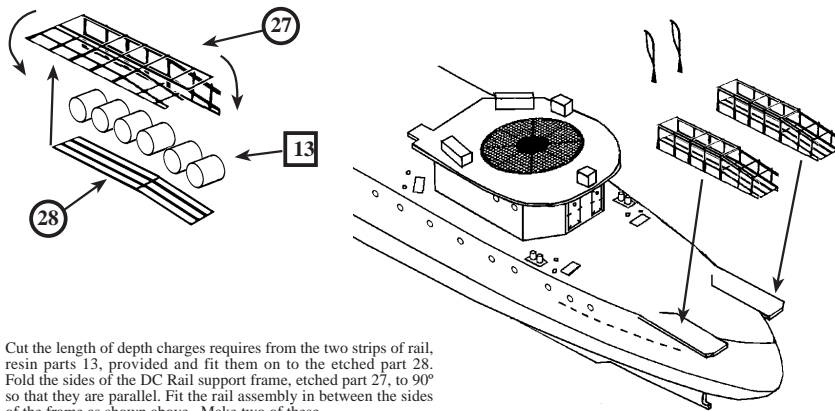

Cut the length of depth charges requires from the two strips of rail, resin parts 13, provided and fit them on to the etched part 28. Fold the sides of the DC Rail support frame, etched part 27, to 90° so that they are parallel. Fit the rail assembly in between the sides of the frame as shown above. Make two of these. Fit the depth charge rail assemblies to the deck extensions on the ships stern as shown right.

## Propeller Guards

A choice of propeller guard frames has been supplied in this set. Etched parts 46 & 47 are of a British design and fitted to some ships after they had been transferred to the Royal Navy. It does not seem that HMS Montgomery was fitted with the late type, though they may be used if another ship of the class is being modelled.

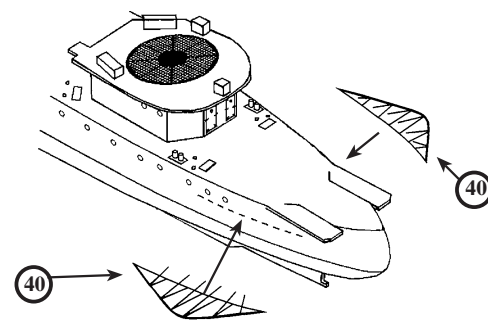

Fit the USN Pattern propeller guard frames to the ships side half way down, then fold the support bars over the top so that the ends locate just below the edge of the deck. This type of guard was fitted to HMS Montgomery

## Propeller Guards (Late)

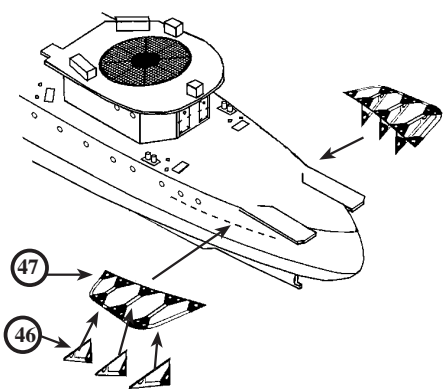

Fit the propeller guard frames to the ships side aft to a position just below the edge of the deck and just forward of the depth charge rail sponson. Fit the three support frames to the underside of the three inner spacer bars.

## Propeller and Rudder Assembly

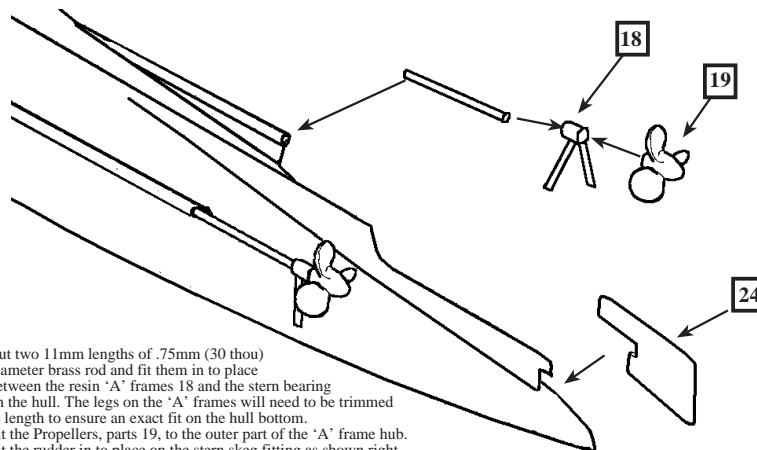

Cut two 11mm lengths of .75mm (30 thou) diameter brass rod and fit them in to place between the resin 'A' frames 18 and the stern bearing on the hull. The legs on the 'A' frames will need to be trimmed to length to ensure an exact fit on the hull bottom. Fit the Propellers, parts 19, to the outer part of the 'A' frame hub. Fit the rudder in to place on the stern skeg fitting as shown right.

## Boat Skids Assembly

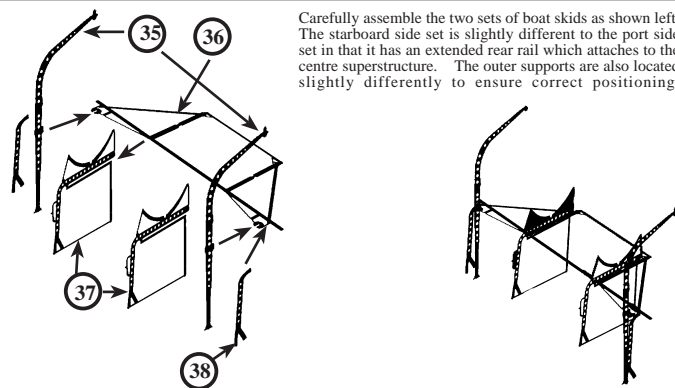

Carefully assemble the two sets of boat skids as shown left. The starboard side set is slightly different to the port side set in that it has an extended rear rail which attaches to the centre superstructure. The outer supports are also located slightly differently to ensure correct positioning.

Assemble the centre supports/ boat cradles to the frame by sliding the bars on the frame into the slots below the cradles. Secure with superglue. Ensure the centre supports are vertical then place assembly on a flat surface. Trim the outer supports if necessary and fit under etched line next to the davit slot. Fit the boat davits into the slots as shown above. The finished assembly should appear like that in the picture above right.

## USN Type Searchlight Tower

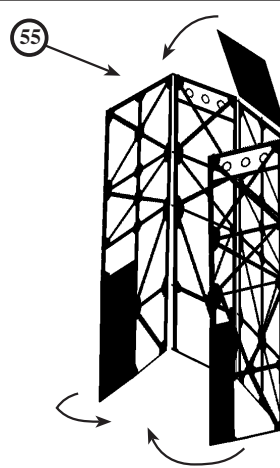

Fold the side panels of etched part 26 around to form a box then secure the mating edges in place. Fold the top platform down to fit flat on top of the tower. Railing section, etched part 27, may be used to fit around the top platform.

## OTHER INSTRUCTIONS

1. Fit railings sections, etched parts 1, to each side of the main deck so that the curved ends fit against the curved fairing at the base of the galley step. The railings are tailored to fit as far aft, along the sides of the ship, as the depth charge rails.
2. Vertical Ladder stock has been supplied, etched part 10, so that any vertical ladders, such as that which runs up the mast to the crows nest, may be fitted. Inclined ladder 31 is shaped and fitted to the main deck running up to the bridge deck on the starboard side. Inclined ladder 43, runs from the bridge deck up to the bridge roof, just forward of the ladder 31. Inclined ladder 12 runs from the main deck aft, to the small landing on the forward edge of the aft superstructure.
3. Anchor chain, etched part 30, is included to be fitted to the fore deck if desired, or used if the ship is to be modelled at anchor.
4. It may have already been noted that some parts have been included in the etched details, that are from the USN variant of this ship. This is so that anyone who wishes to model the Montgomery as she was when the US Navy handed her over to the RN, can do so with a little further research.
5. References available to assist you with your build are as follows. US Flush Deck Destroyers in Action. Warships No19. The excellent WR Press publication Flush Deck Destroyers of World War Two by Glenn R Arnold also includes a pull out plan and profile by Alan Raven that was used to assist in the making of this kit

COLOUR CHART & PAINTING GUIDE

MS1  
Colourcoats  
RN 04

MS2  
Colourcoats  
RN 05

Pale Blue/Green  
50/50  
Colourcoats  
RN08/RN09

White  
Colourcoats  
RN 10

Anti Fouling  
Red  
Colourcoats  
RN19

Corticene  
Colourcoats  
RN24

Steel Deck Grey  
Colourcoats  
RN05 MS2

HMS Montgomery 1943

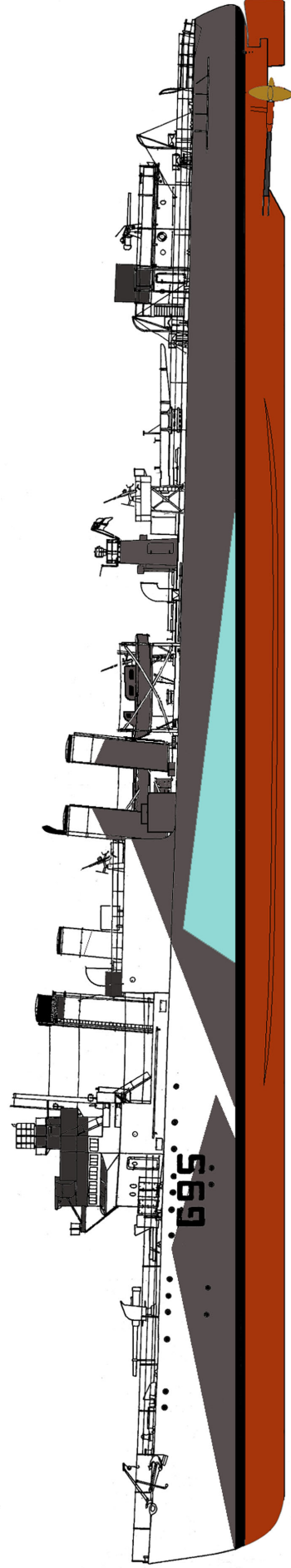
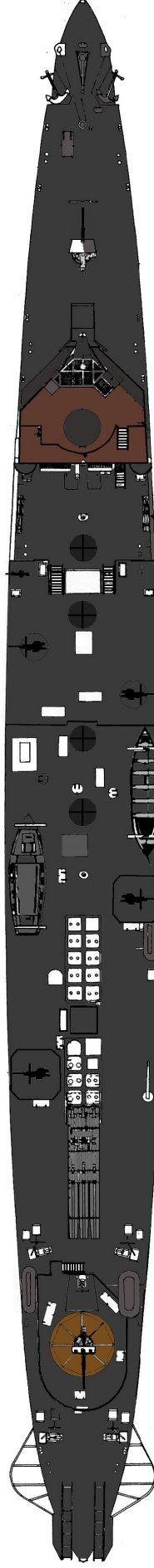
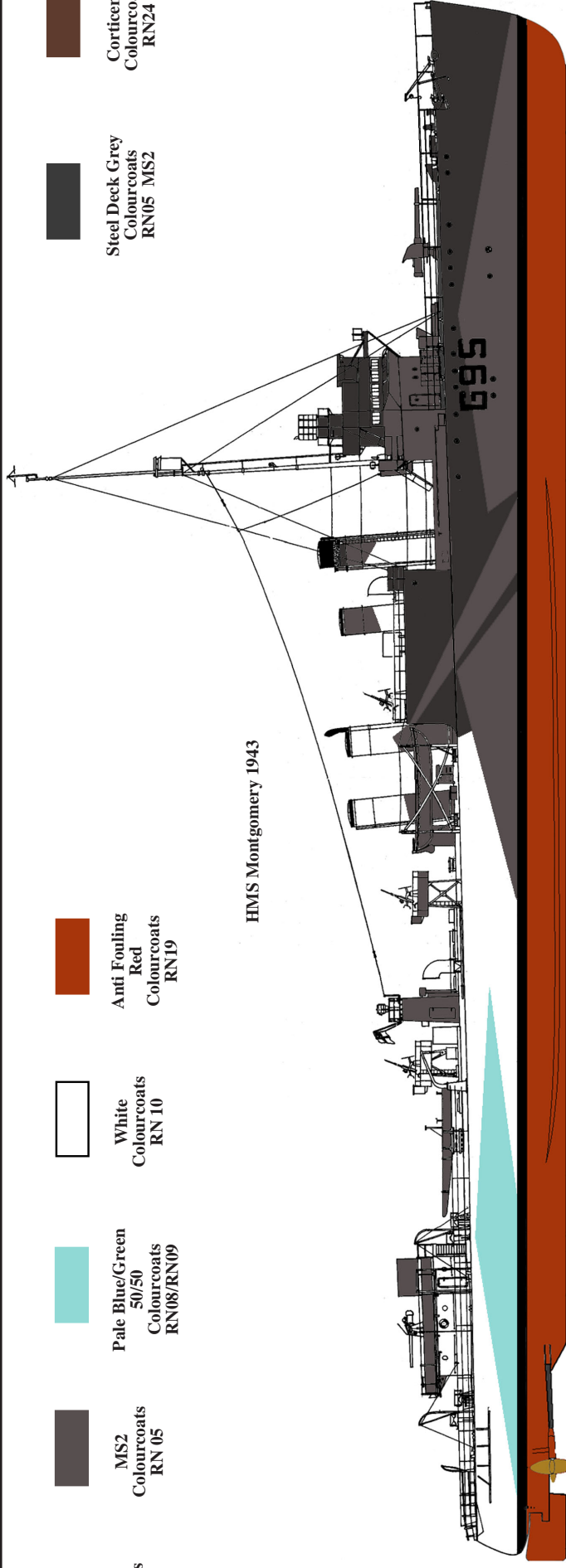

ATLANTIC MODELS © 2016

1 Hillview Grove, Easington, Durham, SR8 3NT, UK Tel. 0191 5271574  
e.mail: peter@atlanticmodels.net Website <http://www.atlanticmodels.net>