

**History**

*HMS Scorpion* was laid down as one of the 'S' class of destroyers by Cammell Laird shipbuilders on 19th June 1941. She was launched 26th August 1942 and Commissioned in 11th May 1943. Initially she served with the Home Fleet alternating with other ships of her class on Arctic convoy duties until December 1943 when she and her sister ships formed the Destroyer screen around *HMS Duke of York* and *HMS Jamaica* whilst taking part in the Battle of North Cape, during which the German Battleship *Scharnhorst* was sunk. After the war *Scorpion* was transferred to the Netherlands Navy for service in the far east, and renamed *Kortenaer*.

**Specifications**

Length: 362ft 9in oa. Beam: 35ft 8in Displacement: 1,808 tons standard 2,530 tons full load. Speed: 36 knots max

Armament: 4 x 4.7inch QF guns in single MkIX mountings. 8 x 21inch Torpedo Tubes in two quadruple mounting. Depth Charges from 2 stern rails and 4 Mk 11 depth charge throwers. 5 x 20mm Twin Oerlikon Powered mountings one of which was later replaced with..1 x Twin 40mm Hazemeyer Mounting

This kit contains a mixture of resin and photo etched metal small parts, of which some of the resin parts have been attached to sprues for ease of casting. Care must be taken when detaching the parts from the sprues, to remove the flash without causing damage. When cleaning off the excess material using files or abrasive paper, it is recommended that a mask is worn as resin dust can be harmful to health if inhaled.

**Resin and Metal Parts Identification**

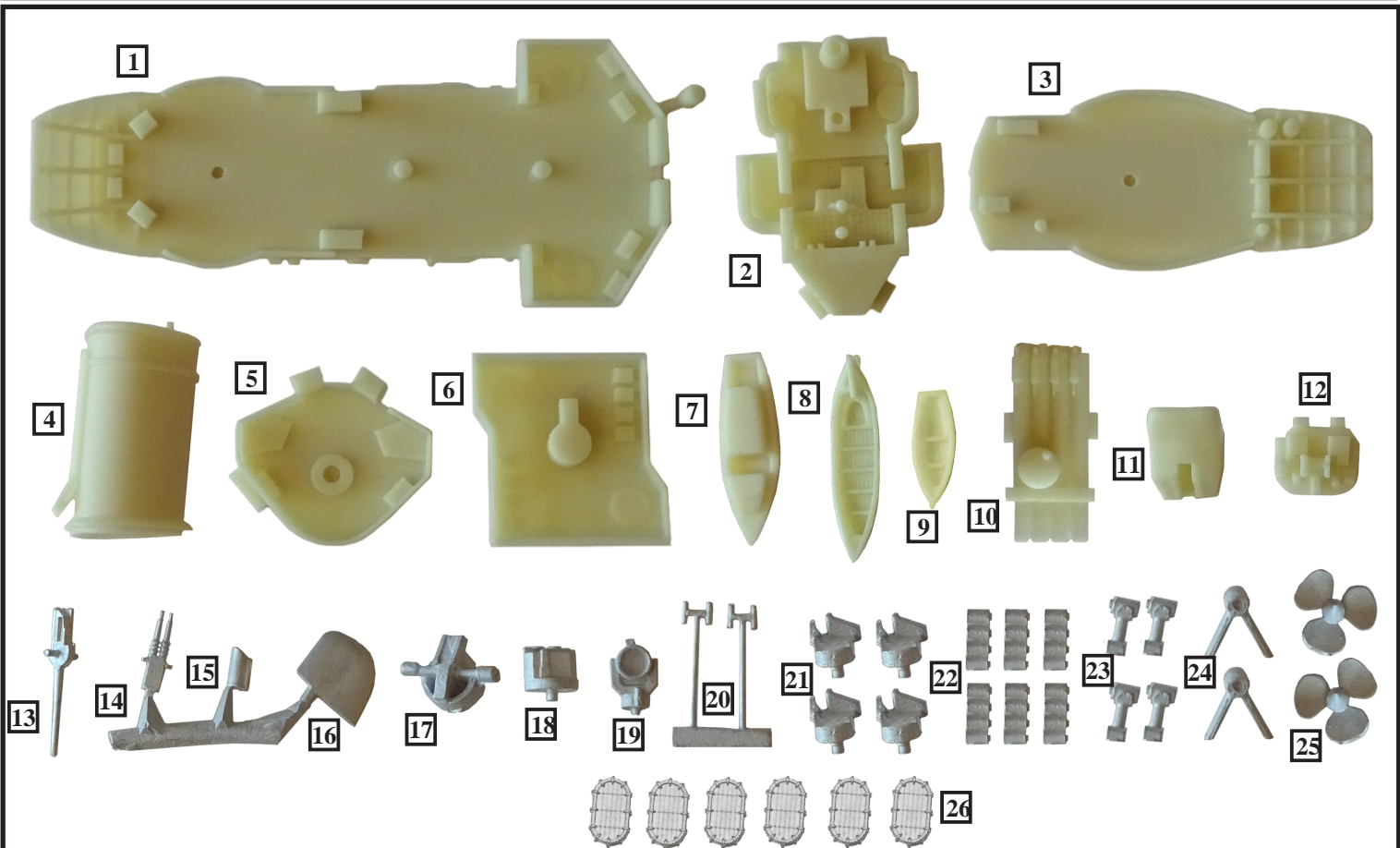

- |                           |                                   |                                  |
|---------------------------|-----------------------------------|----------------------------------|
| 1. Forward Superstructure | 10. 21" Torpedo Tubes             | 19. Searchlight Projector        |
| 2. Bridge                 | 11. 4.7" Gun Mounting Mk XXII x 4 | 20. Stove Pipes                  |
| 3. Aft Superstructure     | 12. 40mm Bofors Twin Mounting     | 21. Twin 20mm Oerlikon Mountings |
| 4. Funnel                 | 13. 4.7" Gun Barrel x 4           | 22. Depth Charge Rails           |
| 5. Hazemeyer Platform     | 14. 40mm Twin Bofors Barrels      | 23. Depth Charge Throwers        |
| 6. 20mm AA Platform       | 15. Crows Nest                    | 24. Propeller A Frames           |
| 7. 25' Motor Cutter       | 16. Rudder                        | 25. Propellers (Pair)            |
| 8. 27' Whaler             | 17. HACs Mk3 Director             | 26. Carley Rafts                 |
| 9. 16' Dinghy             | 18. Director Control Tower (DCT)  |                                  |

## Photo Etched Parts Identification

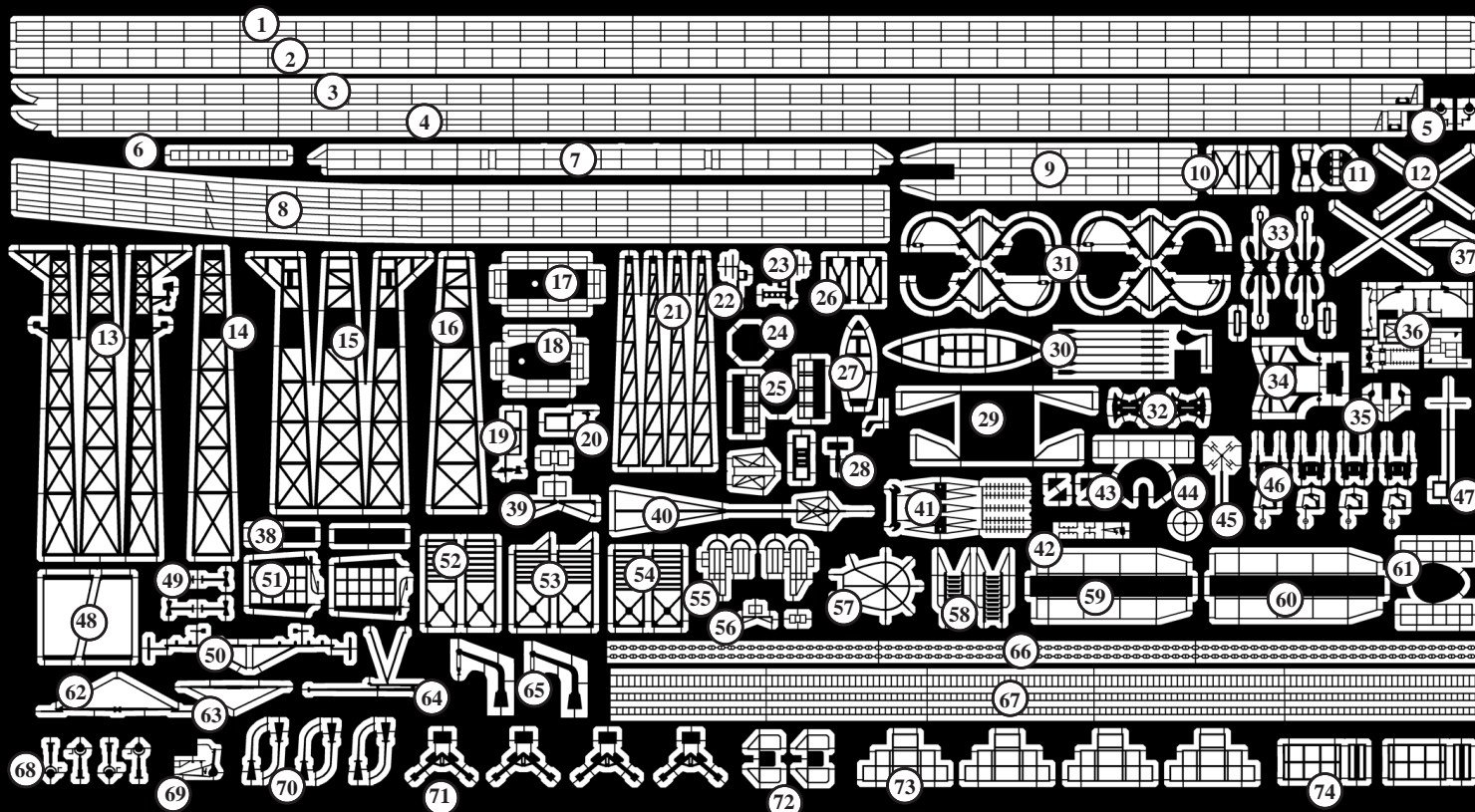

- |  |   |                                  |                                  |
|--|---|----------------------------------|----------------------------------|
| 1. Standard 3 Bar Railing Stock        | 19. Mast Top Platform Fwd Yard            | 38. Depth Charge Rail Plates     | 57. Funnel Cap Grill             |
| 2. 2 Bar Railing Stock                 | 20. Mast Top Platform Fwd Yard (Vigilant) | 39. Bridge Front DF Antenna      | 58. Hull Step Inclined Ladders   |
| 3. Railings (Main Deck Stbd)           | 21. Main Mast Lattice                     | 40. MF/DF Antenna Pole           | 59. Forward Topredu Tube Catwalk |
| 4. Railings (Main Deck Port)           | 22. IFF Interogator Antenna               | 41. 285 Radar Yagi Antenna       | 60. Aft Topredu Tube Catwalk     |
| 5. Signal Lamps                        | 23. IFF Interogator Antenna               | 42. Motor Boat Fittings          | 61. Searchlight Platform         |
| 6. Bridge Windows                      | 24. Radar Lantern Base Plate              | 43. HACs Director Catwalk        | 62. Tripod Fore Mast Lower Yard  |
| 7. Railings (Aft Gun Deck)             | 25. 276 Radar Lantern                     | 44. Searchlight Lens Cross       | 63. Tripod Fore Mast Upper Yard  |
| 8. Railings (Fo'c'sle)                 | 26. Forward Gun Platform Supports         | 45. 291 Radar Antenna            | 64. Jack Staff                   |
| 9. Railings (Forwad Gun Deck)          | 27. 16' Dinghy Thwarts and Rudder         | 46. 20mm Twin Oerlikon Parts     | 65. Torpedo Loading Cranes       |
| 10. Bridge Extension Supports          | 28. 276 Radar Antenna                     | 47. Tripod Fore Mast Top Antenna | 66. Anchore Chain                |
| 11. 293 Radar Antenna                  | 29. Bridge Canopy                         | 48. Tripod Fore Mast Leg Spacers | 67. Stock Vertical Ladder        |
| 12. Boat Restrainer Straps             | 30. 27' Whaler Thwarts and Rudder         | 49. IFF Transponders             | 68. Signal Lamps (Large)         |
| 13. Fore Mast Lattice (Scorpion)       | 31. Boat Davits                           | 50. Lattice Mast Yardarms        | 69. Motor Boat Running Gear      |
| 14. Fore Mast Front Lattice (Scorpion) | 32. 16' Dinghy Cradles                    | 51. Depth Charge Rail Cages      | 70. Depth Charge Loading Davits  |
| 15. Fore Mast Lattice (Vigilant)       | 33. Anchors                               | 52. Carley Raft Rack (Forward)   | 71. Depth Charge Throwers (Alt)  |
| 16. Fore Mast Front Lattice (Vigilant) | 34. Stern TSDS Gantry                     | 53. Carley Raft Rack (Mid)       | 72. Fune Siren Platforms         |
| 17. Mast Top Platform (Scorpion)       | 35. Funnel Sirens                         | 54. Carley Raft Racks (Aft)      | 73. Depth Charge Thrower Racks   |
| 18. Mast Top Platform (Vigilant)       | 36. Hazemeyer Yagi Support Frame          | 55. Flare Rocket Launcher Rails  | 74. Depth Charge Stowage Racks   |
|  | 37. Pole Main Mast Yardarm                | 56. DF Antenna                   |                                  |

## Other Instructions

- Railings, etched parts 1, have been supplied as stock length so that they can be cut to length to fit any short falls in the tailored to fit railings supplied. Also some small lengths will be required at the aft end of the focsle deck and the lower superstructure decks. Etched parts 2 are stock 2 bar railings, with both wide and close stanchions. These can be cut and combine to fit lengths of upper deck platforms and deck edges as desired.
- Etched part 67 is a stock length of vertical ladder. This can be cut in to lengths necessary to fit up mast poles as well as access platforms and sides of deck houses.
- Metal parts 20, are stove pipes. These may be fitted if desired to the roof of the aft superstructure. ( See colour guide profiles for the location)
- Etched parts 58, are the two inclined ladders that run from the main deck, up to the focsle deck at the hull step. They are located within a rectangular opening in the focsle deck overhang, so that the top of each ladder is still located against the vertical wall of the focsle.
- Anchor chain, etched part 66, is supplied in sufficient quantity to not only fit between the capstans and hawse pipes on the foc'sle, but also to provide extra should the model be portrayed at anchor with a chain running from the hawse pipe to the surface of a seascape.
- Etched parts 12, are the retaining straps that are fitted across the outsides of the ships boats between the davits. These can be cut to length to fit as necessary.
- Etched parts 27 and 30 are the fittings for the 16' Dinghy and the 27' Whaler. The thwarts and rudders are fitted in both boats in the same manner and the method is described in a later section. The oars can be cut and placed individually in the boats or rolled in to bundles for stowage on bulkheads.
- Some resin parts in this kit have been duplicated or replaced with photo etched parts, that can be used as alternatives where the casting detail has been compromised.
- References for this class of Destroyer are available in various books and on the internet. One example is the new publication by Norman Friedman called *British Destroyers and Frigates*. Other references can be found in *Destroyers of World War Two* by M.J. Whitley and if one can be obtained, the older out of print publication *British Destroyers* by Edgar March is a wealth of information.

**ATLANTIC MODELS** © 2016

1 Hillview Grove, Easington, Durham, SR8 3NT. UK Tel. 0191 5271574  
e.mail: peter@atlanticmodels.net Website <http://www.atlanticmodels.net>

## Main Parts Location Diagram

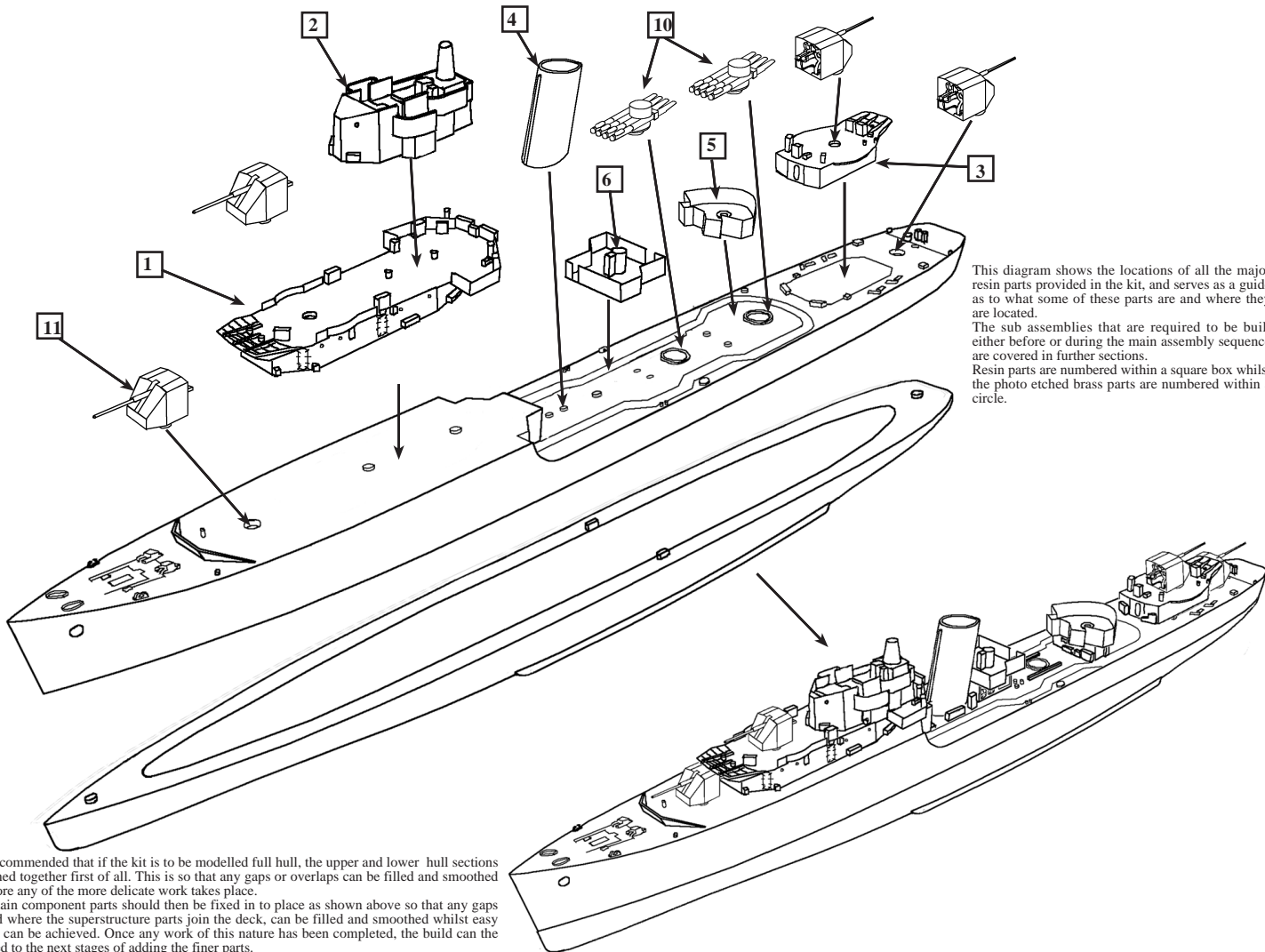

It is recommended that if the kit is to be modelled full hull, the upper and lower hull sections be joined together first of all. This is so that any gaps or overlaps can be filled and smoothed in before any of the more delicate work takes place. The main component parts should then be fixed in to place as shown above so that any gaps around where the superstructure parts join the deck, can be filled and smoothed whilst easy access can be achieved. Once any work of this nature has been completed, the build can proceed to the next stages of adding the finer parts.

### 4.7" Single Gun Mounting Assembly

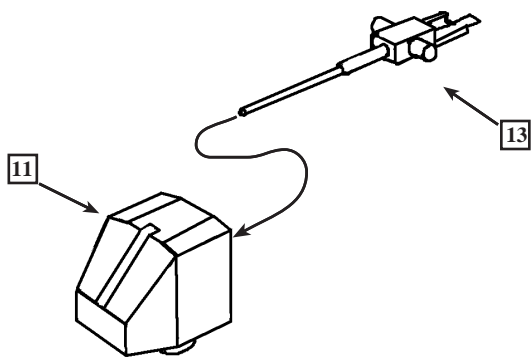

Fit the 4.7" gun, Metal part 13, so that the elevating hinges fit in to the recesses on top of the gun mounting inside the gun shield, Resin part 11. It may be necessary to clean away excess resin moulding debris from the tops of the mounting to allow the gun hinges to fit properly. Make 4 of these.

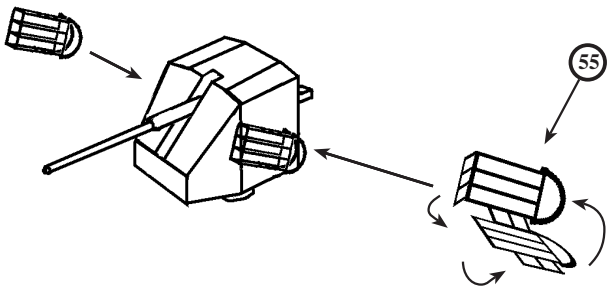

Fold the flare rocket launch rails, etched parts 55, to shape shown and fit to each side of the gun mounting in 'B' position.

### 40mm Twin Bofors Assembly (Hazemeyer)

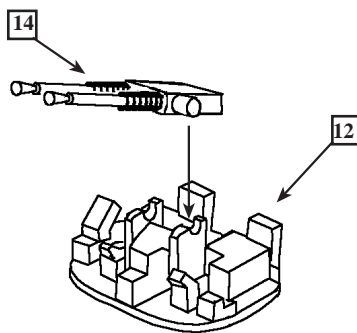

Fold the central mounting frame, part 36A, so that the sides are parallel. Fit the frame so that the main legs fit behind the gun barrels and the small forward feet fit on top of the gun body. Fit a small strip of thin (10thou) plasticard across the top of the frame on which to mount the yagi antenna as shown left. Fit the rear railings and gunsights to the positions shown.

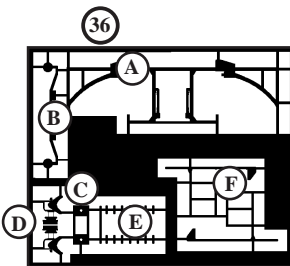

Assemble the yagi radar antennas by curving the rectangular dishes of etched parts 36C as shown. Fit the dipoles in to the holes in the centre of the dishes so that they are parallel. Fold part 36D in half so that the etched detail is outermost, then attach centrally to the two joining bars between the radar dishes.

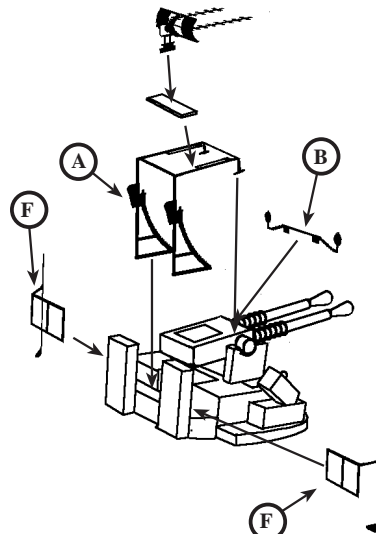
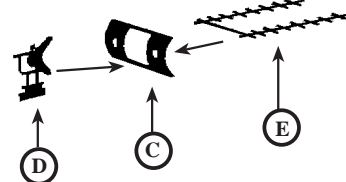



### 20mm Twin Oerlikon Mountings

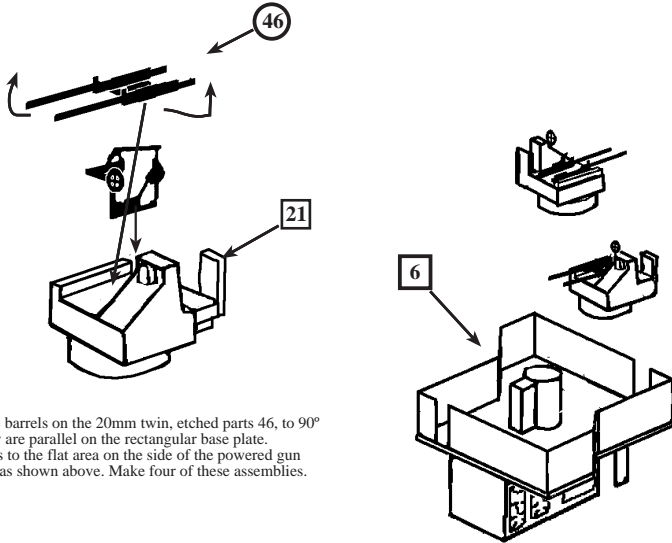

Fold up the barrels on the 20mm twin, etched parts 46, to 90° so that they are parallel on the rectangular base plate.  
Fit the guns to the flat area on the side of the powered gun mountings as shown above. Make four of these assemblies.

Remove any flash or molded bulwarks from the edges of the 20mm Oerlikon platform, resin part 6.  
Fit the platform to the ships hull so that the locating pegs and holes on the deck align.  
Fit the assembled 20mm power mountings as shown above.

### Searchlight Platform Assembly

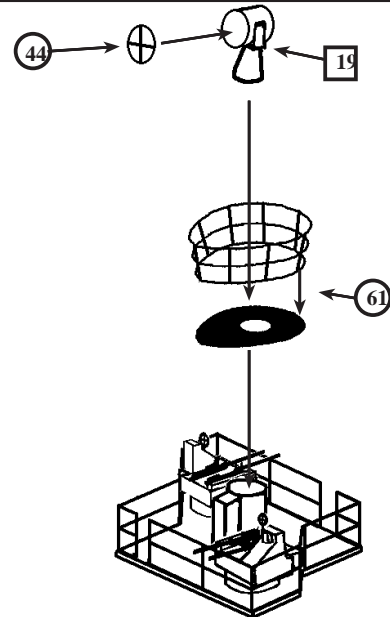

Fit the searchlight platform, etched part 61, to the mounting in the centre of the Oerlikon platform.  
Shape and fit the railing to the edge of the searchlight platform. Fit the lens cross, photo etched part 15 to the front of the searchlight as shown. Fit the searchlight so that the locating lug on the base passes through the hole in the platform and locates into the hole on the top of the platform support.

### 40mm Bofors Platform Assembly

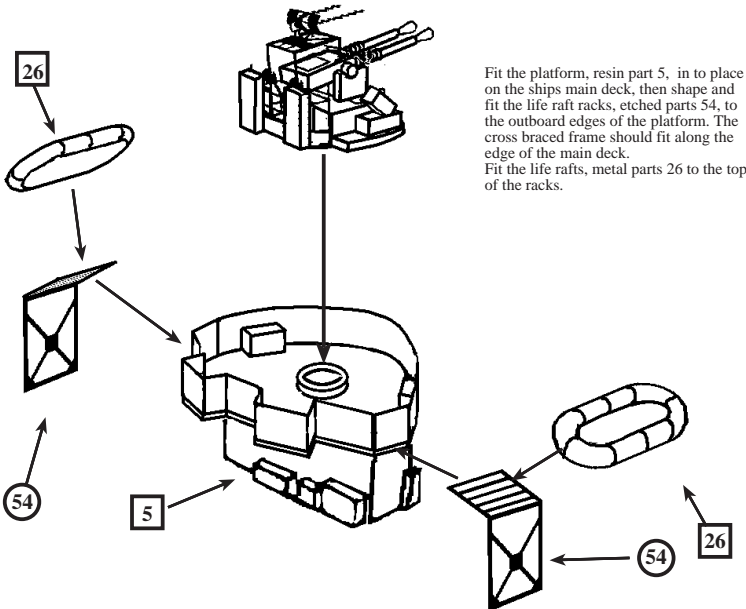

Fit the platform, resin part 5, in to place on the ships main deck, then shape and fit the life raft racks, etched parts 54, to the outboard edges of the platform. The cross braced frame should fit along the edge of the main deck.  
Fit the life rafts, metal parts 26 to the top of the racks.

### Amidships Carley Raft Racks

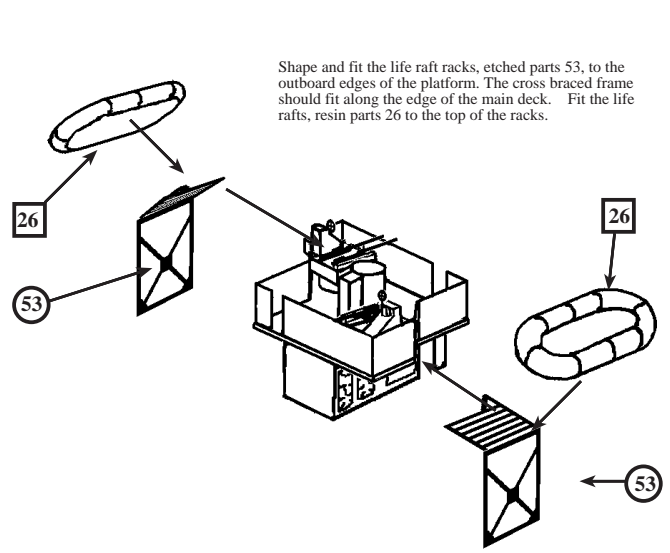

Shape and fit the life raft racks, etched parts 53, to the outboard edges of the platform. The cross braced frame should fit along the edge of the main deck. Fit the life rafts, resin parts 26 to the top of the racks.

### 285 Radar Yagi Antenna

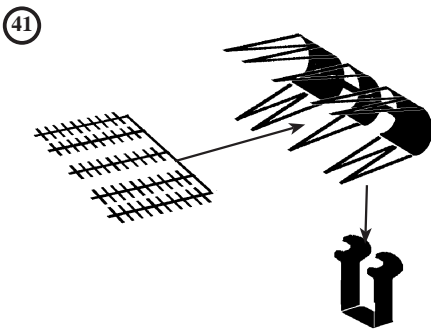

Assemble the 285 Fire Control antenna by folding a gentle curve on to the rectangular reflectors then folding over the stays so that they face forwards.  
Fit the set of dipoles centrally on to the reflector faces.  
Nip the pointed ends of the stays together so that they trap the centre bar of the dipoles between them. Fit the mounting arms to the spindles between the reflectors.  
The complete assembly then fit on to the top of the HACs director metal part 17, so that the points face over the front of the director.

### Bridge Fittings Location

Shape and fit the bridge canopy, etched part 29, if desired. This is an optional part that was not always fitted.

Fit the directors, supplied as kit parts, in to place as shown below  
Shape and fit the HACs director access platform, etched part 43, to the HACs tower. Stock lengths of ladder, etched part 67 may be used at each end of this platform assembly.

Fit the bridge windscreen panel, etched part 6, in to place as shown

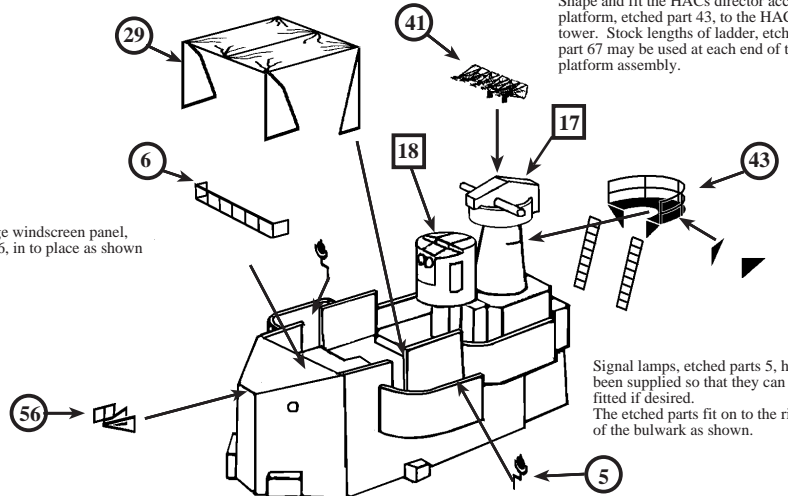

Shape and fit the bridge front DF antenna, etched part 56, as shown above.

Signal lamps, etched parts 5, have been supplied so that they can be fitted if desired.  
The etched parts fit on to the rim of the bulwark as shown.

### Forward Superstructure Fittings

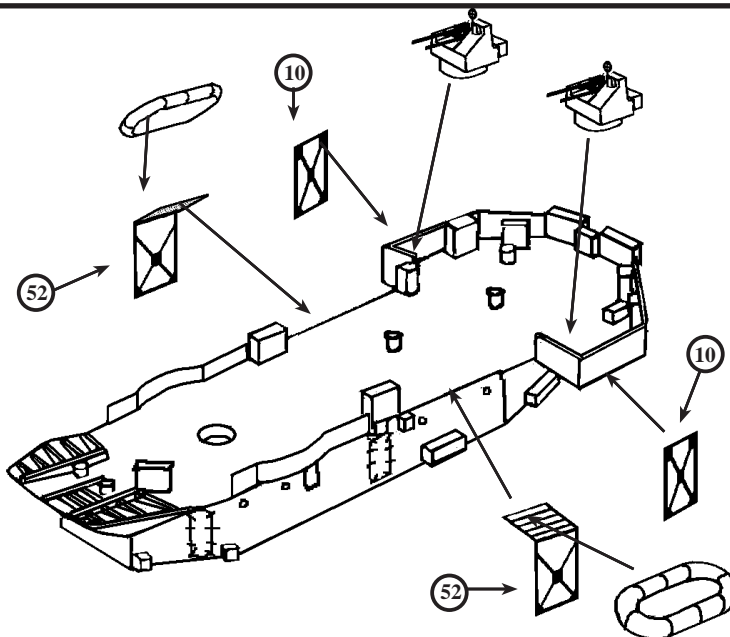

Shape and fit the life raft racks, etched parts 52, to the outboard edges of the gun deck. The cross braced frame should fit along the edge of the main deck. This is an alternative position for these racks. Fit the gun platform supports, etched parts 10, under the Oerlikon platform extensions, so that the lower edge fits along the edge of the main deck.

### 291 Radar Antenna

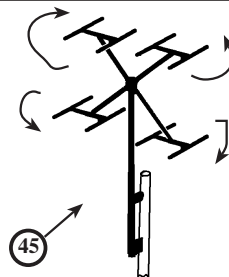

The 291 radar antenna is folded in to shape by bending the outer dipoles so that they face in the direction shown above. This antenna is fitted to the very top of the mast pole.

### MF/DF Antenna

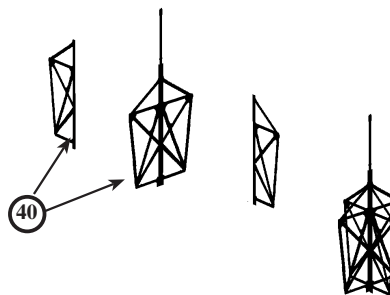

Assemble the MF/DF antenna by folding each of the two halves down the centre line to 90°. Join the halves together by glueing down the centre line and positioning the parts to form a cross when looking from above. This can be assembled whilst attached to the mast pole if desired.

### Tripod Fore Mast Assembly

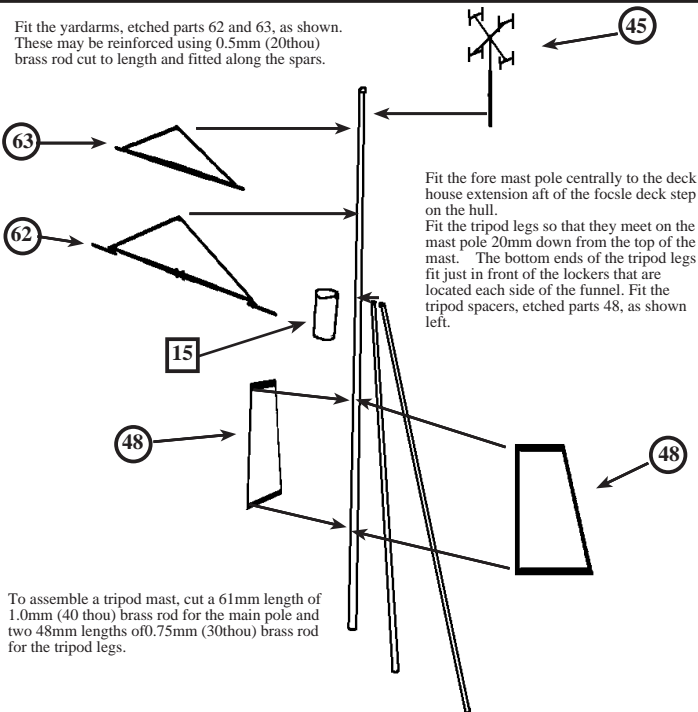

Fit the yardarms, etched parts 62 and 63, as shown. These may be reinforced using 0.5mm (20thou) brass rod cut to length and fitted along the spars.

Fit the fore mast pole centrally to the deck house extension aft of the focsle deck step on the hull. Fit the tripod legs so that they meet on the mast pole 20mm down from the top of the mast. The bottom ends of the tripod legs fit just in front of the lockers that are located each side of the funnel. Fit the tripod spacers, etched parts 48, as shown left.

To assemble a tripod mast, cut a 61mm length of 1.0mm (40 thou) brass rod for the main pole and two 48mm lengths of 0.75mm (30thou) brass rod for the tripod legs.

### Radar Lantern Assembly

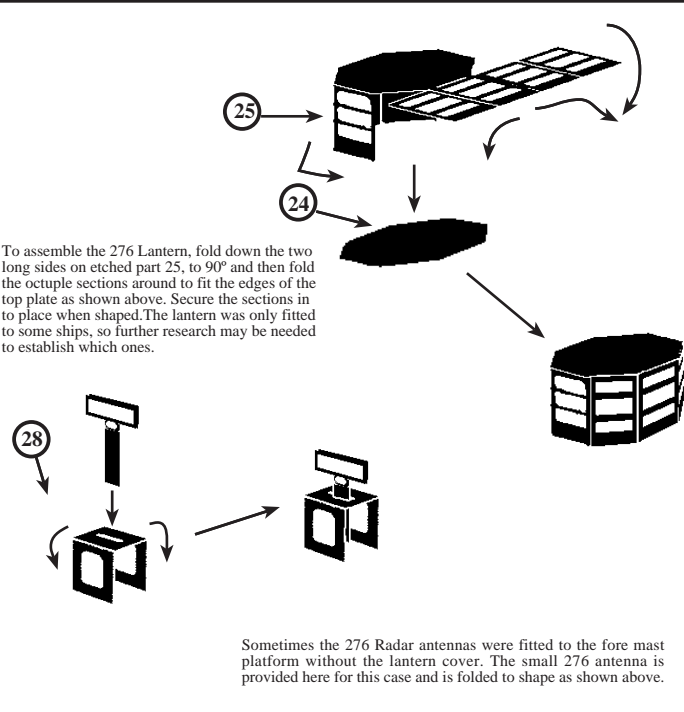

To assemble the 276 Lantern, fold down the two long sides on etched part 25, to 90° and then fold the octuple sections around to fit the edges of the top plate as shown above. Secure the sections in to place when shaped. The lantern was only fitted to some ships, so further research may be needed to establish which ones.

Sometimes the 276 Radar antennas were fitted to the fore mast platform without the lantern cover. The small 276 antenna is provided here for this case and is folded to shape as shown above.

### Wire Antenna Spreader

A small mast or wire antenna spreader was fitted to the forward end of the Hazemeyer platform. To make this, cut a 14mm length of 0.75mm (30 thou) diameter brass rod and fit vertically as shown. Fit the yardarm, etched part 17 as shown. An additional length of 0.5mm (20thou) diameter brass rod cut to the length of the spar may be used as reinforcing.

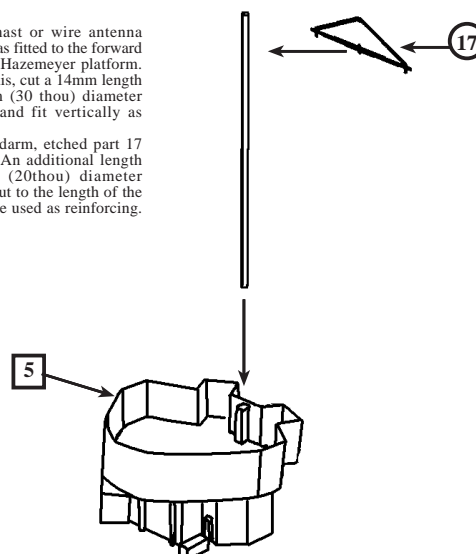

## Lattice Mast Assembly (Scorpion)

Fold the side lattices of etched part 13 around to 90° so that they are parallel, then bring the edges in together and secure in to place. Fit the front lattice in to place between the two front edges and secure in to place.  
 Fold up the railings on the top platform, etched part 17, to 90° and fit the platform to the top of the mast. Fit the yardarms, etched parts 50, to the rear corners on the mast just below the top platform. Cut a top mast pole to the required height, (around 20mm) then fit the details required for the particular ship being modelled. The combination of parts varied from ship to ship, so research the ship being modelled to establish the correct antenna fit.

This radar was fitted to the top platform of the lattice mast. Assemble by foldin the half circular plates back to 90° from the front plate. Cut a small length of plastic rod or stretched sprue and use as a spindle to fit the antenna to its base as shown above.

Make a top pole mast from .75mm (30thou) plastic or brass rod cut to the length of 20mm.

Fit the lattice mast to the top of the galley house as shown here. The yardarms may be reinforced with 20thou (0.5mm) brass rod if desired.

## Late Main Mast Variants

HMS Scorpion as fitted had a small lattice main mast that supported the HF/DF antenna, etched part 21. Other ships of the class had either this type of mast or a pole mast, shown below, which was used by Scorpion at a later date.

Shape the lattice mast, etched aprt 21, by folding each section to 90° then bring the edges together and secure into place. The HF/DF antenna or the 291 antenna could be fitted to the top of this mast.

If the late war version is being modelled with the lattice fore mast, the 291 radar antenna was moved aft and fitted on top of a main mast pole. To make this pole cut a 34mm length of 0.1mm (40 thou) diameter brass rod and fit vertically from the forward end of the aft superstructure. Fit the 291 antenna as shown right along with a length of stock vertical ladder fitted to the side of the pole. Alternatively the HF/DF antenna could have been fitted on top of the pole mast instead.

## Funnel Fittings

Fit Funnel Cap grill 57 as shown.

Fold the handrails on the small platforms, etched parts 72 around so that they are parallel, with the square platform horizontal in between. A section of vertical ladder may also be fitted from the main deck to the platform.

Fit Siren bracket 35 to side of funnel above the platform.

## Boat Davit Assembly

Fold the davits, etched parts 31 in half so that the relief etched detail is outermost. Fix the halves together with adhesive.

## Ships Boats Assembly

To fit the thwarts in to the whaler, first remove any remaining molded detail present inside the boat. Fit the thwarts as shown then fit the rudder to the stern of the boat. It will be easier to fit the boats to the davits if the davits are first fitted in to position on the main deck and secured in to place.

## Ships Boats Location

Fit davits, etched parts 31, in to position on the main deck and secure in to place. Test fit the boats and note the position of where the falls will pass. Drill small holes through the boats at these positions and then pass the falls through the holes until the boats are snugly in position against the davits. Secure in to place.

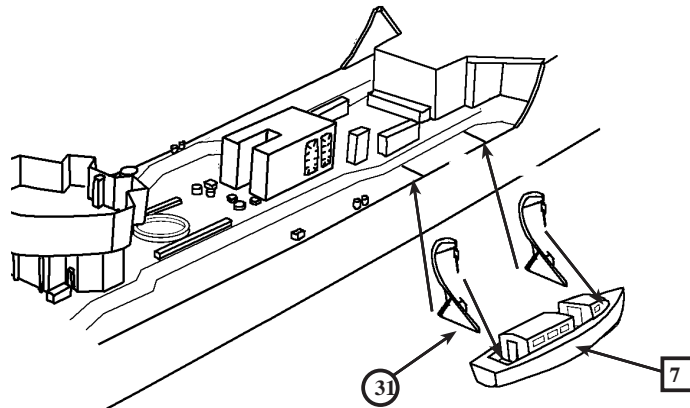
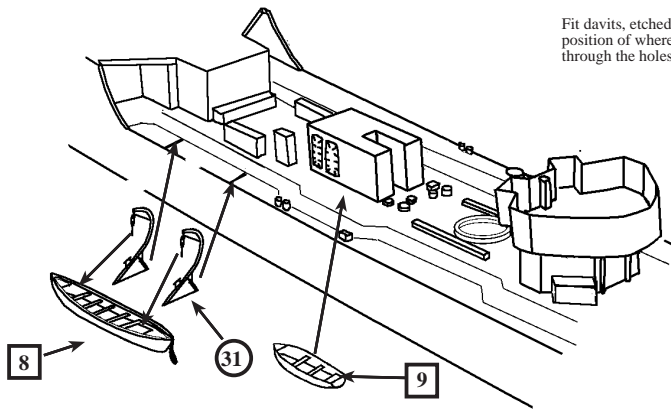

### Depth Charge Thrower Assembly

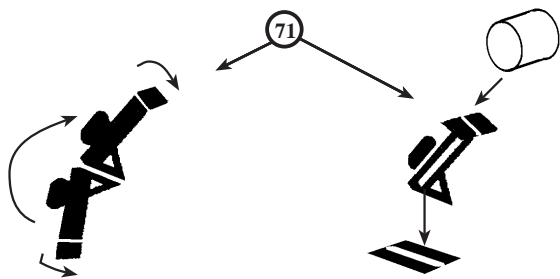

To assemble etched parts 71, fold the main body of the thrower gun in half, so that it is double thickness. Fold top plates outwards to 90° so that the depth charge can be located easily. Fit the base of the gun body to the footplate as shown above right. Make depth charges by cutting short lengths of 1.5mm (60thou) diameter plastic rod and fitting to the tops of the throwers. These may be used instead of the metal parts 23 if desired.

### Depth Charge Stowages

Fold the depth charge stowage frames to shapes shown below. Depth charges to fit in to these stowages can be cut from 1.5mm (60 thou) diameter plastic rod. Or use some of the stock depth charges supplied with parts 22.

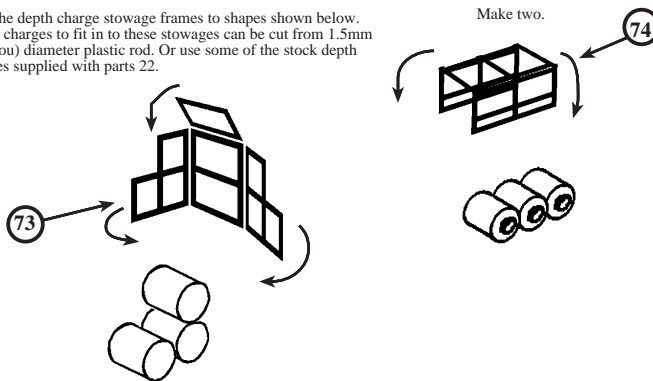

Make four.

### Depth Charge Stern Rails

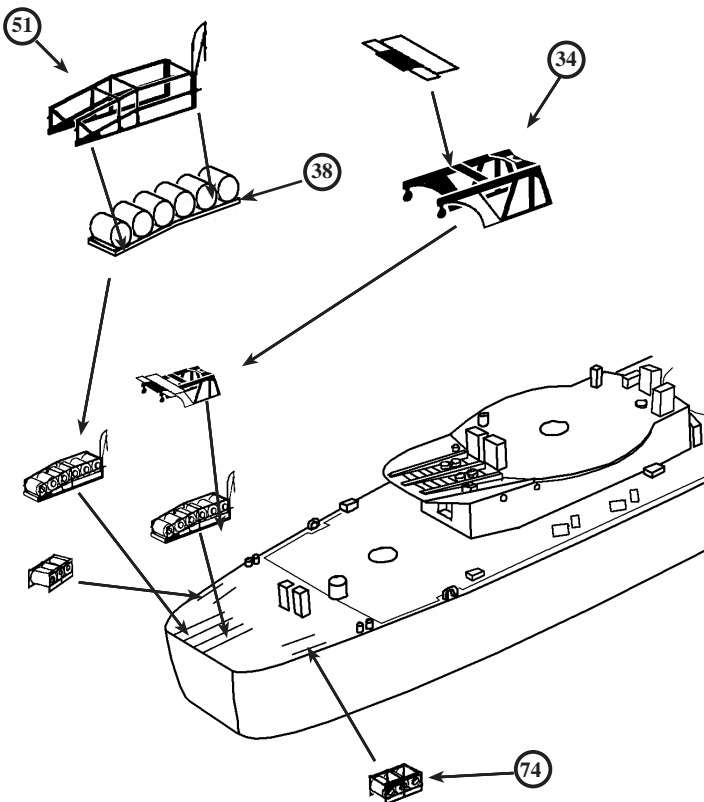

Assemble the depth charge rails, etched parts 51, by folding down the sides so that they are parallel. Fit in two lengths of depth charges supplied in the kit parts 22, to the rails as shown above. Fit the depth charge rails in to position on the stern so that one set of rails is central. The second set of rails is set to port. Fold the TSDS gantry, etched part 34, to the shape shown, then fit the top plate in to position. Fit the TSDS frame to the stern so that it straddles the centrally positioned depth charge rails. Fit the small depth charge stowage racks, etched parts 74, to each side of the quarterdeck.

### Depth Charge Thrower Locations

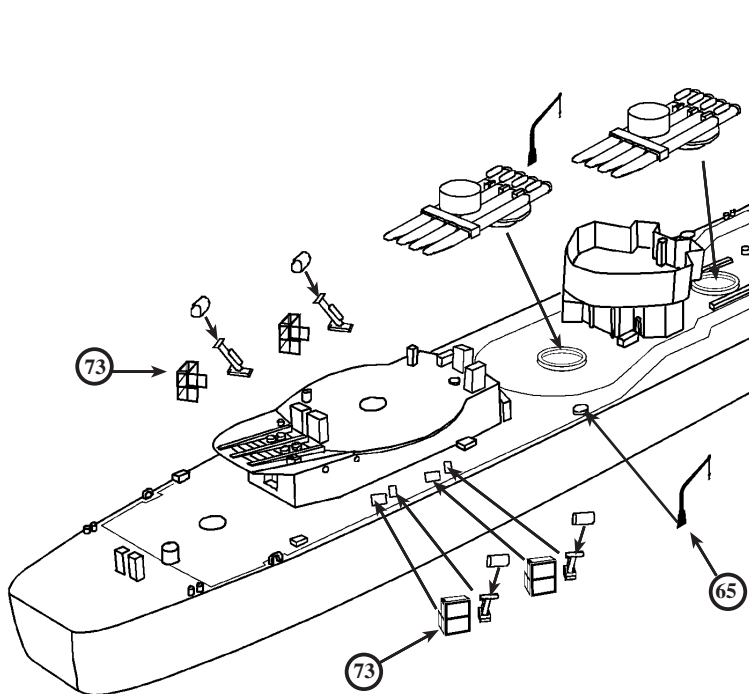

Fit the depth charge thrower assemblies to the positions shown on the main deck, abreast of the aft superstructure. Locate and secure the depth charge stowage racks, etched parts 73, to the positions shown on the deck beside the depth charge throwers. Fit the bases of the torpedo loading davits to the raised positions on the main deck adjacent to the torpedo tube positions. Fit the torpedo tubes supplied in the kit in to the positions shown above on the main deck.

## Fo'c'sle Fittings

Assemble the anchors, etched parts 33, by slotting the base through the rectangular hole in the tipping plate. Fit the anchors in to the holes on each side of the bow. These may require to be drilled out further to take the shaft of the anchor.

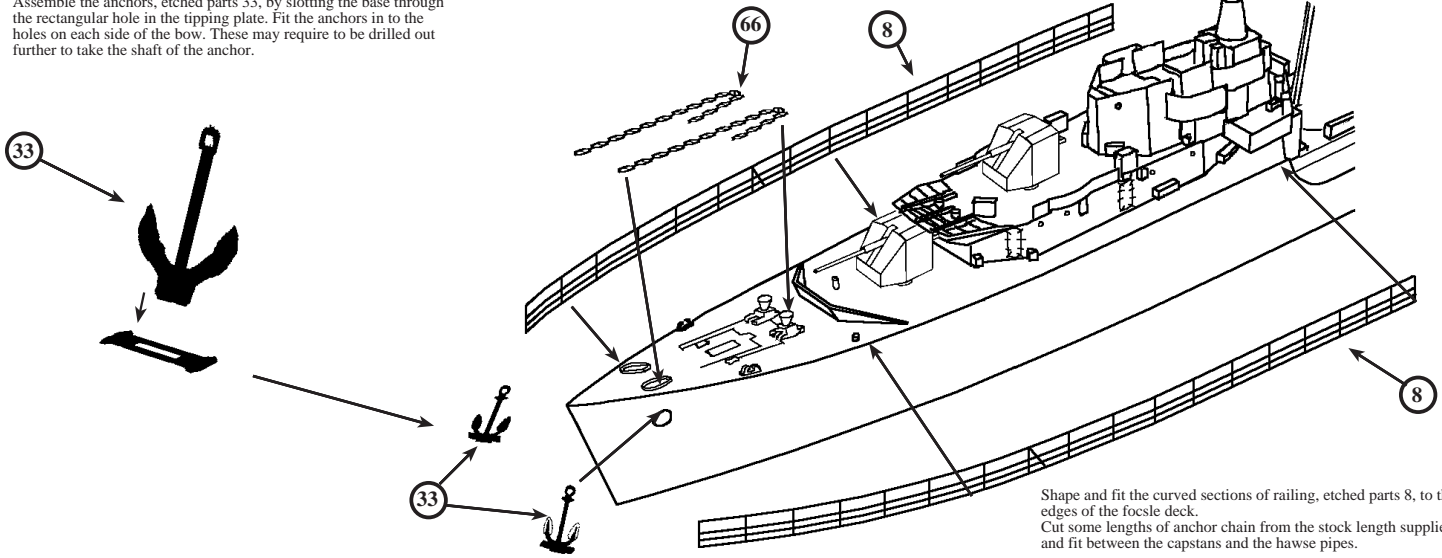

Shape and fit the curved sections of railing, etched parts 8, to the edges of the foecle deck.  
Cut some lengths of anchor chain from the stock length supplied and fit between the capstans and the hawse pipes.

## Torpedo Deck Catwalks

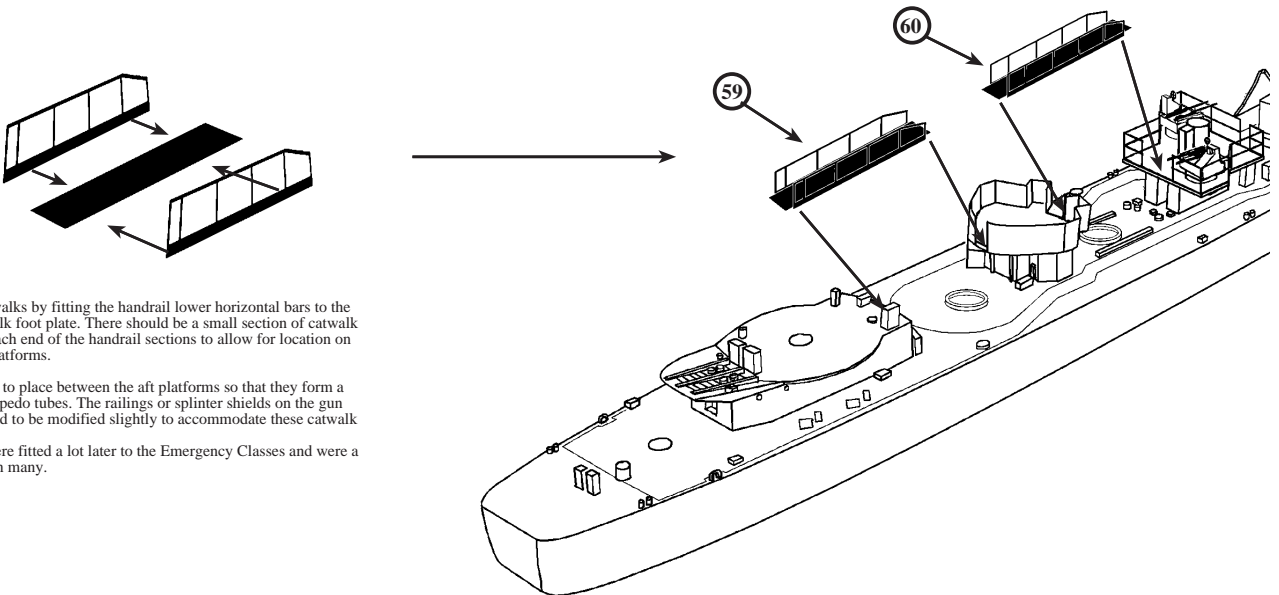

Assemble the catwalks by fitting the handrail lower horizontal bars to the edges of the catwalk foot plate. There should be a small section of catwalk protruding from each end of the handrail sections to allow for location on the edges of the platforms.

Fit the catwalks in to place between the aft platforms so that they form a bridge over the torpedo tubes. The railings or splinter shields on the gun platforms may need to be modified slightly to accommodate these catwalk ends.

These catwalks were fitted a lot later to the Emergency Classes and were a post war feature on many.

## Propeller and Rudder Fitting

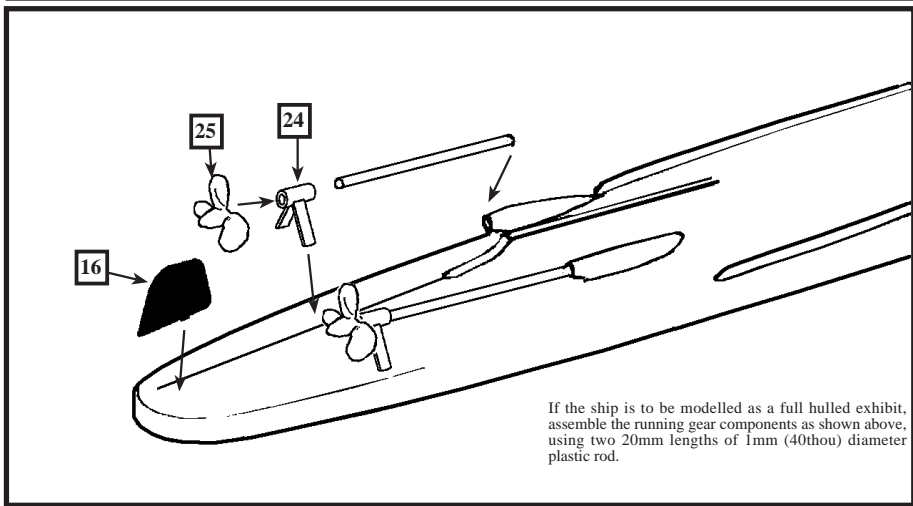

If the ship is to be modelled as a full hulled exhibit, assemble the running gear components as shown above, using two 20mm lengths of 1mm (40thou) diameter plastic rod.



# Colour Chart And Painting Guide

B15  
Colourcoats  
RN 15

B30  
Colourcoats  
RN 21

G45  
Colourcoats  
RN 14

Anti Fouling Red  
Colourcoats  
RN19

STEEL DECKS  
G20  
Colourcoats  
RN 25

CEMTEX  
Humbrol 121  
could be painted  
over in G20

All colours quoted are from the Colourcoats range of authentic colours.

HMS Scorpion 1943  
Admiralty Light Disruptive Type

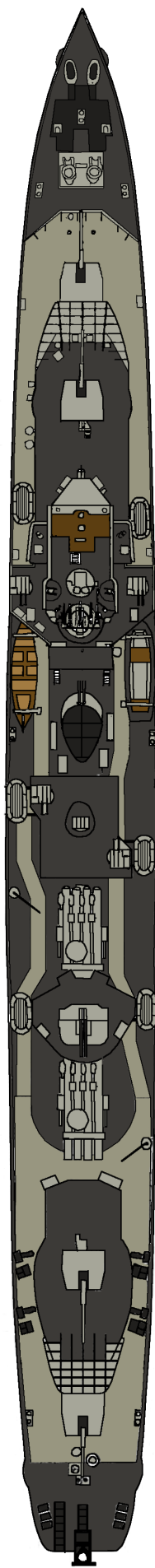
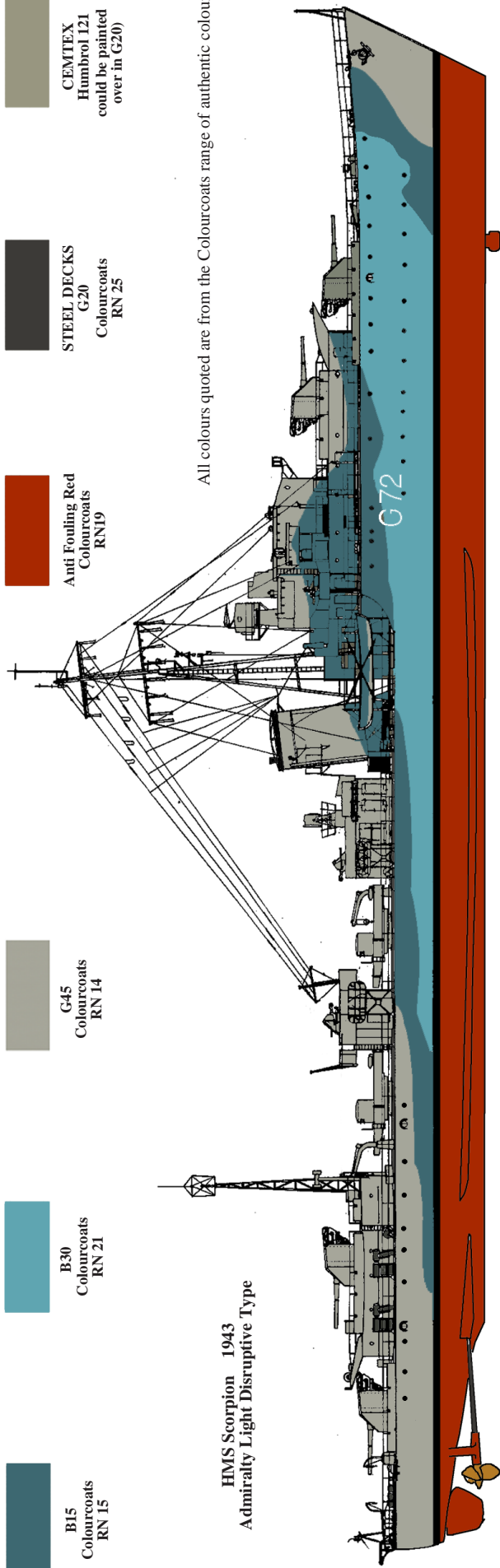

G10  
Colourcoats  
RN 23

B30  
Colourcoats  
RN 21

G45  
Colourcoats  
RN 14

B55 (Late War)  
Colourcoats  
RN 20

HMS Scorpion 1944  
Admiralty Intermediate Disruptive Type Scheme

